



# Ann Watley, Personal Real Estate Corporation

ann@annwatley.com <http://www.annwatley.com>  
 Office: (250) 656-3486 Direct: (250) 656-3486



**Pemberton Holmes Real Estate Ltd**  
 107-2360 Beacon Avenue  
 Sidney, BC V8L 1X3

9624 Barnes Pl

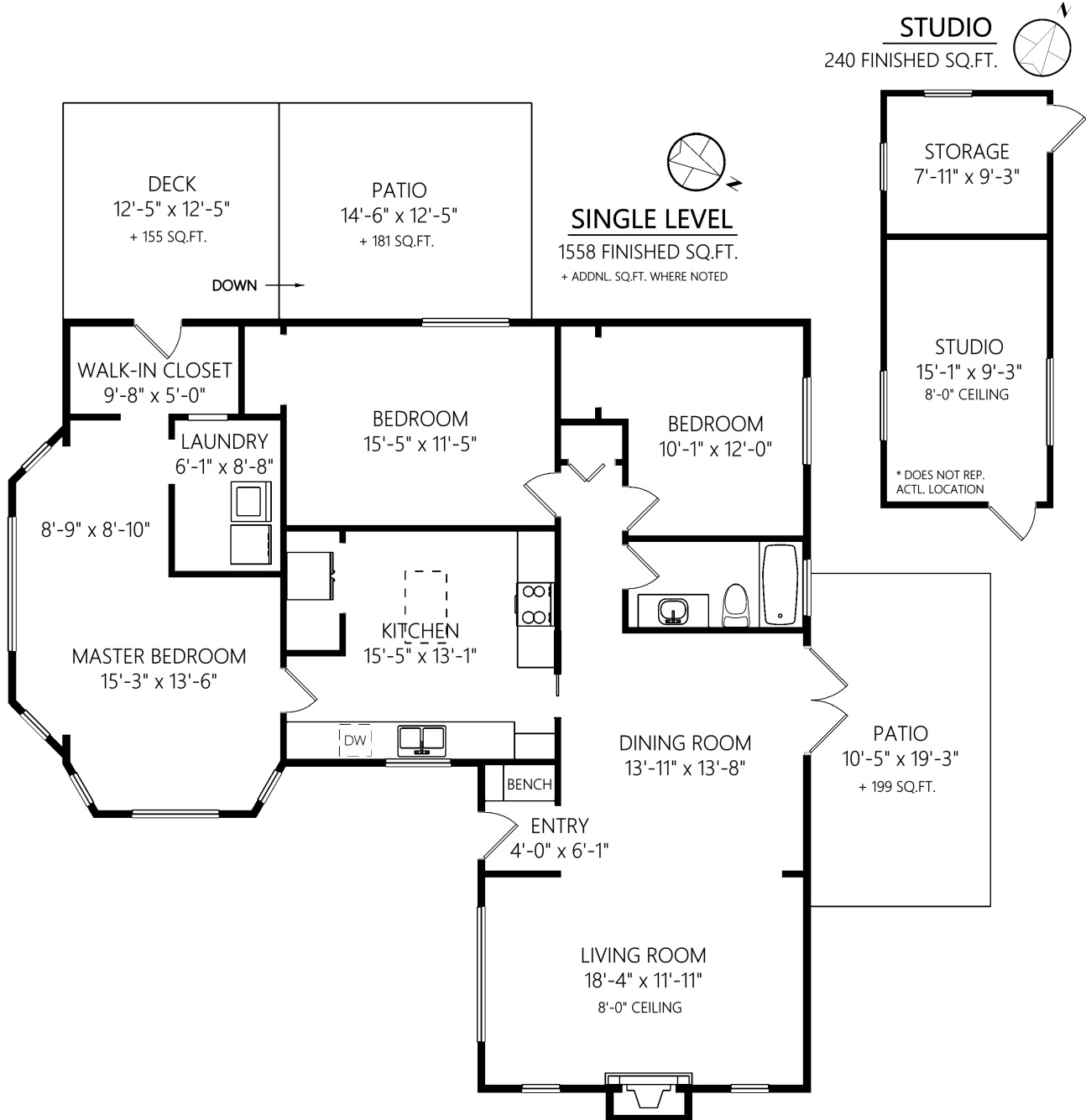

|              | Fin. Sq.Ft. | UnFin. Sq.Ft. | Total Sq.Ft. |
|--------------|-------------|---------------|--------------|
| Single Level | 1558        | 0             | 1558         |
| Studio       | 240         | 0             | 240          |
| <b>Total</b> | <b>1798</b> | <b>0</b>      | <b>1798</b>  |

Shown length and width dimensions are approximate.  
 Area sq.ft. is representative of the on-site measurements. (1" accuracy)



Figures, Calculations, and Representations are for indicative and promotional purpose only.  
 VI Standard Real Estate Services Inc. will not be liable for any damages of any kind arising from the mis-use of this information.