

06.XS.R92.34

SUBDIVISION PLAN OF LOTS 28 TO 31 INCLUSIVE; LOTS 42 TO 59 INCLUSIVE; LOTS 61 TO 66 INCLUSIVE; LOTS 68 TO 72 INCLUSIVE; LOTS 75 TO 77 INCLUSIVE; LOTS 79 TO 85 INCLUSIVE; LOTS 88, 90 AND 91; LOTS 86 AND 87; LOTS 92 TO 117 INCLUSIVE; AMENDED LOTS 60, 67 AND 74 (D.D. 330242-1), LOT 89, INCLUDING THAT PART COLOURED RED ON PLAN 340 R.W. PORTIONS OF LANES DEDICATED BY PLAN 410 AND VESTED BY ORDER IN COUNCIL No. 5786, ALL BEING PART OF DISTRICT LOT 110, COMOX DISTRICT, PLAN 410.

SCALE = 1:1000.



BEARINGS FROM PLAN, RP 233

- OIP - OLD IRON PIN FOUND.
- IP - 1/2" x 1/2" x 50' GALV. IRON BAR SET.
- OP - OLD POST FOUND.

ALL DISTANCES ARE IN METRES.

ALL LANES CLOSED BY GAZETTE NOTICE DECEMBER 15, 1966, AS SHOWN ON PLAN 2486 RS.

2486 RS
2487 RS
2488 RS
2489 RS
2490 RS
2491 RS
2492 RS
2493 RS
2494 RS
2495 RS
2496 RS
2497 RS
2498 RS
2499 RS
2500 RS
2501 RS
2502 RS
2503 RS
2504 RS
2505 RS
2506 RS
2507 RS
2508 RS
2509 RS
2510 RS
2511 RS
2512 RS
2513 RS
2514 RS
2515 RS
2516 RS
2517 RS
2518 RS
2519 RS
2520 RS
2521 RS
2522 RS
2523 RS
2524 RS
2525 RS
2526 RS
2527 RS
2528 RS
2529 RS
2530 RS
2531 RS
2532 RS
2533 RS
2534 RS
2535 RS
2536 RS
2537 RS
2538 RS
2539 RS
2540 RS
2541 RS
2542 RS
2543 RS
2544 RS
2545 RS
2546 RS
2547 RS
2548 RS
2549 RS
2550 RS

PLAN 35133

DEPOSITED IN THE LAND TITLES OFFICE AT VICTORIA, B.C. THIS 26th DAY OF JULY, 1966.

Robert Williams
Professional Deputy Registrar

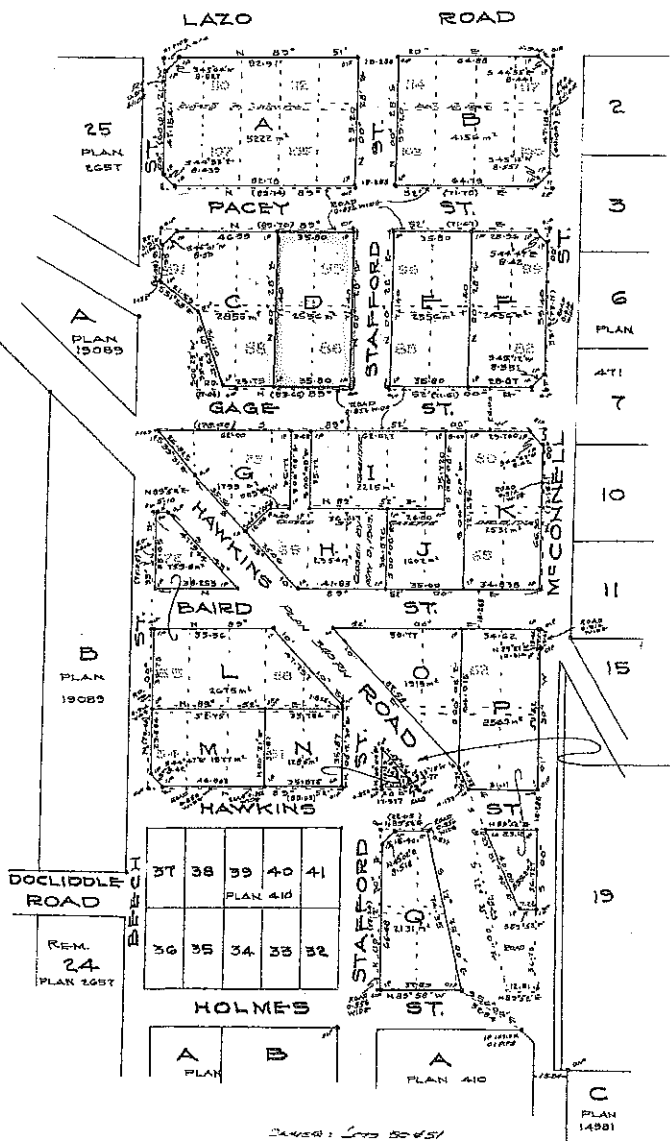

PURCHASER(S) acknowledge(s) that the lot outlined in red is the property I/we have purchased.

[Signature]

DETAIL (NOT TO SCALE)

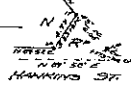

APPROVED UNDER THE LAND TITLES ACT
THIS 26th DAY OF JULY, 1966.
[Signature]
MAYOR, ROSBAND

APPROVED UNDER THE LAND TITLES ACT THIS 26th DAY OF JULY, 1966.

[Signature]
APPROVING OFFICER
MINISTRY OF HIGHWAYS AND PUBLIC WORKS.

CAUSED: LOTS 50 & 51
[Signature]
WITNESSES: *[Signature]*
Occupation: LAND SURVEYOR.
Address: 2500 McLENDON AVE.
COMOX, B.C.

THE SEAL OF BROWN HARRISON LTD.
APPLIED IN THE PRESENCE OF:
[Signature]
Notarized & Forwarded

I, ROBERT WILLIAMS, A BRITISH COLUMBIA LAND SURVEYOR, OF COMOX, IN BRITISH COLUMBIA, CERTIFY THAT I WAS PRESENT AT AND PERSONALLY SUPERINTENDED THE SURVEY REPRESENTED BY THIS PLAN, AND THAT THE SURVEY AND PLAN ARE CORRECT. THE SURVEY WAS COMPLETED ON THE 15th DAY OF APRIL, 1966.
[Signature]
B.C.L.S.

THIS PLAN LIES WITHIN THE REGIONAL DISTRICT OF COMOX-STRATHCONA.

ROBERT WILLIAMS,
B.C. LAND SURVEYOR,
2500 McLENDON AVE.,
COMOX, B.C.
FILE No. 25242-34