

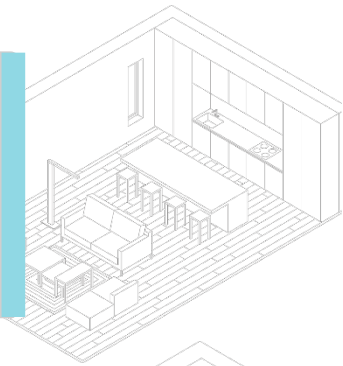

**Address** 9067 Scurfield Drive NW, Calgary, AB  
**Date** August 28, 2020  
**Name** Ken Rigel | Real Estate Professionals Inc.  
**Email** ken@krgroup.ca  
**Phone** 403.835.6338

### FLOOR TOTALS

Main Level	1097.33 sqft / 101.94 m2	Total RMS Size	1941.25 sqft / 180.34 m2
Upper Level	843.92 sqft / 78.40 m2	Total w/basement	3028.46 sqft / 281.34 m2
Basement Total	1087.21 sqft / 101.00 m2	Order Procedure	RECA RMS
*Finished Total	996.96 sqft / 92.62 m2	Exterior Wall Size	2 X 6
		Order Type	Detached Single Family



### ROOM DIMENSIONS

Kitchen	12'6" X 9'6" ft/in	M	Laundry	6'0" X 3'0" ft/in	M
Dining Area	12'8" X 10'6" ft/in	M	Storage Room	9'0" X 5'10" ft/in	B
Office Nook	7'10" X 7'10" ft/in	B	Utility Room	8'10" X 5'6" ft/in	B
Living Room	13'4" X 11'6" ft/in	M	Wet Bar	0'0" X 0'0" ft/in	NA
Family Room	15'0" X 14'6" ft/in	M	Deck	14'0" X 13'6" ft/in	M
Foyer	9'4" X 5'0" ft/in	M	Patio	21'8" X 17'4" ft/in	B
Lower Family	16'10" X 15'0" ft/in	B	Porch	0'0" X 0'0" ft/in	NA
Rec Area	15'2" X 10'10" ft/in	B	Garage	20'6" X 18'6" ft/in	M

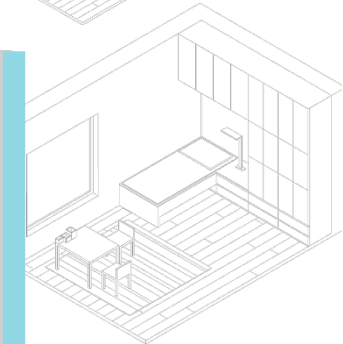

### BEDROOM DIMENSIONS

Master	13'4" X 13'4" ft/in	U	Bedroom Four	13'0" X 10'4" ft/in	B
Bedroom Two	13'0" X 11'0" ft/in	U	Bedroom Five	0'0" X 0'0" ft/in	NA
Bedroom Three	11'6" X 9'10" ft/in	U	Bedroom Six	0'0" X 0'0" ft/in	NA

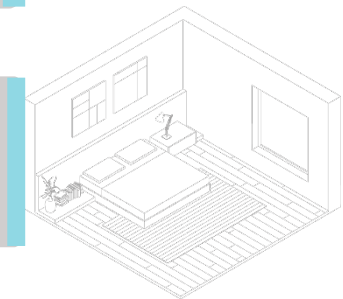

### BATHROOM PIECES

1 - Two Piece	M
0 - Three Piece	NA
2 - Four Piece (1-Ensuite)	U
1 - Five Piece	B

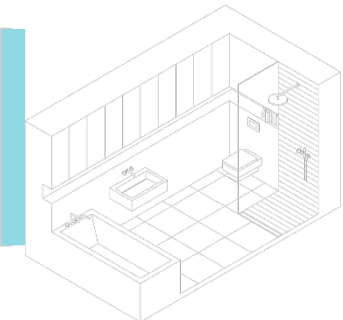

\*Insured measurements are based on local guidelines.