

LOWER FLOOR

653 SQ. FT.

9' CEILING HEIGHT

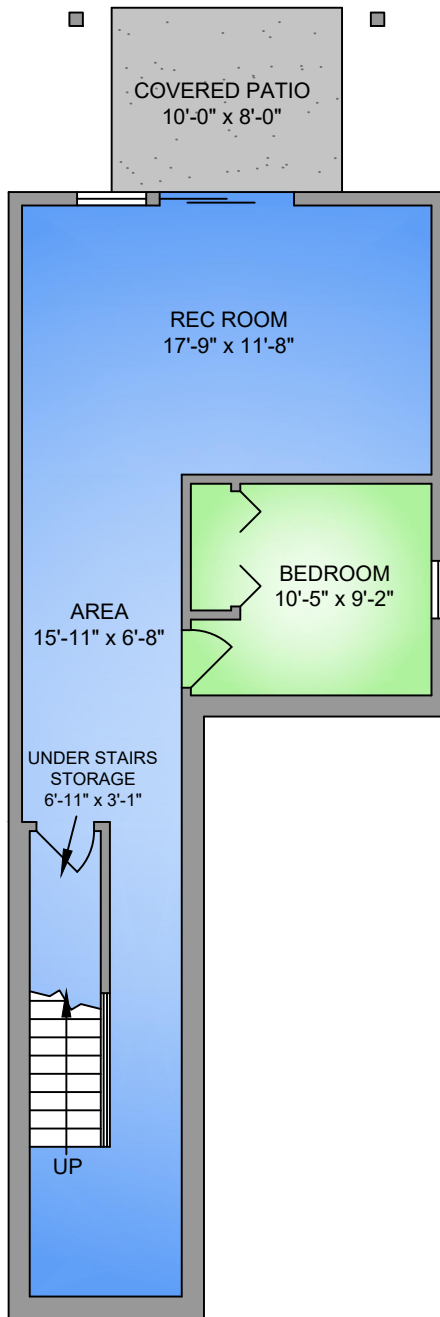

MAIN FLOOR

653 SQ. FT.

9' CEILING HEIGHT

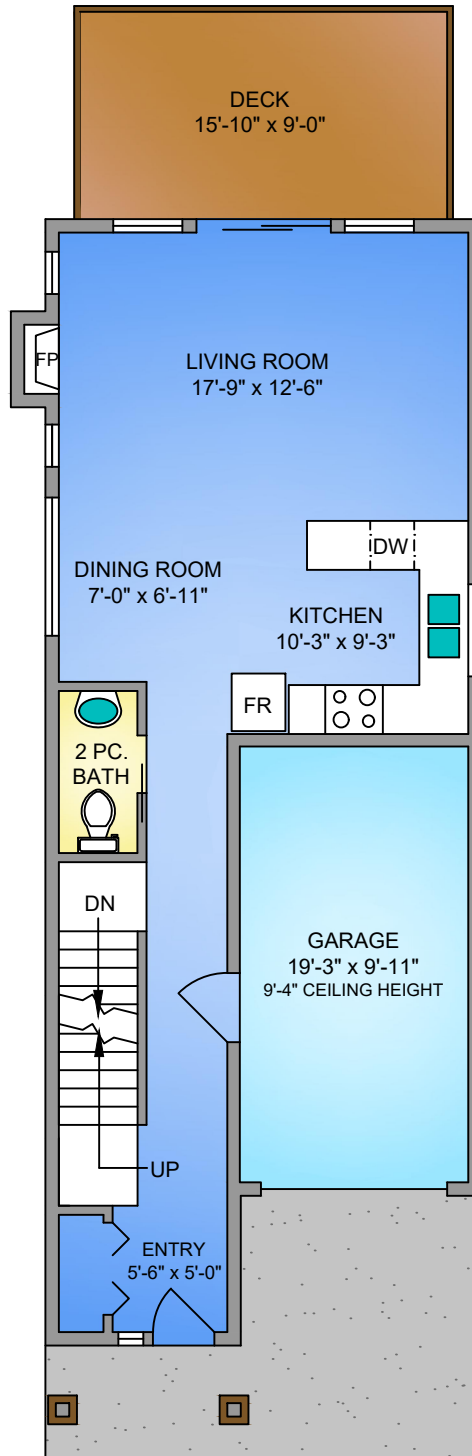

UPPER FLOOR

806 SQ. FT.

8' CEILING HEIGHT

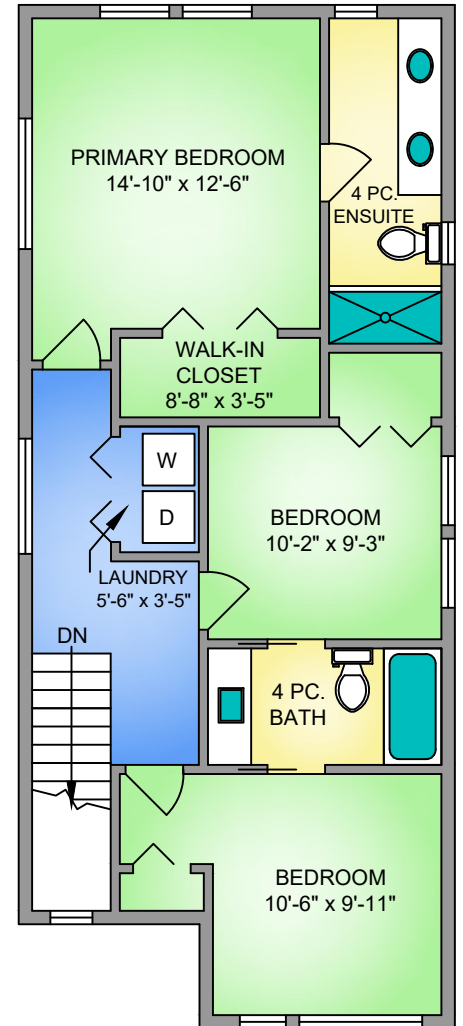

NORTH

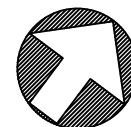

SCALE



THE
PREFERRED HOMES TEAM
www.PreferredHomes.ca **RE/MAX** CAMOSUN



250-884-9753
matt@propermeasure.com
www.propermeasure.com



Limona Homes at Walfred

3485 MYLES MANSELL ROAD			
NOVEMBER 25, 2020			
PREPARED FOR THE EXCLUSIVE USE OF THE PREFERRED HOMES TEAM			
PLANS MAY NOT BE 100% ACCURATE, IF CRITICAL BUYER TO VERIFY.			
FLOOR	AREA (SQ. FT.)		
	FINISHED	GARAGE	DECK / PATIO
LOWER	653	-	-
MAIN	653	205	143
UPPER	806	-	80
TOTAL	2112	205	223