

**PLAN SHOWING THE LOCATION OF IMPROVEMENTS SITUATED UPON  
LOT 50, SECTION 20, TOWNSHIP 16, PLAN 20178,  
NEW WESTMINSTER DISTRICT.**

SCALE 1: 225 (METRIC)

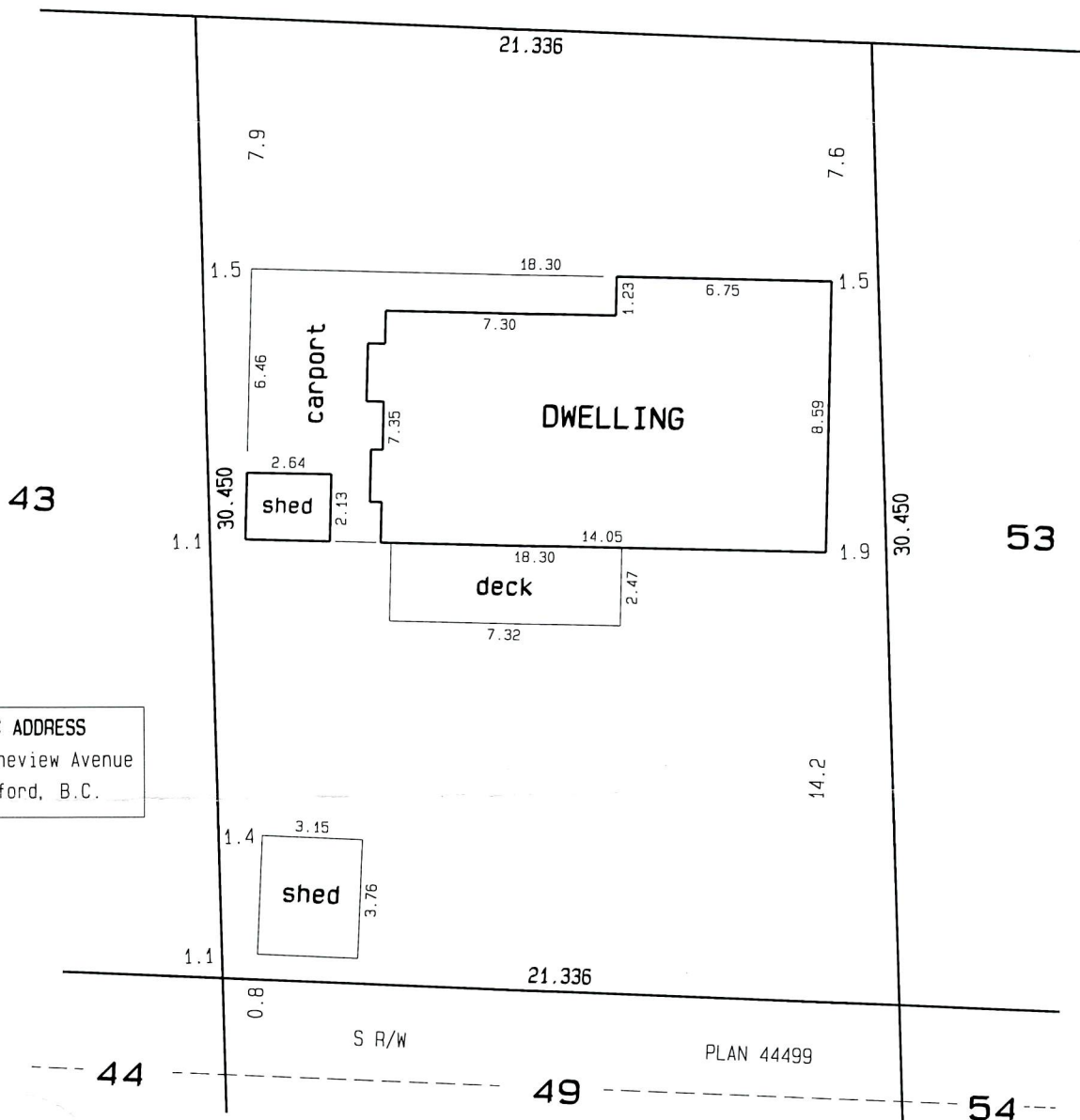

**PINEVIEW AVENUE**



**CIVIC ADDRESS**  
#32232 Pineview Avenue  
Abbotsford, B.C.

*CERTIFIED CORRECT AS TO LOCATION  
AND DIMENSION OF IMPROVEMENTS*

*D. Prokopetz, ASCT, RSIS*

DATED THIS 6th DAY OF MAY, 2010.

NOTE: The location of features certified by this plan has been determined from existing survey monumentation and does not purport to be a location certified in relation to a boundary of land. We accept no responsibility for the unauthorized use or for any use of a copy not bearing an original embossed seal. Property line dimensions are according to Land Title Office records. This plan is not to be used for the re-establishment of property lines. This plan is to be used for mortgage purposes only.

**Westcoast Surveys Ltd.**

16264 80th Avenue  
Surrey, B.C. V4N 0X3  
tel 604-543-8665 fax 604-543-8610  
faxdon@gmail.com  
Our File: 5-20-10  
Your File: Mitterer