

MAIN FLOOR 1922 SQ. FT.

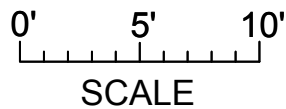

NORTH



7300 WESTHOLME ROAD JANUARY 30, 2019 <small>PREPARED FOR THE EXCLUSIVE USE OF LAURA LEPPARD PLANS MAY NOT BE 100% ACCURATE, IF CRITICAL BUYER TO VERIFY.</small>				
FLOOR	AREA (SQ. FT.)			
	FINISHED	GARAGE/SHOP	DECK / PATIO	SHEDS
MAIN	1922	-	569	-
OUTBUILDING	-	946	-	292
TOTAL	1922	946	569	292

WOOD / GARDEN SHED
292 SQ. FT.

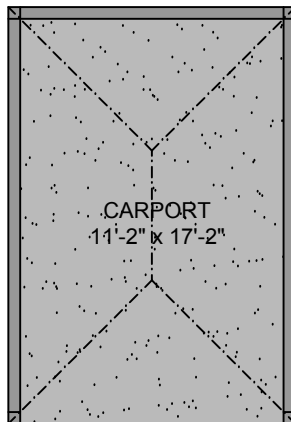
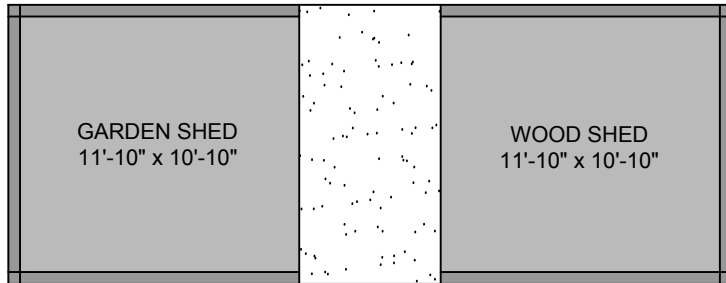

CARPORT
215 SQ. FT.

TRIPLE GARAGE / SHOP
946 SQ. FT.

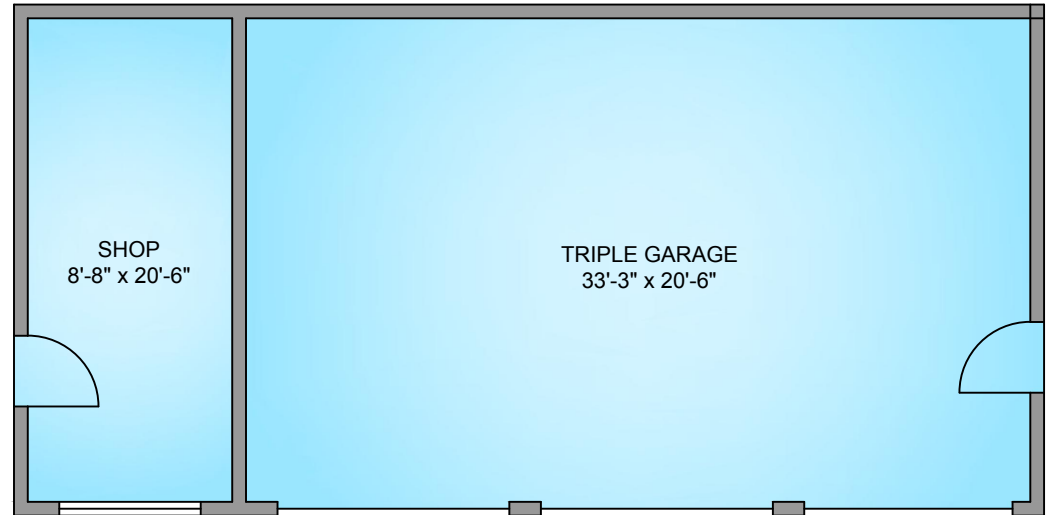

NORTH

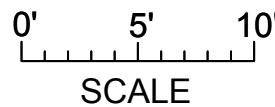

7300 WESTHOLME ROAD JANUARY 30, 2019 PREPARED FOR THE EXCLUSIVE USE OF LAURA LEPPARD PLANS MAY NOT BE 100% ACCURATE, IF CRITICAL BUYER TO VERIFY.				
FLOOR	AREA (SQ. FT.)			
	FINISHED	GARAGE/SHOP	DECK / PATIO	SHEDS
MAIN	1922	-	569	-
OUTBUILDING	-	946	-	292
TOTAL	1922	946	569	292