

#102 1519 Grant Avenue,
Port Coquitlam, BC



SIMON LU

Sutton Group West Coast - Coquitlam
Cell: 778-688-6838
Office: 604-415-9800
slu@sutton.com
www.HappyHomesVancouver.com



SAYAKA TAKAHARA

Sutton Group West Coast - Coquitlam
Cell: 604-725-7228
Office: 604-415-9800
stakahara@sutton.com
www.VancouverHomeNavi.com

TOTAL FINISHED AREA: 665 SQ.FT.

OTHER AREA(S)

PATIO: 109 SQ.FT.*

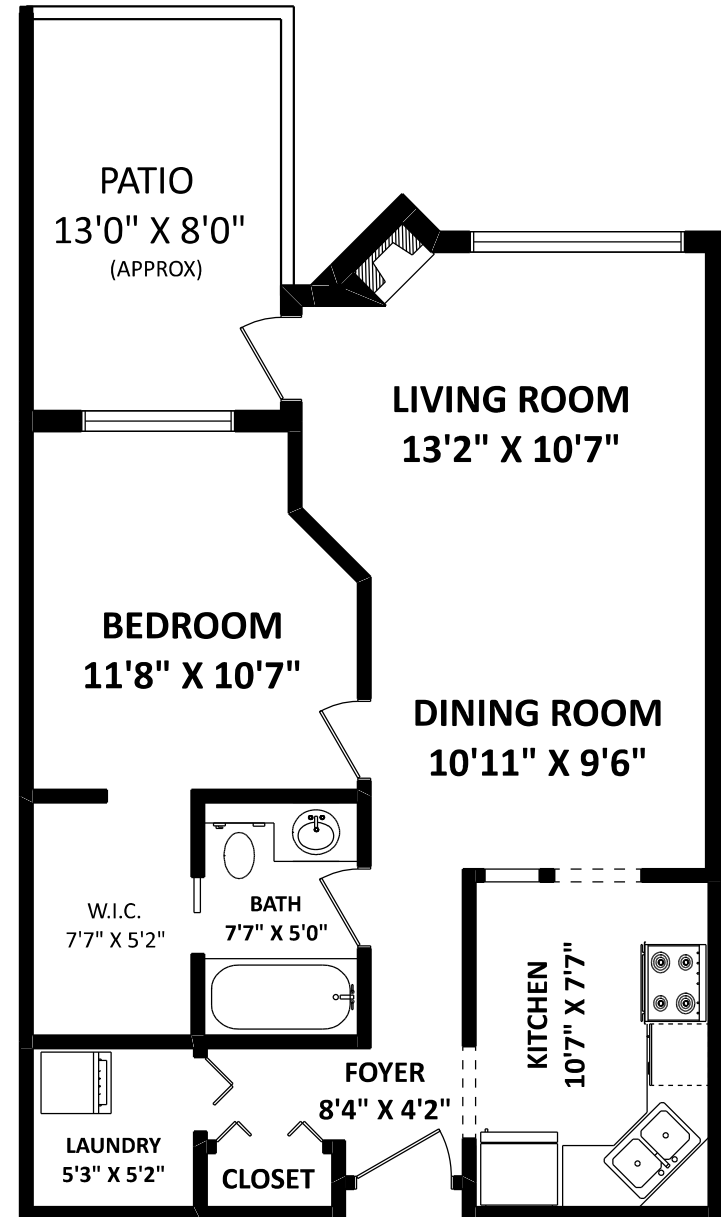

FLOOR PLAN BY:

[AUGUST 27, 2018]



TEL: 604-575-1244
www.seevirtual360.com

DISCLAIMER:

1. MEASUREMENTS ARE FOR PROMOTIONAL USE ONLY & ARE NOT INTENDED FOR CONSTRUCTION USE. ROOM DIMENSIONS ARE APPROXIMATE. MEASUREMENTS & CALCULATIONS FOR FINISHED AREAS ARE E&O INSURED.
 2. FINISHED AREAS ARE ENCLOSED AREAS IN A HOUSE THAT ARE SUITABLE FOR YEAR-ROUND USE, EMBODYING WALLS, FLOORS, AND CEILINGS THAT ARE SIMILAR TO THE REST OF THE HOUSE. (ANSI Z765-2013)
 3. THIS FLOOR PLAN MAY ONLY BE REPRODUCED WITH PERMISSION OF THE REALTOR(S) ON THIS FLOOR PLAN.
- * ANY MEASUREMENT WITH AN ASTERISK (*) OR (APPROX) ARE APPROXIMATE AND FOR ILLUSTRATION PURPOSES ONLY AND ARE NOT E&O INSURED.

