

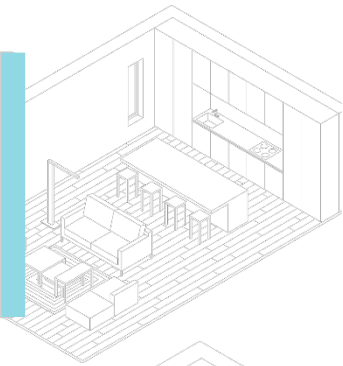

Address 139 Wildwood Drive SW, Calgary, AB
Date March 3, 2020
Name Ken Rigel | Real Estate Professionals Inc.
Email ken@krgroup.ca
Phone 403.207.1748

FLOOR TOTALS

Main Level	1232.09 sqft / 114.46 m2	Total Size	1232.09 sqft / 114.46 m2
Basement Total	1232.09 sqft / 114.46 m2	Total w/basement	2464.18 sqft / 228.92 m2
*Finished Total	1162.41 sqft / 107.99 m2	Order Procedure	RECA RMS
Additions	000.00 sqft / 00.00 m2	Exterior Wall Size	2 X 4
		Order Type	Detached Single Family



ROOM DIMENSIONS

Kitchen	16'4" X 12'6" ft/in	M	Laundry	7'8" X 5'6" ft/in	B
Dining Area	11'6" X 8'6" ft/in	M	Garage (ext.)	28'2" X 28'2" ft/in	M
Office Nook	8'2" X 6'10" ft/in	B	Utility Room	9'8" X 7'2" ft/in	B
Living Room	16'6" X 13'0" ft/in	M	Mud Area	8'8" X 4'4" ft/in	M
Family Room	13'8" X 12'2" ft/in	B	Deck	9'10" X 5'6" ft/in	M
Foyer	10'0" X 4'8" ft/in	M	Porch	26'8" X 8'4" ft/in	M
Rec Area	12'4" X 10'0" ft/in	NA	Patio	24'0" X 11'6" ft/in	M

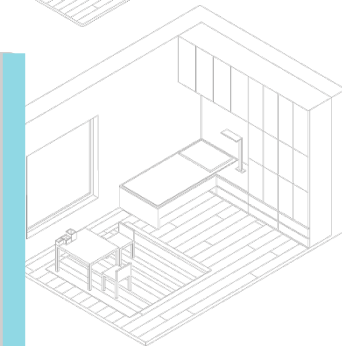

BEDROOM DIMENSIONS

Master	13'0" X 12'0" ft/in	M	Bedroom Four	0'0" X 0'0" ft/in	NA
Bedroom Two	12'4" X 10'8" ft/in	B	Bedroom Five	0'0" X 0'0" ft/in	NA
Bedroom Three	12'4" X 10'4" ft/in	B	Bedroom Six	0'0" X 0'0" ft/in	NA

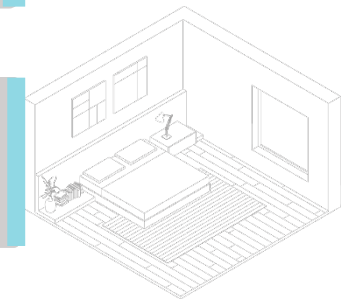

BATHROOM PIECES AND ADDITIONAL ROOMS

1 - Two Piece	M	Additional	0'0" X 0'0" ft/in	NA
0 - Three Piece	NA			
1 - Four Piece	B			
1 - Five Piece (Ensuite)	M			

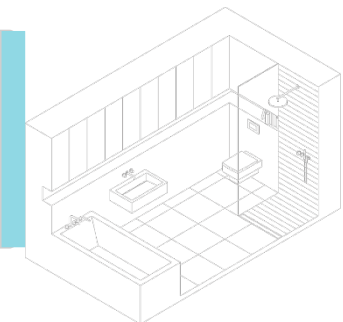

*Insured measurements are based on local guidelines.