

# 368 DOUGLAS ST.

**1248 SQ. FT.**

**8' CEILINGS**

(+275 SQ.FT. GARAGE)



NORTH

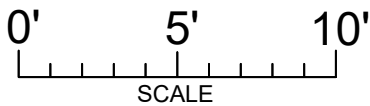

SCALE

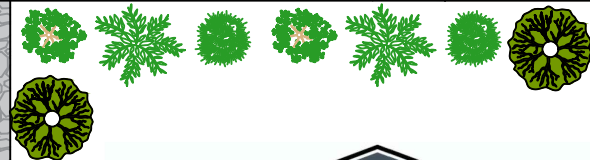

368 DOUGLAS ST. May 25, 2021			
Prepared by PROPER MEASURE NORTH ISLAND for the exclusive use of COURTNEY & ANGLIN REAL ESTATE GROUP Plans may not be 100% accurate. Buyer must verify any critical measurement. Private resale or modification of floor plans to a third party by any individual or entity other than Proper Measure North Island is strictly prohibited			
FLOOR	AREA (SQ. FT.)		
	FINISHED SQ.FT.	DECK	GARAGE
MAIN	1248	148	275
TOTAL	1248	148	275