

UNIT 103 - 1155 YATES STREET

614 SQ. FT.

8' CEILING HEIGHT

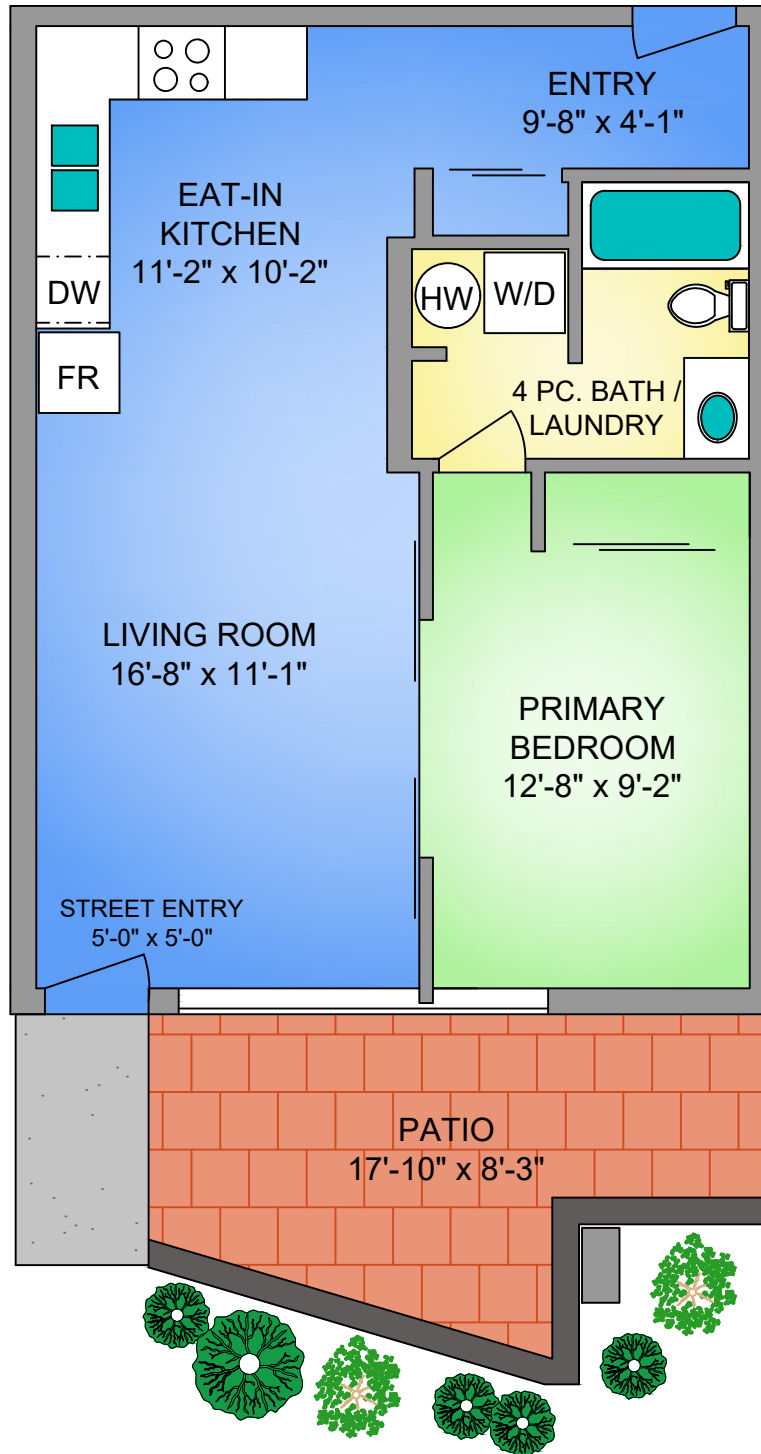

NORTH

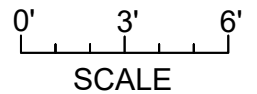
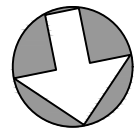

THE PREFERRED HOMES TEAM
 www.PreferredHomes.ca **RE/MAX**CAMOSUN



250-884-9753
 matt@propermeasure.com
 www.propermeasure.com

UNIT 103 - 1155 YATES STREET		
APRIL 27, 2021		
PREPARED FOR THE EXCLUSIVE USE OF THE PREFERRED HOMES TEAM PLANS MAY NOT BE 100% ACCURATE, IF CRITICAL BUYER TO VERIFY.		
FLOOR	AREA (SQ. FT.)	
	FINISHED	PATIO
FIRST	614	129