

# MAIN FLOOR

476 SQ. FT.

8'-0" CEILING

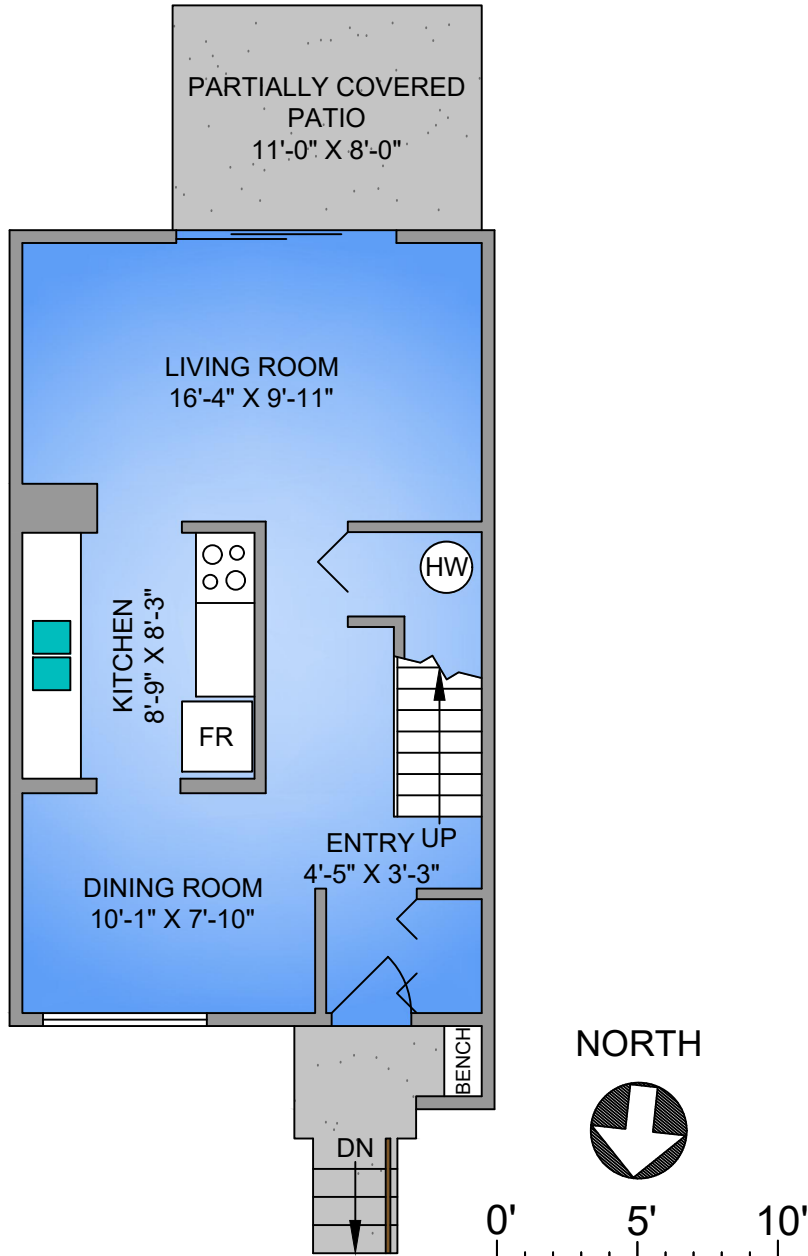

# UPPER FLOOR

577 SQ. FT.

8'-0" CEILING

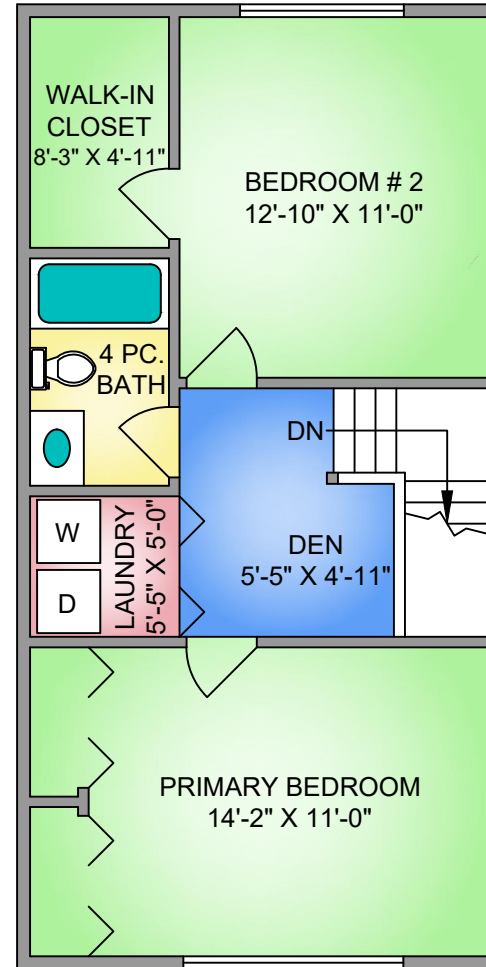

20-855 HOWARD AVENUE

OCTOBER 18, 2021

Prepared by PROPER MEASURE MID ISLAND for the exclusive use of DARREN YOUNG

Plans may not be 100% accurate. Buyer must verify any critical measurement.

Private resale or modification of floor plans to a third party by any individual or entity other than Proper Measure Mid Island is strictly prohibited

FLOOR	AREA (SQ. FT.)	
	FINISHED	DECK / PATIO
MAIN	476	88
UPPER	577	-
TOTAL	1053	88