

## 2-WAY REMOTE UPGRADE INSTALLATION GUIDE

**COMPATIBLE WITH CRIMESTOPPER / PROSTART  
RS, PS, LC, DS MODEL REMOTE STARTERS**

- The Crimestopper 2-WAY remote upgrade kit will add (1) 5-button 2-WAY LCD FM rechargeable remote transmitter with up to 3000 feet range, and (1) 5-button 1-WAY "sidekick" FM remote transmitter with up to 1500 feet range to an existing compatible MPC Crimestopper remote start system. This can be used to upgrade an existing "add-on" system that works using the vehicles OEM remotes, or a 1-WAY AM remote system. This can also be used or for replacements for an existing 2-WAY remote system.
- Kit includes 2-way FM antenna mast, antenna wire, & mini USB charger.
- The Crimestopper system can learn up to 4 different transmitter codes.

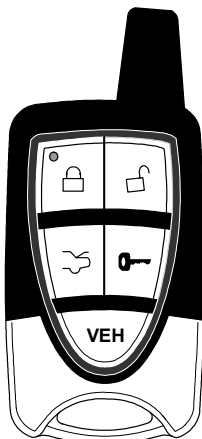

# STEP 1: Select the remote starters antenna system

## **1-WAY AM or 2-WAY FM ANTENNA SYSTEM:**

By default, most Crimestopper / ProStart units are set to 1-WAY. 2-Way systems such as the RS7, PS7, LC7, and DS7 are set to 2-WAY by default. The setting on the remote start system you have **MUST** match the antenna that you have plugged into it. The Crimestopper / ProStart remote start unit will have an option in its programming menu that will allow you to select 1-Way or 2-Way antenna system. The 1-Way system uses AM and 2-Way system uses FM. If you are upgrading an add-on system that does not currently use Crimestopper / ProStart remotes or 1-button unit, then you must select this option using the brake pedal. For all other units, this can also be done using the remote control that is currently programmed to the unit, before changing the antenna. If you accidentally change the antenna system option from 1-Way to 2-Way (or vice versa), and do not change the antenna to match, the system will stop working. The system will not go into Transmitter Learn Mode with wrong antenna plugged in. You need to use the brake pedal to change the antenna system option back to the matching antenna system. For Crimestopper RS units, and Prostart PS units, option #28 will select the antenna system. This guide will only show how to set this option on RS and PS units. For all other units, refer to the installation instructions booklet that comes with the unit, for detailed programming instructions.

*\* Note that the 1-Way and 2-Way antenna look the similar. The 2-Way FM antenna can be identified by the FCC # on the side, and has a black 3-pin port. The 1-Way AM antenna does not have a FCC #, and has a white 3-pin port.*

### **RS0, RS1, RS3, RS4, RS7 OPTION #28 2-WAY programming procedure**

1. Turn Ignition Key to the ON position. (Do not start vehicle).
2. Press Program/Valet button 5 times. Wait for the unit to flash the parking lights and/or honk horn and/or unit click exactly 5 times.
3. Press Program/Valet button again, another 28 times. You must get a light flash and/or honk and/or click after each button press. If the system did not flash the lights and/or honk and/or unit click, then it did not register your press. Press carefully and do not lose count.
4. Press the Lock button of your currently programmed transmitter, or press your brake pedal 1 time and release. You should get 1 light flash/honk/click confirming that option 28 has been changed to its "2-WAY (FM ONLY)" setting.

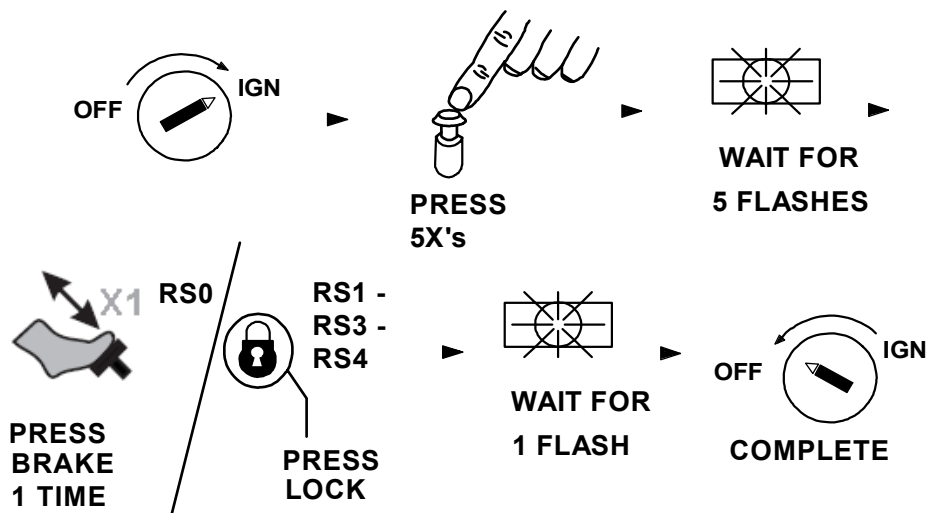

## STEP 2: Install the 2-WAY antenna

- 1) Plug the white male 3-pin plug of the antenna wire into the 3-pin female port of the antenna mast. Tuck the wire into your headliner, and route the wire from the interior windshield mount location of choice, down the drivers side windshield pillar, and to the under dash area or where the remote start unit is located, and plug the black male 3-pin plug of the antenna wire into the matching black female 3-pin antenna port of the remote starter.

Antenna should be located at top of widow at least one inch away from metal surface.

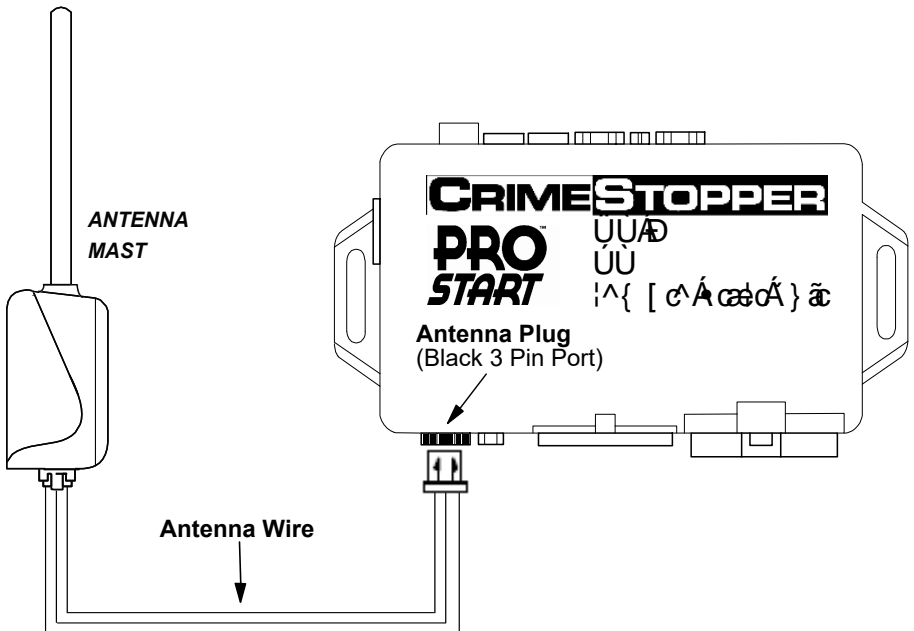
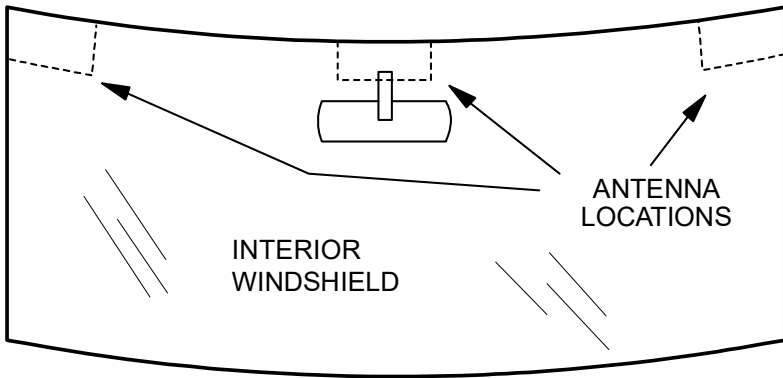

## STEP 3: Program the remotes

### RS0, RS1, RS3, RS4, RS7 remote programming procedure

Notes: When you enter remote programming mode, it will remove all previous remote codes from the system. When re-learning remotes or adding remotes, ALL your system's remote codes must be learned at time of programming!!

These systems allow storage of up to 4 different remote codes in memory.

1. Turn Ignition Key to the ON position. (Do not start vehicle).
2. Press Program/Valet button 4 times. Wait for the unit to flash the parking lights and/or honk horn and/or unit click exactly 4 times.
3. Press the Lock button of the first transmitter. You should get 1 light flash/honk/click confirming the remote is coded, then press Lock button of a second transmitter, the unit will flash/honk/click 2 times confirming the remote is coded and so on. If all 4 codes are learned, the unit will automatically exit code learning mode, otherwise turn key off. See diagram below.

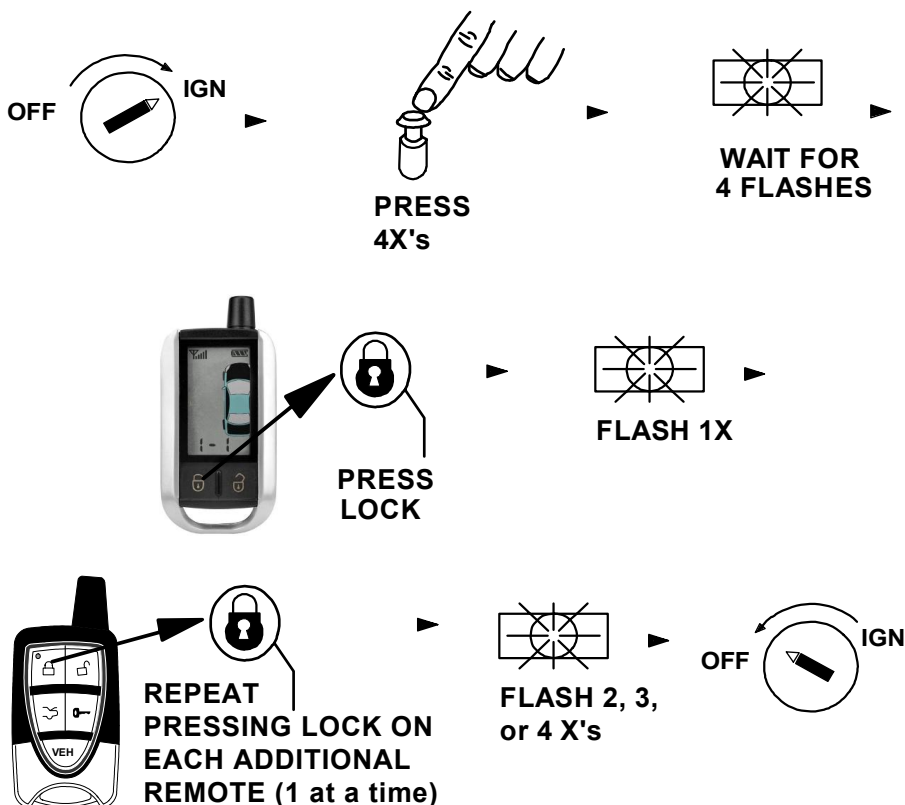

The remote(s) are now programmed.

# USING THE 2-WAY PAGER TRANSMITTER

## LCD SCREEN ICONS



### Note:

Some Icons on the LCD display only function on the Combo Alarm with Remote Start

## POWER ON / OFF FUNCTION

- To turn Power **ON**, press and hold UNLOCK button 2 seconds.
- To turn Power **OFF**, press and hold UNLOCK button 5 seconds.

# SIDE BUTTONS



**REMOTE  
START**

**VEHICLE  
SELECT**

**TRUNK  
RELEASE**

## AUX Outputs through Data

**AUX 1 = Trunk + Lock**

**AUX 2 = Trunk + Unlock**

**AUX 3 = Trunk + Start**

**AUX 4 = Lock + Start**

This remote can control up to 4 AUX functions through data depending on the vehicle and data module. This is typically used for operating left and right sliding doors.

**(Requires Canbus Data Module)**

## 2-WAY PAGER TRANSMITTER INFORMATION

The 2-Way LCD Pager remote transceiver is used to send and receive information from the vehicle. The Control Module transmits High Frequency FM signals from the vehicle to your pager over long distances. Your range will vary depending on location, terrain, and local RF noise/interference. This system is not guaranteed to page you if you are behind concrete walls, underground, in a large structure, or in an area with high levels of electronic interference. Handle the pager/remote with care. The LCD display and/or the electronics may be damaged if subjected to abuse.

## BATTERY CHARGING

The 2-Way LCD remote has a battery charge indicator on top right corner of display. The battery voltage affects the distance of the remote control. The system comes with a standard Mini USB charging cable that plugs into the side of remote control. To access to USB plug, slide the cover to the left shown below.



**USB  
Charging  
Port**

## SETTING THE CLOCK (2-WAY- LCD REMOTE)

1. Press VEH Button on the side of the remote control 5 times.
2. The remote will beep and the **AM or PM** display will begin flashing.
3. Press the Trunk Button to go to the next item – **AM - PM -Hour-Minutes**.
4. Press the Lock Button to **Increase** time.
5. Press the Unlock Button to **decrease** time.
6. Press the Start Button to **Disable or Enable Beep and Vibration**. See next page.
7. Press the VEH Button to **Save and Exit Setup** or wait 8 seconds, the LCD light will turn off.

## REMOTE BEEP & VIBRATE SELECTION

The LCD pager remote BEEPS and VIBRATES when it receives a signal from the vehicle. The Beeps and Vibration are selectable (on/off). To enter program mode:

1. Press VEH Button on the side of the remote control 5 times.
2. The remote will beep and the **AM or PM** display will begin flashing.
3. Press the Start button to choose the mode of "Beep ON/OFF & Vibrate ON/OFF".
4. Press the VEH Button to **Save and Exit Setup** or wait 8 seconds, the LCD light will turn off.

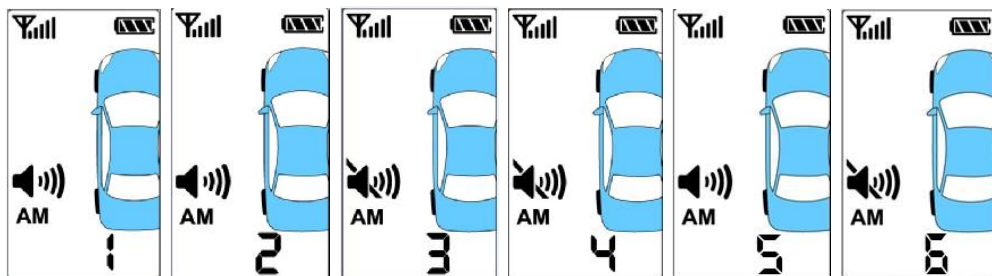

Mode 1: Beep ON & Vibrate ON. Remote Start Run Time Reminder Beep ON & Vibrate ON.  
 Mode 2: Beep ON & Vibrate OFF. Remote Start Run Time Reminder Beep ON & Vibrate OFF.  
 Mode 3: Beep OFF & Vibrate ON. Remote Start Run Time Reminder Beep OFF & Vibrate ON.  
 Mode 4: Beep OFF & Vibrate OFF. Remote Start Run Time Reminder Beep OFF & Vibrate OFF.  
 Mode 5: Beep ON & Vibrate OFF. Remote Start Run Time Reminder Beep OFF & Vibrate OFF.  
 Mode 6: Beep OFF & Vibrate ON. Remote Start Run Time Reminder Beep OFF & Vibrate OFF.