

Recommended P.C. Board Layout
SCALE 6:1

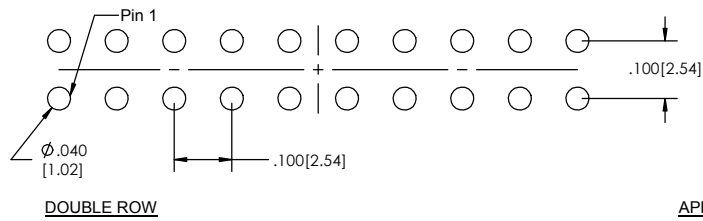

APPLICATION

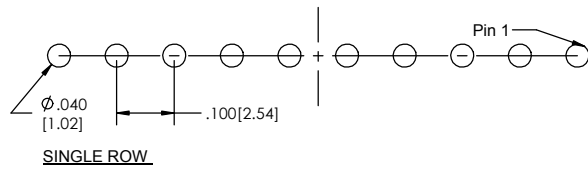
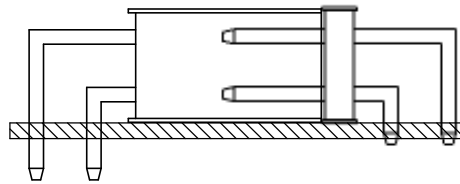

SINGLE ROW

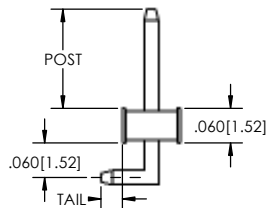

DOUBLE ROW

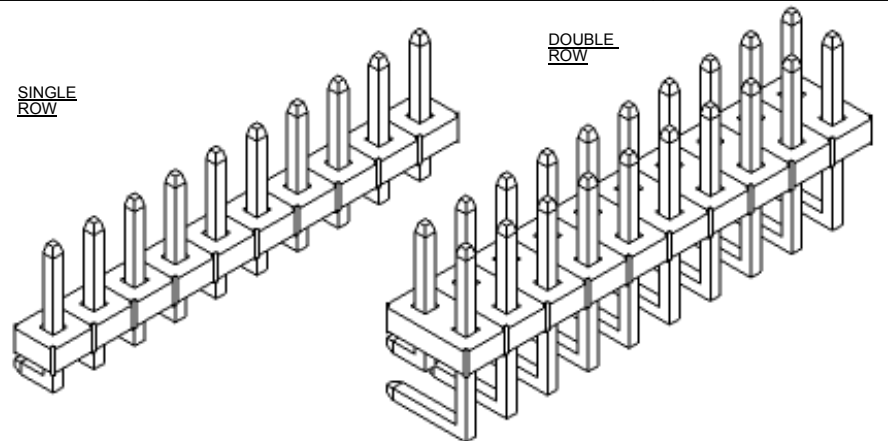
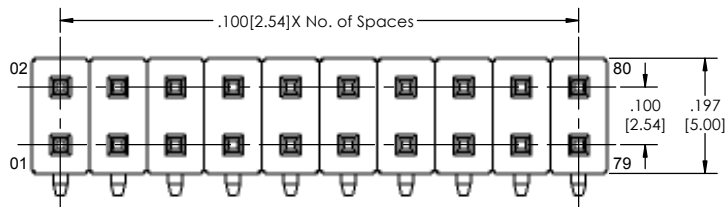
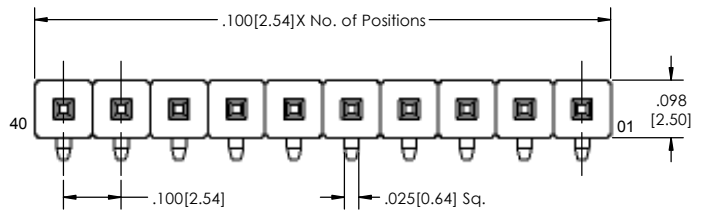
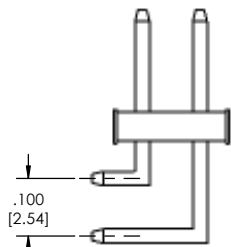

ULTSHCR-1 [XX] - [X] - [XXX] - [XX] - [XXX] - [XX] - [XX] - [XXX] - [X] - [LF]
(A) (B) (C) (D) (E) (F) (G) (H) (I) (J)

- A. Pins Per Row
 - 1 through 40
- B. Row Specification
 - S= Single
 - D= Dual Row
- C. Desired Tail Length
 - If Tail is not specified then: Tail(T) = Overall Length (L) - Post(P) - .150 [3.81]
- D. Pin Options
 - See Pin Options below
- E. Desired Post Height
 - Please specify
 - e.g. .230 [5.84] = 230
- F. Plating Options
 - See Plating Options below
- G. Lock Tight "LT" (Optional)
 - Leave blank if not needed
 - LT= With
- H. Polarized Position
 - Leave blank if not needed
 - If required, specify empty pin position
 - e.g. 012 for Pin 12
- I. Every Other Pin Filled (.200 Centers)
 - Leave blank if not needed
 - E= Filled
- J. Lead Free

Mates with:
BCSS.
BSSH.
BSSHC.
BSSQ.
BSSQC.
BSSQM.
LBCSS.
LSMBC.
LSWSS.
SMBC.
SSHQ.
SSHQR.
SSHR.
SSHS.
SSHSM.

Plating options	
G	-10µ Gold on Contact Area/ Flash on Tail
T	-Matte Tin all Over
GT	-10µ Gold on Contact Area/ Matte Tin on Tail
H	-30µ Gold on Contact Area/ Matte Tin on Tail
F	-Gold Flash over Entire Pin
FT	-Gold Flash on Contact Area/ Matte Tin on Tail

Pin Options		
Max. Post Length	Overall Pin Length	
.090 [2.29mm]	.330 [8.38mm]	03
.190 [4.83mm]	.430 [10.92mm]	06
.205 [5.21mm]	.445 [11.30mm]	08
.216 [5.49mm]	.456 [11.58mm]	10
.240 [6.10mm]	.480 [12.19mm]	11
.290 [7.37mm]	.530 [13.46mm]	14
.390 [9.91mm]	.630 [16.00mm]	16
.490 [12.45mm]	.730 [18.54mm]	20
.590 [14.99mm]	.830 [21.08mm]	22
.690 [17.53mm]	.930 [23.62mm]	24
.790 [20.07mm]	1.030 [26.16mm]	26
.890 [22.61mm]	1.130 [28.70mm]	28

Specifications:
Current Rating: 3.0 Ampere
Insulation Resistance: 1000M Ohms Min.
Dielectric Withstanding: 600V AC
Contact Resistance: 20M Ohms Max.
Operation Temperature: -40°C to +105°C
Max. Process Temperature
Peak: 260°C up to 20 secs.
Process: 230°C up to 60 secs.
Wave: 260°C up to 6 secs.
Manual Solder: 350°C up to 5 secs.

Materials:
Contact Material: Phosphor Bronze
Insulator Material: Nylon 6T
Plating: Au or Sn over 50µ" (1.27) Ni
Tails may be clipped to achieve specific dimensions.
Products cut to specific sizes are uncancellable/ nonreturnable.
Parts are subject to change without notice.



PROPRIETARY AND CONFIDENTIAL
THE INFORMATION CONTAINED IN THIS DRAWING IS THE SOLE PROPERTY OF Major League Electronics. ANY REPRODUCTION IN PART OR AS A WHOLE WITHOUT THE WRITTEN PERMISSION OF Major League Electronics IS PROHIBITED.

UNLESS OTHERWISE SPECIFIED:		NAME DATE		
DIMENSIONS ARE IN INCHES		DRAWN	EOW 01/13/14	
TOLERANCES:		CHECKED	GWE 01/13/14	
ONE DECIMALS ±.100		ENG APPR.		
TWO DECIMAL ±.010		MFG APPR.		ADDRESS:
THREE DECIMAL ±.005		INTERPRET GEOMETRIC TOLERANCING PER:		2533 Centennial Blvd.
FOUR DECIMAL ±.002		MATERIAL:		Jeffersonville, IN 47130
NEXT ASSY USED ON		FINISH:		Phone: 812-670-4174
APPLICATION		DO NOT SCALE DRAWING		Fax: 812-670-4175
				E-Mail: mle@mlelectronics.com
TITLE: ULTSHCR-1 SERIES				SIZE DWG. NO.
SCALE 6:1				REV B
SHEET 1 OF 1				