

Recommended P.C. Board Layout
SCALE 10:1

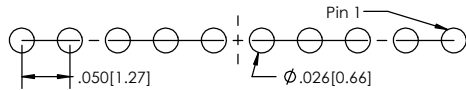

Single Row

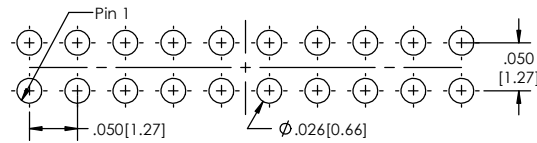

Double Row

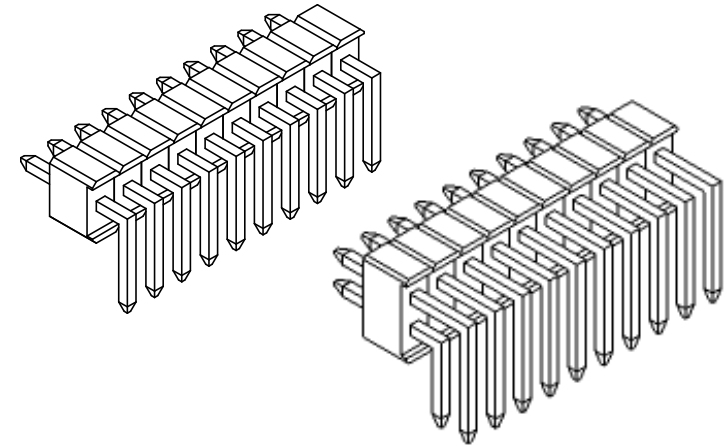

APPLICATION

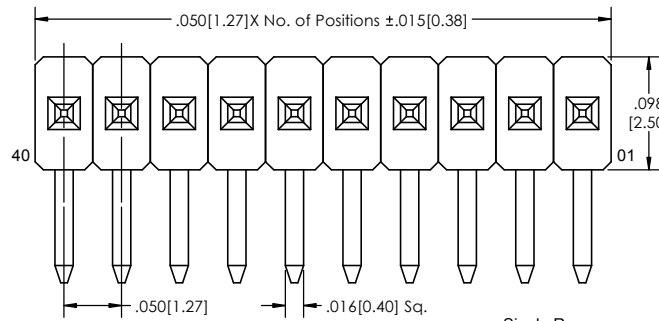
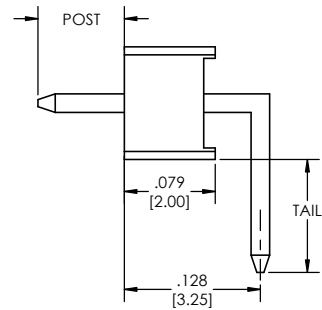
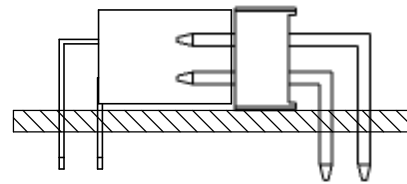

Single Row

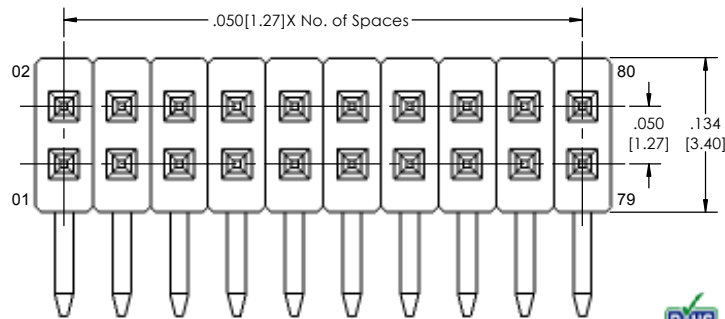
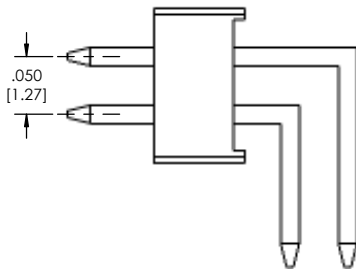

Double Row

TTSHCR-5 **XX** - **X** - **XXX** - **XX** - **XXX** - **XX** - **XXX** - **LF**
(A) (B) (C) (D) (E) (F) (G) (H)

- A. Pins Per Row**
- 1 through 40
- B. Row Specification**
- S= Single Row
- D= Double Row
- C. Desired Tail**
- .040 [1.02] - .300 [7.62]
- D. Pin Options**
- See Pin Option box below
- E. Desired Post Height**
- .040 [1.02] - .400 [10.20]
- F. Plating Options**
- See Plating Options below
- G. Polarized Position**
- Leave blank if not required
- e.g. .200 [5.08] = 200
- H. Lead Free**

Mates with:
LSSHS
SMSS
SSHS

| Plating Options | |
|-----------------|---|
| G | Gold on Contact Area/ Flash on Tail |
| T | Matte Tin all Over |
| GT | 10µ Gold on Contact Area/ Matte Tin on Tail |
| H | 30µ Gold on Contact Area/ Matte Tin on Tail |
| F | Gold Flash over Entire Pin |
| FT | Gold Flash on Contact Area/ Matte Tin on Tail |

| Pin Options | |
|----------------|----------------|
| Overall Length | Max. Post |
| .430 [10.92] | .125 [3.17] 08 |
| .480 [12.19] | .175 [4.44] 10 |
| .530 [13.46] | .225 [5.71] 12 |
| .580 [14.73] | .275 [6.98] 14 |

Post + Tail + .110 [2.80] must not exceed Overall Length

Specifications:
Current Rating: 1.0 Ampere
Insulation Resistance: 1000M Ohms Min.
Dielectric Withstanding: 300V AC
Contact Resistance: 20M Ohms Max.
Operation Temperature: -40°C to +105°C
Max. Process Temperature
Peak: 260°C up to 10 secs.
Process: 230°C up to 60 secs.
Wave: 260°C up to 6 secs.
Manual Solder: 350°C up to 5 secs.

Materials:
Contact Material: Phosphor Bronze
Insulator Material: Nylon 6T
Plating: Au or Sn over 50µ" [1.27] Ni

Tails may be clipped to achieve specific dimensions
Products cut to specific sizes are uncancellable/ nonreturnable.
Parts are subject to change without notice.



PROPRIETARY AND CONFIDENTIAL
THE INFORMATION CONTAINED IN THIS DRAWING IS THE SOLE PROPERTY OF Major League Electronics. ANY REPRODUCTION IN PART OR AS A WHOLE WITHOUT THE WRITTEN PERMISSION OF Major League Electronics IS PROHIBITED.

| | | | |
|-----------------------------|----------------------|------------------------|--------------|
| UNLESS OTHERWISE SPECIFIED: | | NAME | DATE |
| DIMENSIONS ARE IN INCHES | | DRAWN | EOW 12/05/14 |
| TOLERANCES: | | CHECKED | GWE 12/05/14 |
| ONE DECIMALS ±.100 | | ENG APPR. | |
| TWO DECIMAL ±.010 | | MFG APPR. | |
| THREE DECIMAL ±.005 | | D.A. | |
| FOUR DECIMAL ±.002 | | ADDRESS: | |
| NEXT ASSY | USED ON | FINISH | |
| APPLICATION | DO NOT SCALE DRAWING | | |
| | | TITLE: TTSHCR-5 SERIES | |
| | | SIZE | DWG. NO. |
| | | C | A |
| | | SCALE 12:1 | SHEET 1 OF 1 |

