

Recommended P.C. Board Layout

SCALE 12:1

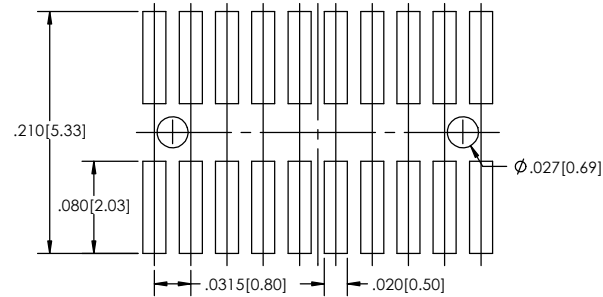

TSHSCM-8 **XX** - **D** - **06** - **XXX** - **XX** - **XXX** - **XX** - **X** - **XX** - **LF**
(A) (B) (C) (D) (E) (F) (G) (H) (I) (J)

- A. Pins Per Row
- 3 through 50
- B. Row Specification
- D= Dual Row
- C. Surface Mount
- 06
- D. Desired Post Height
- Please specify
- e.g. 100[2.54]=100
- E. Plating Options
- See Plating Options below
- F. Polarized Position
- Leave blank if not needed
- If required, specify empty pin position
- e.g. 012 for Pin 12
- G. Packing Information
- TR= Tape and Reel
- TB= Tube
- H. Pad
- P= Plastic
- O= No Pad
- If left blank packaging at MLE's discretion
Pad may be metal, mylar or plastic
- I. Alignment Pin
- Leave blank if not needed
- AP= With
- J. Lead Free

Mates with:
SMSS-8

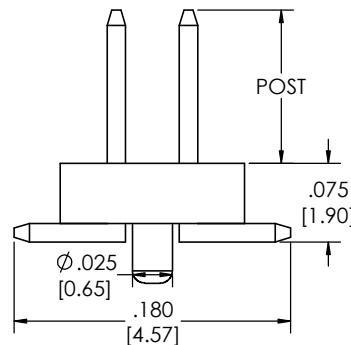
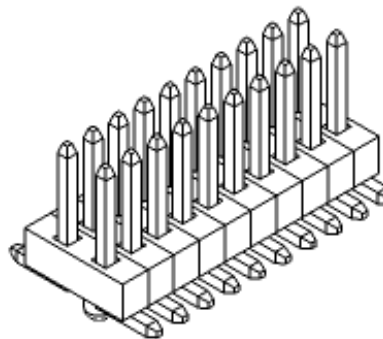
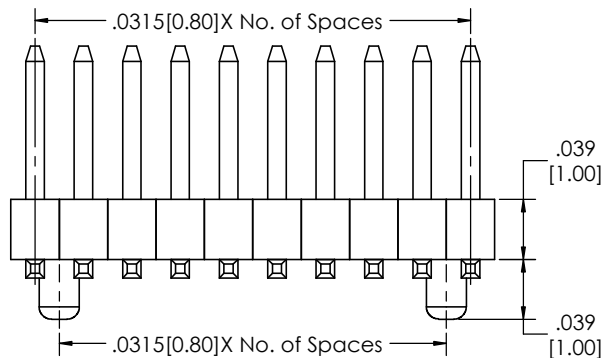
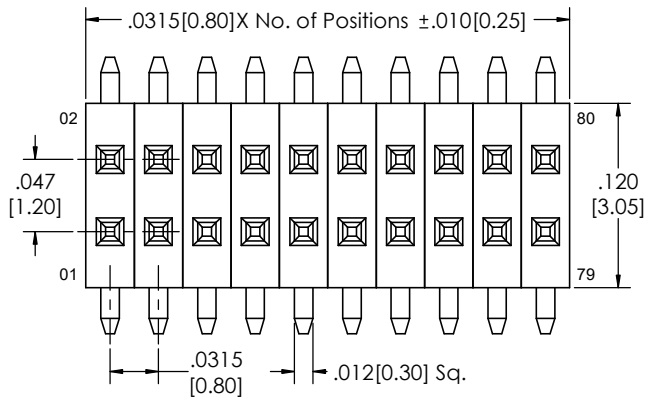

Plating options	
T	-Matte Tin all Over
F	-Gold Flash over Entire Pin
FT	- Gold Flash on Contact Area/ Matte Tin on Tail

Specifications:
Current Rating: 0.5 Ampere
Insulation Resistance: 500M Ohms min.
Dielectric Withstanding: 200V AC/DC
Contact Resistance: 20M Ohms Max.
Operation Temperature: -40°C to +105°C
Max. Process Temperature
Peak: 260°C up to 10 secs.
Process: 230°C up to 60 secs.
Wave: 260°C up to 6 secs.
Reflow: 260°C up to 10 secs.
Manual Solder: 350°C up to 5 secs.

Materials:
Contact Material: Phosphor Bronze
Insulator Material: Nylon 9T, UL94V-0

Tails may be clipped to achieve specific dimensions.
Products cut to specific sizes are uncancellable/ nonreturnable.
Parts are subject to change without notice.



PROPRIETARY AND CONFIDENTIAL
THE INFORMATION CONTAINED IN THIS
DRAWING IS THE SOLE PROPERTY OF
Major League Electronics. ANY
REPRODUCTION IN PART OR AS A WHOLE
WITHOUT THE WRITTEN PERMISSION OF
Major League Electronics IS
PROHIBITED.

UNLESS OTHERWISE SPECIFIED:		NAME	DATE
DIMENSIONS ARE IN INCHES TOLERANCES: ONE DECIMALS ±.100 TWO DECIMAL ±.005 THREE DECIMAL ±.002 FOUR DECIMAL ±.002		DRAWN EOW	06/02/16
INTERPRET GEOMETRIC TOLERANCING PER:		CHECKED GWE	06/02/16
MATERIAL		ENG APPR.	
NEXT ASSY		MFG APPR.	
USED ON		ADDRESS: 2533 Centennial Blvd. Jeffersonville, In 47130 Phone: 812-670-4174 Fax: 812-670-4175 E-Mail: mle@mlelectronics.com	
APPLICATION		TITLE: TSHSCM-8-V SERIES	
DO NOT SCALE DRAWING		SIZE C	REV D
		SCALE 16:1	SHEET 1 OF 1