

Recommended P.C. Board Layout SCALE 8:1

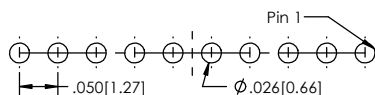

SINGLE ROW

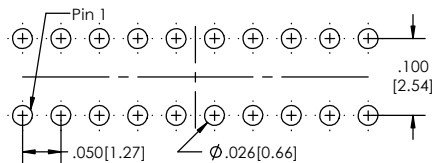

DOUBLE ROW

SINGLE ROW

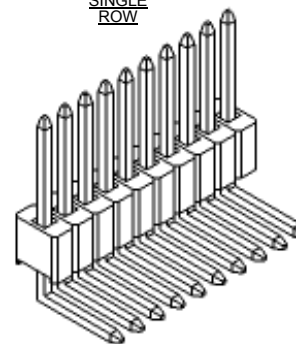

DOUBLE ROW

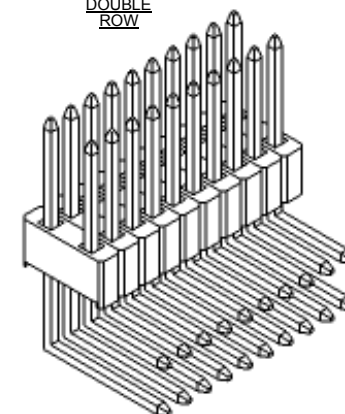

APPLICATION

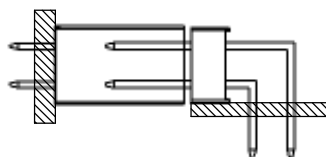

TSHR-6 XX-X-XX-XX-XXX-LF
(A) (B) (C) (D) (E) (F)

- A. Pins Per Row
- 1 through 40
B. Row Specification
- S= Single Row
- D= Double Row
C. Pin Options
- See Pin Options below
D. Plating Options
- See Plating Options below
E. Polarized Position
- Leave blank if not needed
- If required, specify empty pin position
- e.g. 012 for Pin 12
F. Lead Free

Mates with:
LSSH
SMSS
SSHS

Plating options	
G	-10µ Gold on Contact Area/ Flash on Tail
T	-Matte Tin all Over
GT	-10µ Gold on Contact Area/ Matte Tin on Tail
H	-30µ Gold on Contact Area/ Matte Tin on Tail
F	-Gold Flash over Entire Pin
FT	-Gold Flash on Contact Area/ Matte Tin on Tail

Pin Options	
Post Height- .140 Tail	
.100	2.54mm 04
.125	3.18mm 06
.180	4.57mm 08
.230	5.84mm 10
.285	7.24mm 12
.300	7.62mm 14
.325	8.25mm 16
.380	9.65mm 18
.430	10.92mm 20
.500	12.70mm 22
.725	18.41mm 24

Specifications:
Current Rating: 1.0 Ampere
Insulation Resistance: 1000M Ohms Min.
Dielectric Withstanding: 300V AC
Contact Resistance: 20M Ohms Max.
Operation Temperature: -40°C to +105°C
Max. Process Temperature
Peak: 260°C up to 10 secs.
Process: 230°C up to 60 secs.
Wave: 260°C up to 6 secs.
Manual Solder: 350°C up to 5 secs.

Materials:
Contact Material: Phosphor Bronze
Insulator Material: Nylon 6T
Plating: Au or Sn over 50µ" (1.27) Ni

Tails may be clipped to achieve specific dimensions.
Products cut to specific sizes are uncancellable/ nonreturnable.
Parts are subject to change without notice.

UNLESS OTHERWISE SPECIFIED:		NAME		DATE
DRAWN		EOW	02/12/14	
CHECKED		GWE	02/12/14	
ENG APPR.				
MFG APPR.				
ADDRESS:		2533 Centennial Blvd. Jeffersonville, In 47130 Phone: 812-670-4174 Fax: 812-670-4175 E-Mail: mle@ml-electronics.com		
TITLE: TSHR-6 SERIES		REV B		
SIZE C		DWG. NO.		
SCALE 8:1		SHEET 1 OF 1		



PROPRIETARY AND CONFIDENTIAL
THE INFORMATION CONTAINED IN THIS DRAWING IS THE SOLE PROPERTY OF Major League Electronics. ANY REPRODUCTION IN PART OR AS A WHOLE WITHOUT THE WRITTEN PERMISSION OF Major League Electronics IS PROHIBITED.

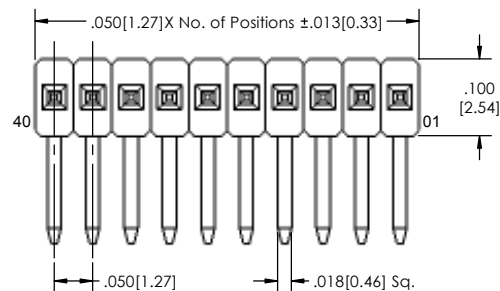
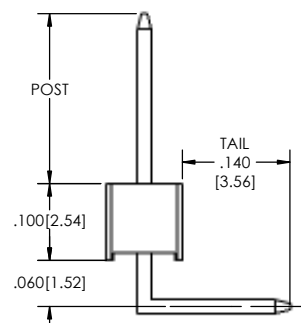

SINGLE ROW

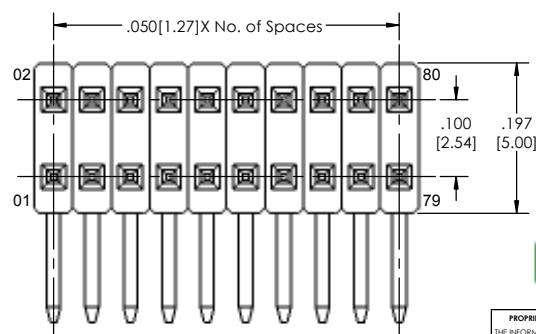

DOUBLE ROW

