

# APPLICATION

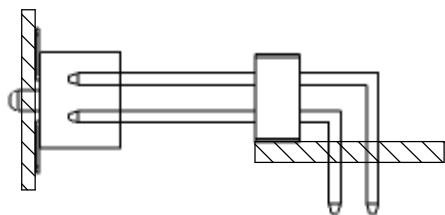

## Recommended P.C. Board Layout SCALE 12:1

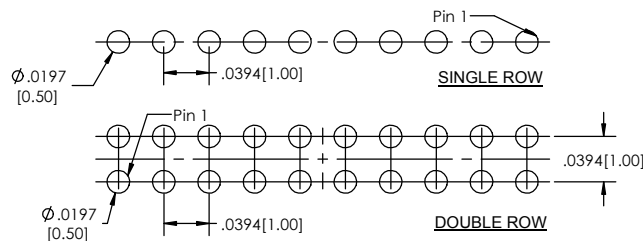

# SINGLE ROW

# DOUBLE ROW

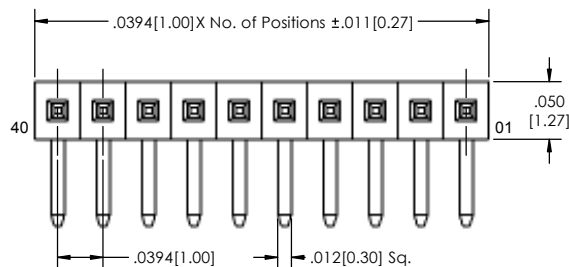
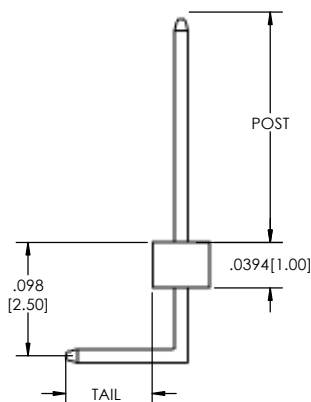
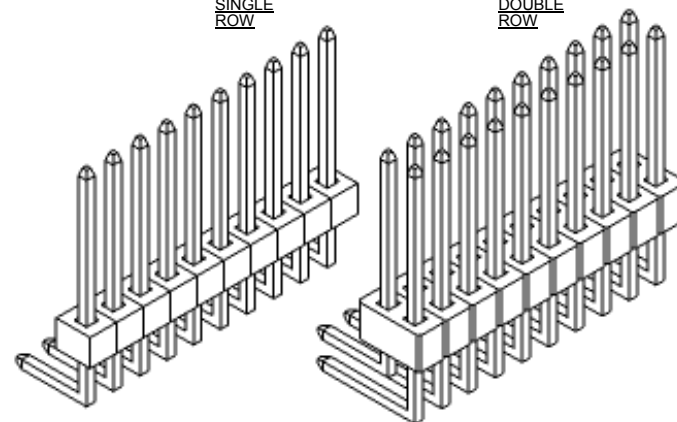

## SINGLE ROW

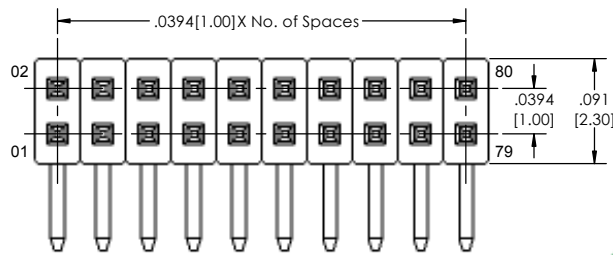

## DOUBLE ROW

TSHCR-7 **XX** - **X** - **XXX** - **02** - **XXX** - **XX** - **LF**  
(A) (B) (C) (D) (E) (F) (G)

- A. Pins Per Row  
1 through 40
- B. Row Specification  
- S= Single Row  
- D= Double Row
- C. Desired Tail Length  
- .040 [1.02] - .110 [2.79]  
- If left blank, Tail .090 [2.31]
- D. Pin Option  
- 02= Overall Length .350 [8.89]
- E. Desired Post Height  
- .060 [1.52] - .150 [3.81]
- F. Plating Options  
- See Plating Options below
- G. Lead Free

Plating options
T - Matte Tin all Over
F - Gold Flash over Entire Pin

Specifications:

Current Rating: 1.0 Ampere

Insulation Resistance: 1000M Ohms Min.

Dielectric Withstanding: 300V AC

Contact Resistance: 20M Ohms Max.

Operation Temperature: -40°C to +105°C

Max. Process Temperature

Wave Solder: Solder Temp 260  $\pm 5^\circ\text{C}$   
Immersion period: 5  $\pm 5$  secs.

Reflow Solder: Pre-Heat Temp: 100- 150°C for 60 secs max  
Temperature: min. 210°C for 30 secs max.  
Peak Temperature: 260  $\pm 5^\circ\text{C}$ , 10  $\pm 5$  secs.

Manual Solder: 245  $\pm 3^\circ\text{C}$  3-5 secs.

Materials:

Contact Material: Phosphor Bronze

Insulator Material: LCP, UL94V-0

Tails may be clipped to achieve specific dimensions.

Products cut to specific sizes are uncancellable/ nonreturnable.

Parts are subject to change without notice.

UNLESS OTHERWISE SPECIFIED:		NAME		DATE
DIMENSIONS ARE IN INCHES		DRAWN	EOW	10/31/14
TOLERANCES:		CHECKED	GWE	10/31/14
ONE DECIMALS $\pm .100$		ENG APPR.		
TWO DECIMAL $\pm .010$		MFG APPR.		
THREE DECIMAL $\pm .005$		ADDRESS:		
FOUR DECIMAL $\pm .002$		2533 Centennial Blvd.		
INTERPRET GEOMETRIC TOLERANCING PER:		Jeffersonville, IN 47130		
MATERIAL:		Phone: 812-670-4174		
FINISH:		Fax: 812-670-4175		
NEXT ASSY		E-Mail: mle@mllelectronics.com		
USED ON:		TITLE: TSHCR-7 SERIES		
APPLICATION		DO NOT SCALE DRAWING		
		SIZE DWG. NO.		
		C		
		REV B		
		SCALE 12:1		
		SHEET 1 OF 1		



PROPRIETARY AND CONFIDENTIAL  
THE INFORMATION CONTAINED IN THIS DRAWING IS THE SOLE PROPERTY OF Major League Electronics. ANY REPRODUCTION IN PART OR AS A WHOLE WITHOUT THE WRITTEN PERMISSION OF Major League Electronics IS PROHIBITED.

