

Recommended P.C. Board Layout
SCALE 8:1

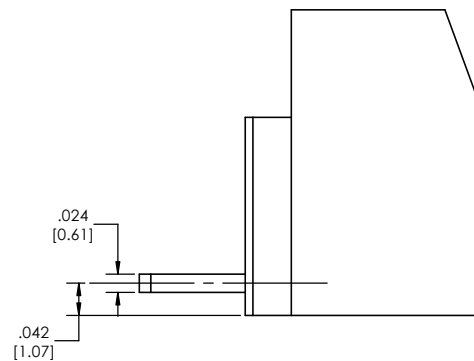
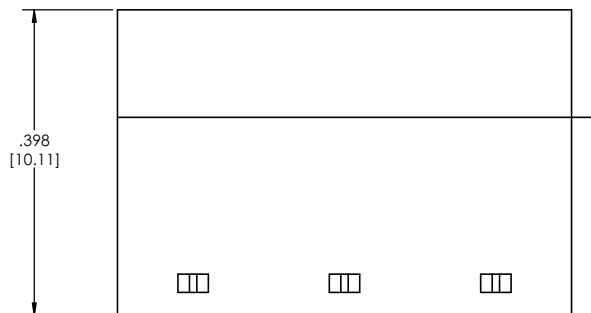
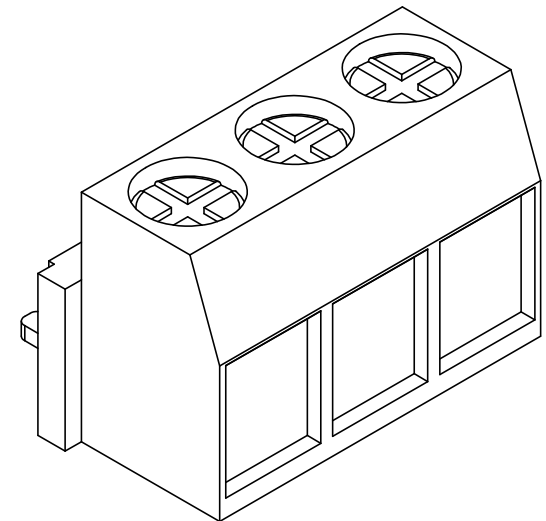
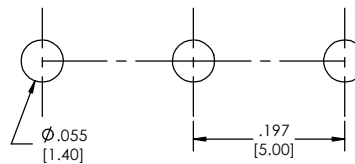

TBR - 06 - **197** - **XX** - **XX** - **LF**
(A) (B) (C) (D)

- A. Pitch
- 197= .197(5.00) cl
- B. No. of Positions
- 02-16
- C. Color
- GR= Green (Standard)
- BK= Black
- BL= Blue
- RD= Red
- D. Lead Free
- Specifications:
Current Rating: 10 Ampere
Voltage Rating: 300V
Contact Resistance: 20 mohm
Wire Range: 26-14 AWG
Insulation Resistance: 5000Mohm/ 1000V
Dielectric Withstanding Voltage: AC 2000V/1 minute
Temperature Range: -40°C to +105°C
Max. Soldering: +250°C for 5 seconds
Torque: 0.4Nm (3.61 B.IN)
Strip Length: 6-7mm

- Materials:
1. Screws: M2.5 Steel Zinc Plated
2. Wire Guard: Phosphor Bronze NI plate or Stainless Steel
3. Pin Header: Brass, Tin Plated
4. Housing: PA66, UL94V-0

Tails may be clipped to achieve specific dimensions.
Products cut to specific sizes are uncancellable/ nonreturnable.
Parts are subject to change without notice.



PROPRIETARY AND CONFIDENTIAL
THE INFORMATION CONTAINED IN THIS
DRAWING IS THE SOLE PROPERTY OF
Major League Electronics. ANY
REPRODUCTION IN PART OR AS A WHOLE
WITHOUT THE WRITTEN PERMISSION OF
Major League Electronics IS
PROHIBITED.

UNLESS OTHERWISE SPECIFIED:		NAME		DATE
DIMENSIONS ARE IN INCHES TOLERANCES: ONE DECIMALS ±.100 TWO DECIMAL ±.010 THREE DECIMAL ±.005 FOUR DECIMAL ±.002		DRAWN	EOW	04/16/14
NEXT ASSY		CHECKED	GWE	04/16/14
USED ON		ENG APPR.		
APPLICATION		MFG APPR.		
DO NOT SCALE DRAWING		ADDRESS: 2533 Centennial Blvd. Jeffersonville, IN 47130 Phone: 812-670-4174 Fax: 812-670-4175 E-Mail: mle@mllelectronics.com		
INTERPRET GEOMETRIC TOLERANCING PER:		TITLE: TBR-06-197 Series		
FINISH		SIZE DWG. NO. REV		
		C		
		SCALE 8:1 SHEET 1 OF 1		

