

**Recommended P.C. Board Layout**  
SCALE 6:1

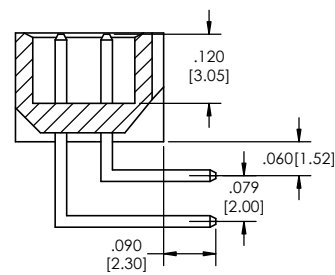
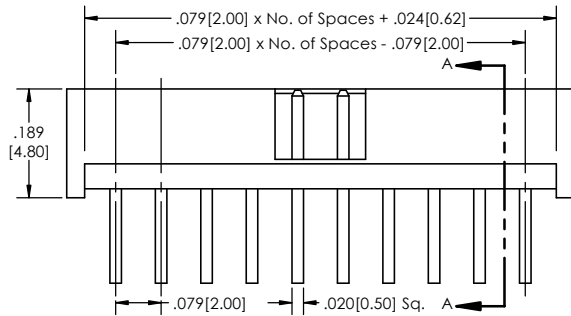
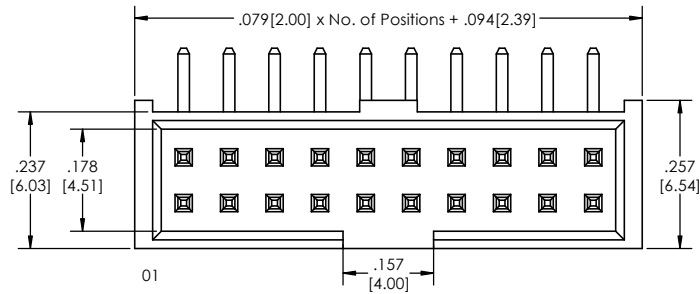
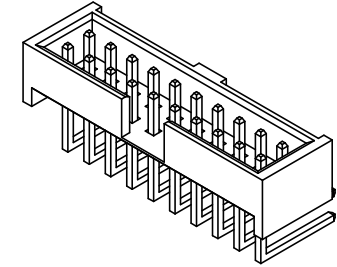
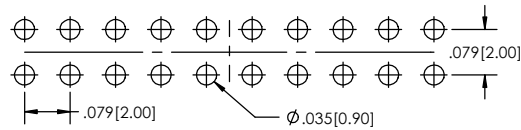

SECTION A-A  
SCALE 6 : 1

STSHR-2 **XX** - **D** - **XX** - **XX** - **XXX** - **LF**  
(A) (B) (C) (D) (E) (F)

- A. Pins Per Row**  
- 04-25
- B. Row Specification**  
- D= Double Row
- C. Pin Options**  
- See Pin Options below
- D. Plating Options**  
- See Plating Options below
- E. Polarized Position**  
- Leave blank if not needed  
- If required, specify empty pin position  
- 001-050
- F. Lead Free**

**Mates With:**  
BCSS-2 SSHQ-2  
BSSQ-2 SSHQR-2  
BSSQC-2 SSHR-2  
BSSQM-2 SSHS-2  
LSMBC-2 SSHSM-2  
LSSHSM-2 ULSMBC-2  
SMBC-2

Plating options	
G	-10µ Gold on Contact Area/ Flash on Tail
T	-Matte Tin all Over
GT	-10µ Gold on Contact Area/ Matte Tin on Tail
H	-30µ Gold on Contact Area/ Matte Tin on Tail
F	-Gold Flash over Entire Pin
FT	- Gold Flash on Contact Area/ Matte Tin on Tail

Pin Options	
Tail Length	02
.090 [2.30mm]	

**Specifications:**  
Current Rating: 2 Ampere  
Insulation Resistance: 1000M Ohms Min.  
Dielectric Withstanding: 500V AC/DC  
Contact Resistance: 20M Ohms Max.  
Operation Temperature: -40°C to +105°C

**Materials:**  
Contact Material: Phosphor Bronze  
Insulator Material: LCP UL94V-0 Black

Tails may be clipped to achieve specific dimensions.  
Products cut to specific sizes are uncancellable/ nonreturnable.  
Parts are subject to change without notice.



**PROPRIETARY AND CONFIDENTIAL**  
THE INFORMATION CONTAINED IN THIS DRAWING IS THE SOLE PROPERTY OF Major League Electronics. ANY REPRODUCTION IN PART OR AS A WHOLE WITHOUT THE WRITTEN PERMISSION OF Major League Electronics IS PROHIBITED.

UNLESS OTHERWISE SPECIFIED:		NAME	DATE
DIMENSIONS ARE IN INCHES		DRAWN	EOW 10/13/16
TOLERANCES:		CHECKED	GWE 10/13/16
ONE DECIMALS ±.100		ENG APPR.	
TWO DECIMAL ±.010		MFG APPR.	
THREE DECIMAL ±.005		ADDRESS:	
FOUR DECIMAL ±.002		2533 Centennial Blvd.	
NEXT ASSY USED ON		Jeffersonville, IN 47130	
APPLICATION		Phone: 812-670-4174	
DO NOT SCALE DRAWING		Fax: 812-670-4175	
		E-Mail: mle@ml-electronics.com	
		TITLE: STSHR-2 SERIES	
		SIZE	DWG. NO.
		C	A
		SCALE 6:1	SHEET 1 OF 1

