

**Recommended P.C. Board Layout**  
SCALE 8:1

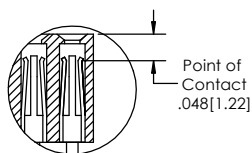

**APPLICATION**

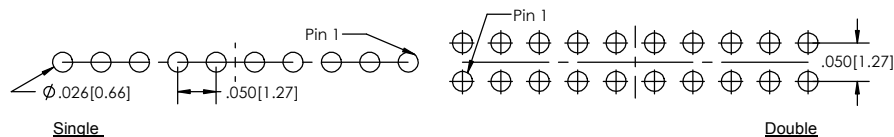
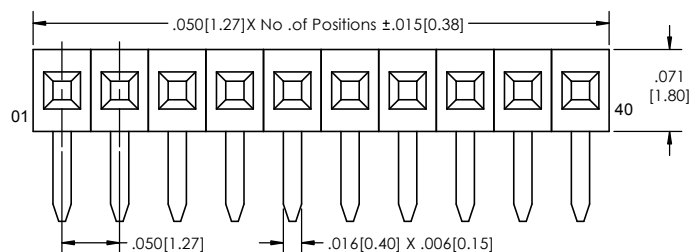
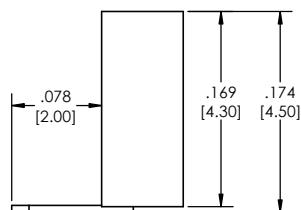
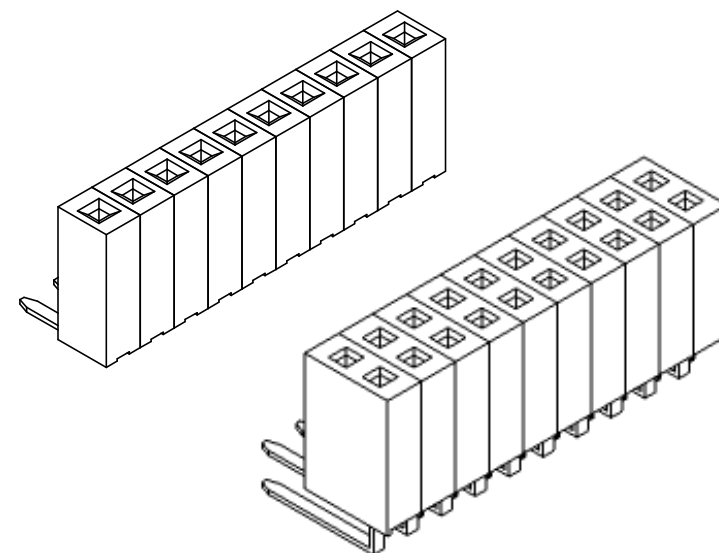
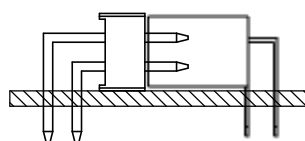

**SINGLE ROW**

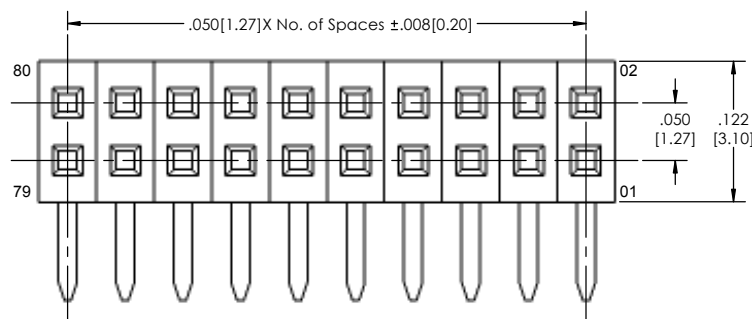

**DOUBLE ROW**

SSHR-5 **XX** - **X** - **02** - **XX** - **LF**  
(A) (B) (C) (D) (E)

- A. Pins Per Row  
- 3 through 50  
B. Row Specification  
- S= Single Row  
- D= Double Row  
C. Right Angle Tail Length  
- Please specify tail length  
D. Plating Options  
- See Plating Options below  
E. Lead Free

Plating options	
G	-10 $\mu$ Gold on Contact Area/ Flash on Tail
T	-Matte Tin all Over
GT	-10 $\mu$ Gold on Contact Area/ Matte Tin on Tail
H	-30 $\mu$ Gold on Contact Area/ Matte Tin on Tail
F	-Gold Flash over Entire Pin
FT	- Gold Flash on Contact Area/ Matte Tin on Tail

Specifications:  
Current Rating: 1.0 Ampere  
Insulation Resistance: 1000M Ohms Min.  
Dielectric Withstanding: 300V AC  
Contact Resistance: 20M Ohms Max.  
Operation Temperature: -40°C to +105°C  
Max. Process Temperature  
Peak: 260°C up to 20 secs.  
Process: 230°C up to 60 secs.  
Wave: 260°C up to 6 secs.  
Manual Solder: 350°C up to 5 secs.

Materials:  
Contact Material: Phosphor Bronze  
Insulator Material: Thermoplastic, UL94V-0, PBT

Tails may be clipped to achieve specific dimensions.

Products cut to specific sizes are uncancellable/ nonreturnable.  
Parts are subject to change without notice.



PROPRIETARY AND CONFIDENTIAL  
THE INFORMATION CONTAINED IN THIS DRAWING IS THE SOLE PROPERTY OF Major League Electronics. ANY REPRODUCTION IN PART OR AS A WHOLE WITHOUT THE WRITTEN PERMISSION OF Major League Electronics IS PROHIBITED.

UNLESS OTHERWISE SPECIFIED:		NAME		DATE	
DIMENSIONS ARE IN INCHES		DRAWN	EOW	01/21/15	
TOLERANCES:		CHECKED	GWE	01/21/15	
ONE DECIMALS $\pm .100$		ENG APPR.			
TWO DECIMAL $\pm .010$		MFG APPR.			ADDRESS:
THREE DECIMAL $\pm .005$		FINISH			2533 Centennial Blvd.
FOUR DECIMAL $\pm .002$		DO NOT SCALE DRAWING			Jeffersonville, IN 47130
NEXT ASSY	USED ON	APPLICATION			Phone: 812-670-4174
					Fax: 812-670-4175
					E-Mail: mle@ml-electronics.com
					TITLE: SSHR- 5 SERIES
					SIZE DWG. NO.
					REV C
					SCALE 12:1
					SHEET 1 OF 1