

Recommended P.C. Board Layout
SCALE 6:1

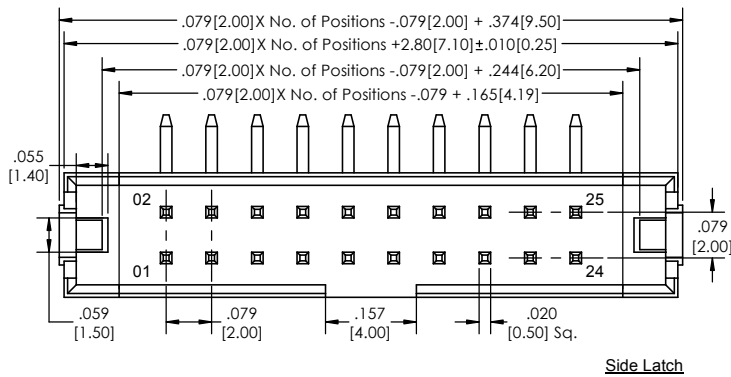

Side Latch

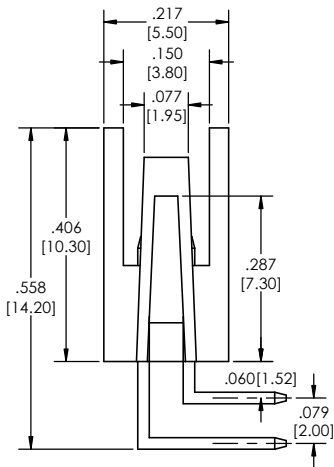
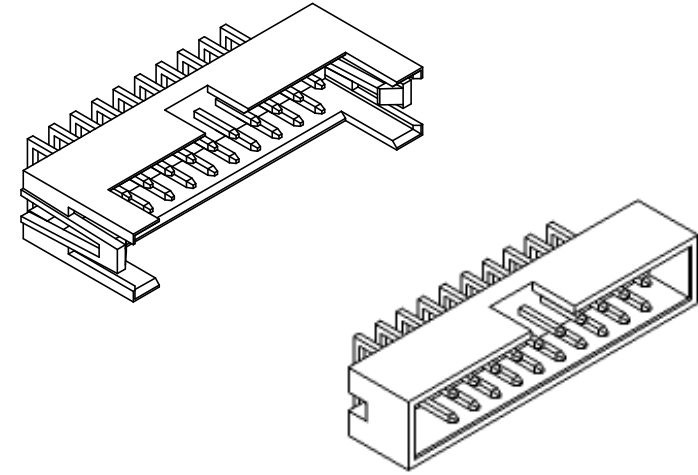
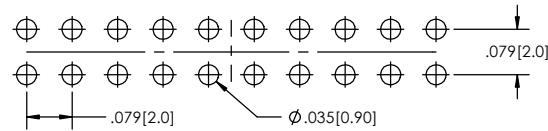
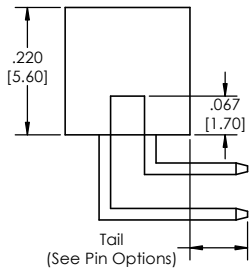

Tail
(See Pin Options)

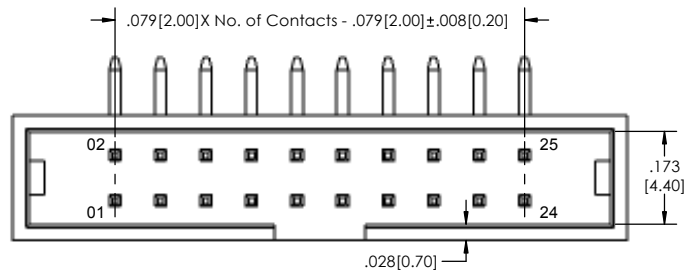

SHTSHR-2 [XX] - [D] - [XX] - [A] - [XX] - [XX] - [XXX] - [LF]
(A) (B) (C) (D) (E) (F) (G) (H)

- A. Pins Per Row
 - 5 through 25
- B. Row Specification
 - D= Double Row
- C. Pin Options
 - See Pin Options below
- D. Post Option
 - See Plating Options below
- E. Plating Options
 - See Plating Options below
- F. Side Latch Option
 - SL= With
 - Leave blank if not needed
- G. Polarized Position
 - Leave blank if not needed
 - If required, specify empty pin position
 - 001-050
- H. Lead Free

Mates With:
IDS-2

Plating options	
G	-10 μ Gold on Contact Area/ Flash on Tail
T	-Matte Tin all Over
GT	-10 μ Gold on Contact Area/ Matte Tin on Tail
H	-30 μ Gold on Contact Area/ Matte Tin on Tail
F	-Gold Flash over Entire Pin
FT	-Gold Flash on Contact Area/ Matte Tin on Tail

Pin Options	
Tail Length	
.100 [2.54mm]	02
.118 [3.00mm]	04

Specifications:
Current Rating: 1.0 Ampere
Insulation Resistance: 1000M Ohms Min.
Dielectric Withstanding: 500V AC/DC
Contact Resistance: 20M Ohms Max.
Operation Temperature: -40°C to +105°C

Materials:
Contact Material: Copper Alloy
Insulator Material: Polyester UL 94V-0 Nylon 6T

Tails may be clipped to achieve specific dimensions.
Products cut to specific sizes are uncancellable/ nonreturnable.
Parts are subject to change without notice.



PROPRIETARY AND CONFIDENTIAL
THE INFORMATION CONTAINED IN THIS DRAWING IS THE SOLE PROPERTY OF Major League Electronics. ANY REPRODUCTION IN PART OR AS A WHOLE WITHOUT THE WRITTEN PERMISSION OF Major League Electronics IS PROHIBITED.

UNLESS OTHERWISE SPECIFIED:		NAME		DATE
DIMENSIONS ARE IN INCHES		DRAWN	EOW	03/13/14
TOLERANCES:		CHECKED	GWE	03/13/14
ONE DECIMALS ±.100		ENG APPR.		
TWO DECIMAL ±.010		MFG APPR.		
THREE DECIMAL ±.005		ADDRESS:		
FOUR DECIMAL ±.002		2533 Centennial Blvd.		
NEXT ASSY		Jeffersonville, IN 47130		
USED ON		Phone: 812-670-4174		
APPLICATION		Fax: 812-670-4175		
DO NOT SCALE DRAWING		E-Mail: mle@mllelectronics.com		
FINISH		TITLE: SHTSHR-2 SERIES		REV
		SIZE DWG. NO.		D
		SCALE 8:1		SHEET 1 OF 1

