

Recommended P.C. Board Layout

SCALE 6:1

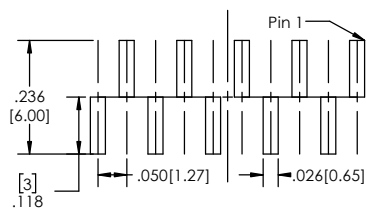

Single (S)

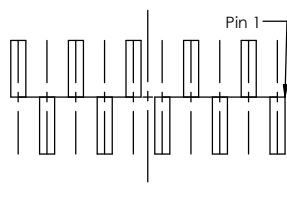

Single (M)

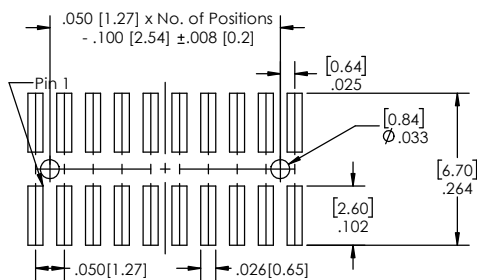

Double

Single (S)

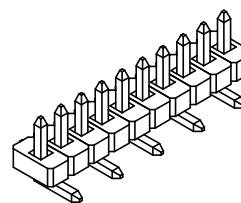

Single (M)

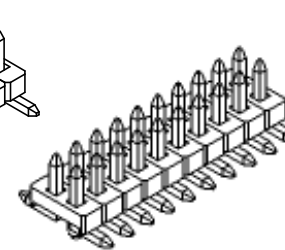
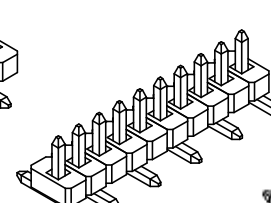

LTSHSM-5 **XX** - **X** - **XX** - **XX** - **V** - **XXX** - **X** - **XX** - **X** - **XX** - **LF**
(A) (B) (C) (D) (E) (F) (G) (H) (I) (J) (K)

- A. Pins Per Row
 - 1 through 40
- B. Row Specification
 - S= Single Row
 - D= Double Row
- C. Pin Options
 - See Pin Options below
- D. Plating Options
 - See Plating Options below
- E. Vertical
- F. Polarized Position
 - Leave blank if not needed
 - If required, specify empty pin position
 - e.g. 012 for Pin 12
- G. Footprint option (only for single row)
 - S= Pin 1 left
 - M= Pin 1 right
- H. Packing Information
 - TR= Tape and Reel
 - TB= Tube
- I. Pad
 - P= Plastic
 - O= No Pad
 - If left blank packaging left to MLE's discretion
 - Pad may be metal, mylar or plastic
- J. Alignment Pin Option (Only for Double Row)
 - Leave blank if not needed.
 - AP=With
- K. Lead Free

Mates with:
LSSH
SMSS
SSHS

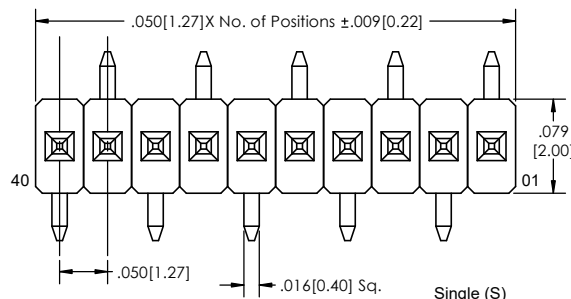
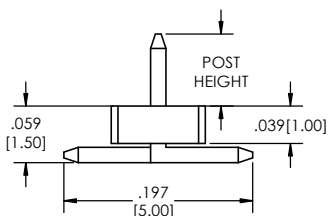

Single (S)

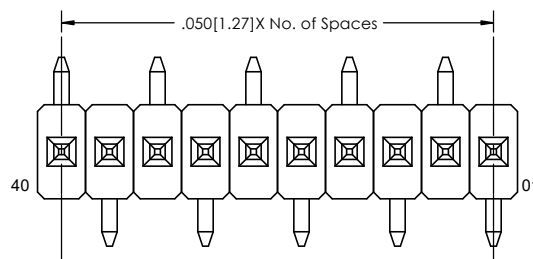

Single (M)

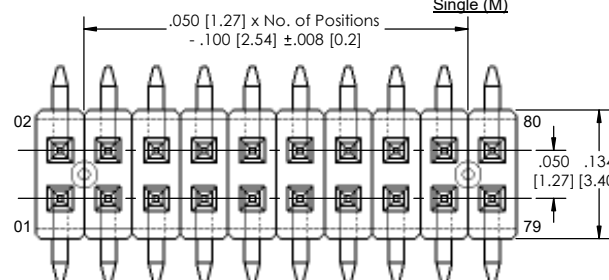

Double

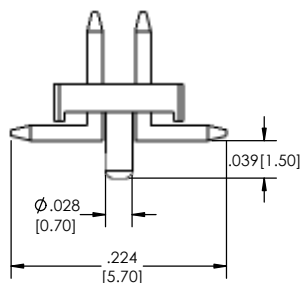

APPLICATION

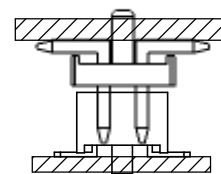

Plating options	
G	-10µ Gold on Contact Area/ Flash on Tail
T	-Matte Tin all Over
GT	-10µ Gold on Contact Area/ Matte Tin on Tail
H	-30µ Gold on Contact Area/ Matte Tin on Tail
F	-Gold Flash over Entire Pin
FT	- Gold Flash on Contact Area/ Matte Tin on Tail

Pin Options	
Post Height	
.065	1.65mm 02
.075	1.91mm 04
.120	3.05mm 06

Specifications:
Current Rating: 1.0 Ampere
Insulation Resistance: 1000M Ohms Min.
Dielectric Withstanding: 300V AC
Contact Resistance: 20M Ohms Max.
Operation Temperature: -40°C to +105°C
Max. Process Temperature
Peak: 260°C up to 10 secs.
Process: 230°C up to 60 secs.
Wave: 260°C up to 6 secs.
Reflow: 260°C up to 10 secs.
Manual Solder: 350°C up to 5 secs.

Materials:
Contact Material: Phosphor Bronze
Insulator Material: Nylon 6T
Plating: Au or Sn over 50µ" (1.27) Ni
Tails may be clipped to achieve specific dimensions.

Products cut to specific sizes are uncancellable/ nonreturnable.
Parts are subject to change without notice.

UNLESS OTHERWISE SPECIFIED:		NAME		DATE
DIMENSIONS ARE IN INCHES		DRAWN	EOW	08/29/16
TOLERANCES:		CHECKED	GWE	08/29/16
ONE DECIMALS ±.100		ENG APPR.		
TWO DECIMAL ±.010		MFG APPR.		
THREE DECIMAL ±.005		ADDRESS:		
FOUR DECIMAL ±.002		2533 Centennial Blvd.		
NEXT ASSY		Jeffersonville, IN 47130		
USED ON		Phone: 812-670-4174		
APPLICATION		Fax: 812-670-4175		
DO NOT SCALE DRAWING		E-Mail: mle@mlelectronics.com		
INTERPRET GEOMETRIC TOLERANCING PER:		TITLE: LTSHSM-5-V SERIES		REV
MATERIAL:		SIZE		G
FINISH:		C		
SCALE 12:1		DWG. NO.		
		SHEET 1 OF 1		

PROPRIETARY AND CONFIDENTIAL
THE INFORMATION CONTAINED IN THIS DRAWING IS THE SOLE PROPERTY OF Major League Electronics. ANY REPRODUCTION IN PART OR AS A WHOLE WITHOUT THE WRITTEN PERMISSION OF Major League Electronics IS PROHIBITED.

