



How To Share EZVIZ Devices with Friends and Family.

EZVIZ mini Wi-Fi Camera and security systems enables you capture those moments you never want to lose. However if you want to view the same device from two different devices at the same time, you can achieve that via two methods;

- The same device can be viewed using the same login credentials, this means when you give your friend, family member your username and password you can actually view the same device in that account at the same time.
- The second method is by sharing your device with your friend. This means, you can give your friends and family privileges to view your device without owning the device. This can be achieved using our advanced setup platform **From the Web Portal** Follow the steps below to share your device;

1. **Log into your EZVIZ account from the web and go to the support page by clicking on the link below**
<https://www.ezvizlife.com/>
2. **Click on EZVIZ cloud sign-in tab on the far right corner**

3. **Sign into your account by entering your username and password**
4. **On the top right corner of the page click on system management**
5. **Click on the friend management tab on the left corner of the screen and click on Add friends**

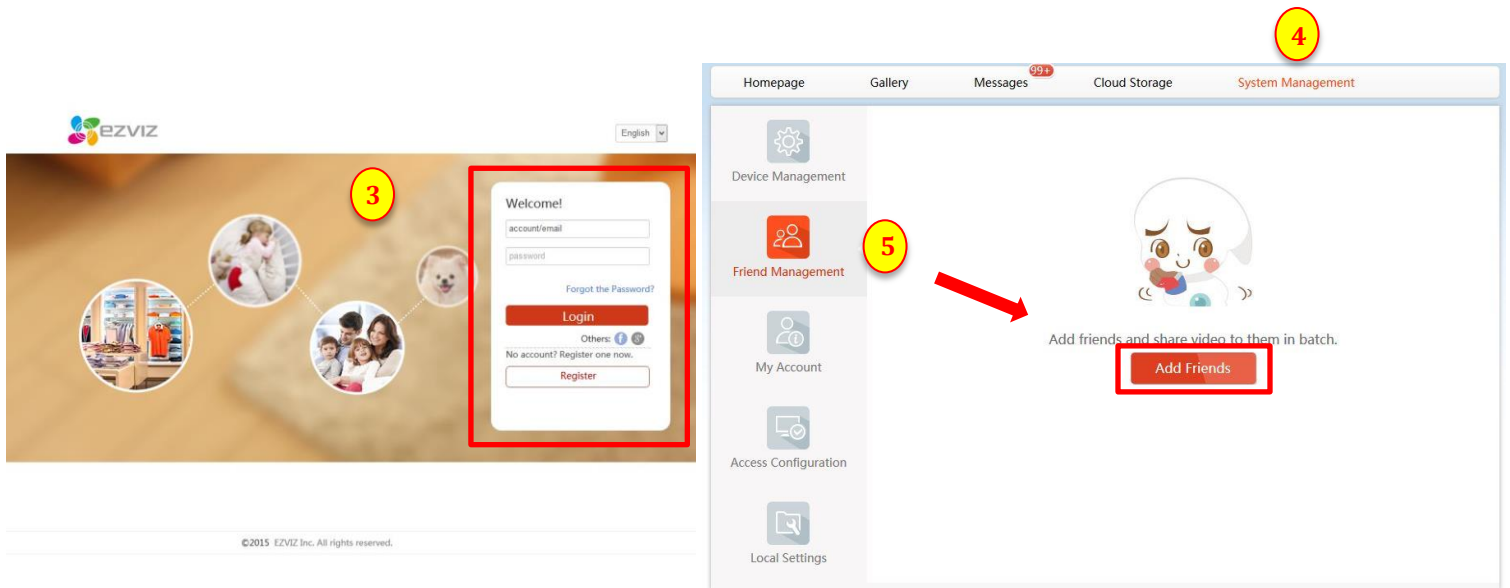

6. **Enter your friends email/phone number associated with EZVIZ account, a brief remark and assign the device that you will like to allow that user to view**
(Note – You can only share your video with a friend that has an EZVIZ account). Live view is enabled by default, but you can choose to allow the user view the playback and receive alarm notification messages.
7. **Once you finish assigning the device and granting the privileges, scroll to the bottom and click on the save icon.**

techsupportus | App download | Help | English

Homepage Gallery Messages **99+** Cloud Storage System Management

Management > Friends List > Add Friends



Email Address:
 Mobile Phone Number:
Remark:
 My Remark:
Share video:

X4_157_01
The video encryption is enabled. Your friends are required to input the encryption password before they can view the video.

Video Sharing Schedule: 00:00 ~ 00:00 (Next Day) Everyday [Edit](#)

Permission:
 Live Video Playback Alarm

Mini(529690743)BFFKEM
The video encryption is enabled. Your friends are required to input the encryption password before they can view the video.

Mini(529690744)
The video encryption is enabled. Your friends are required to input the encryption password before they can view the video.

Mini(529690750)
The video encryption is enabled. Your friends are required to input the encryption password before they can view the video.

Save Cancel

6

7

The user will receive the sharing invitation in his account, once the invitation is accepted the user can view the device as well as the original owner of the device.