

Woodsmith® PLANS

Shop Drawings

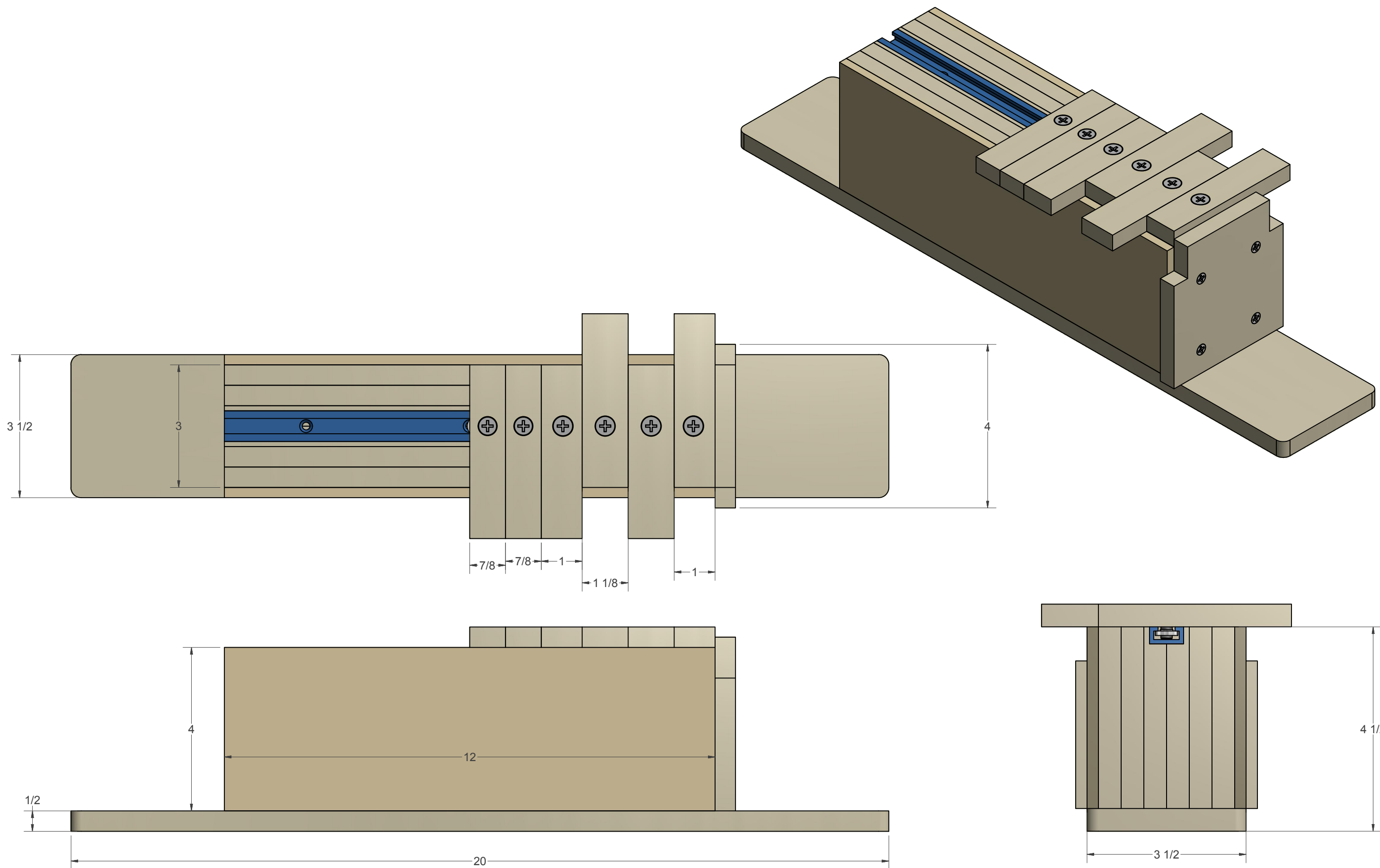

Finger Joint Jig



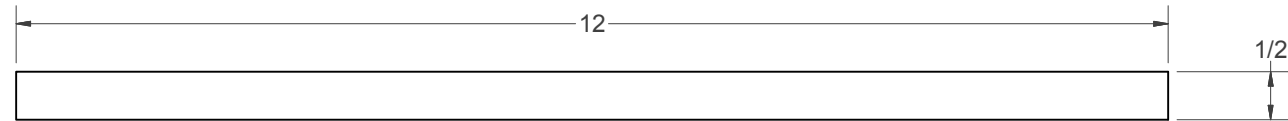

(A) - MAIN BLOCKS
(NEED 6)

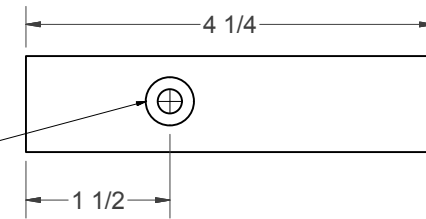
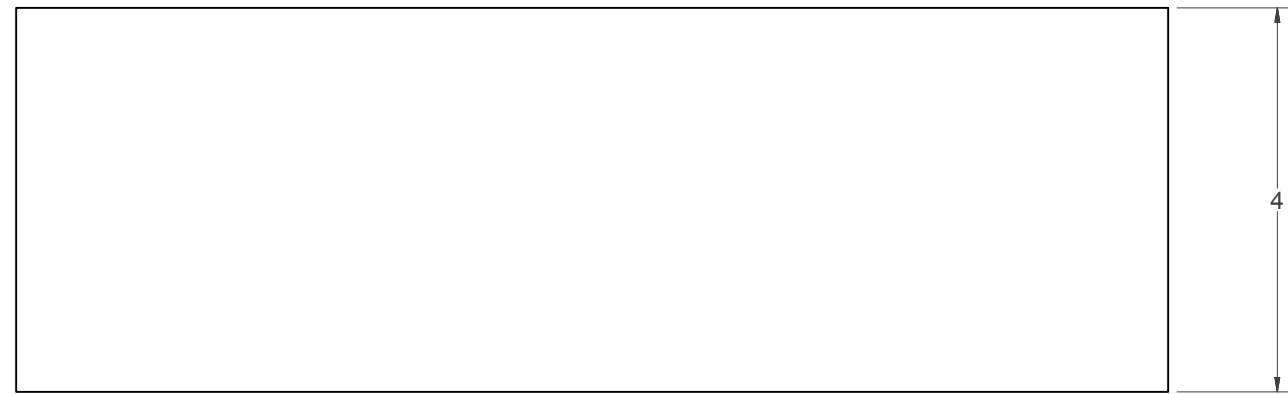

SIZE HOLE FOR CAP SCREW

NEED SETS OF (4) FINGERS IN 1/2", 5/8", 3/4", 1", AND 1-1/8" WIDTHS.

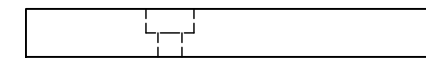

THICKNESS MAY NEED TO CHANGE TO ACCOMODATE CAP SCREW LENGTH.

(E, F, G) - FINGERS

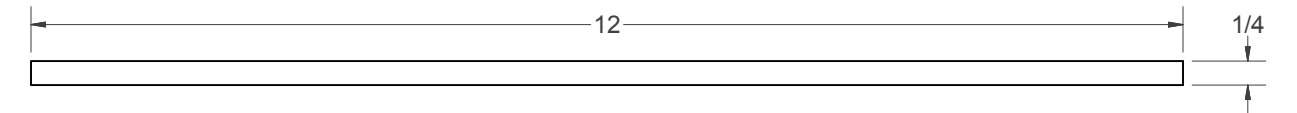

(D) - BACKER PLATE
(NEED 2)

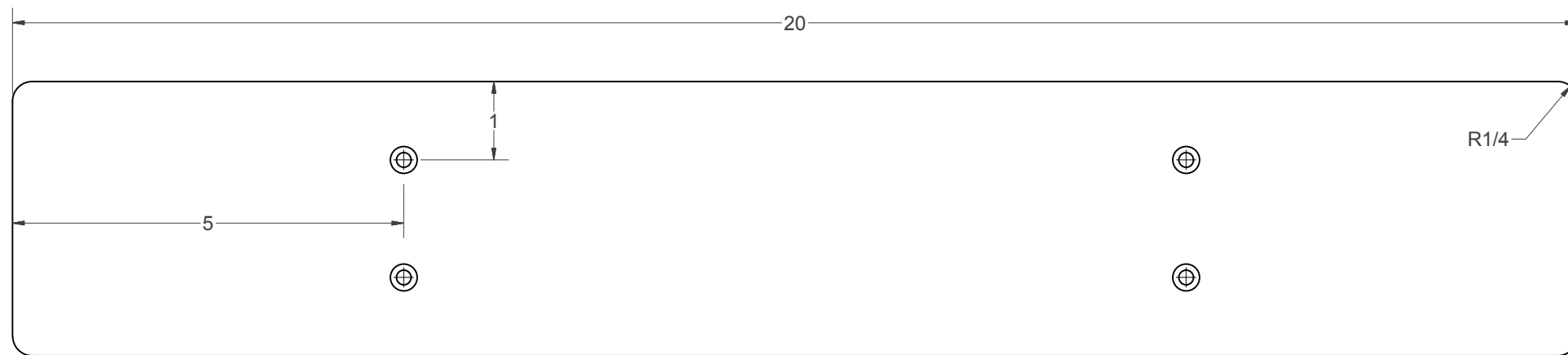
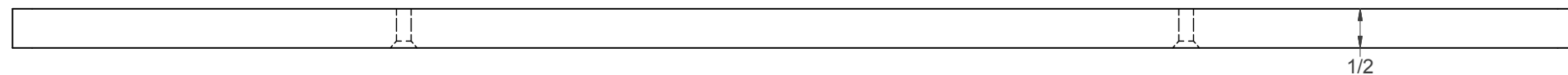
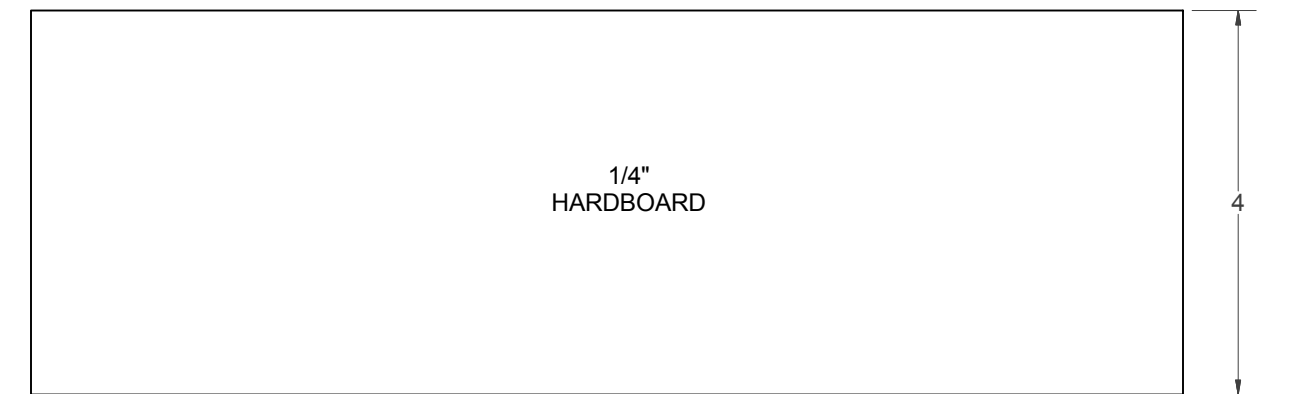

(B) - BASE

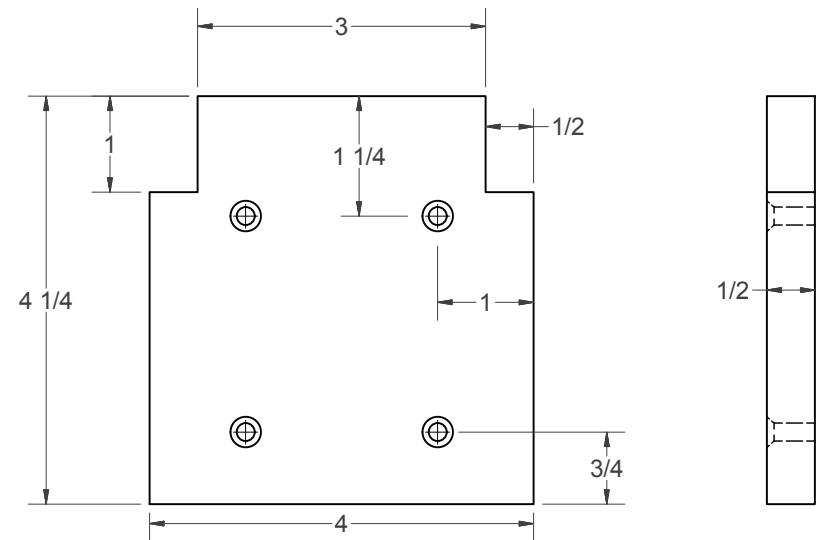

(C) - END STOP
(NEED 2)