

37 ST EDMUNDS DRIVE, TORONTO

KELLY FULTON

Sales Representative

ROYAL LEPAGE REAL ESTATE SERVICES LTD.,
JOHNSTON & DANIEL DIVISION, BROKERAGE

416.489.2121

cell: 416.520.9655

web: kellyfulton.ca

e mail: kelly@kellyfulton.ca

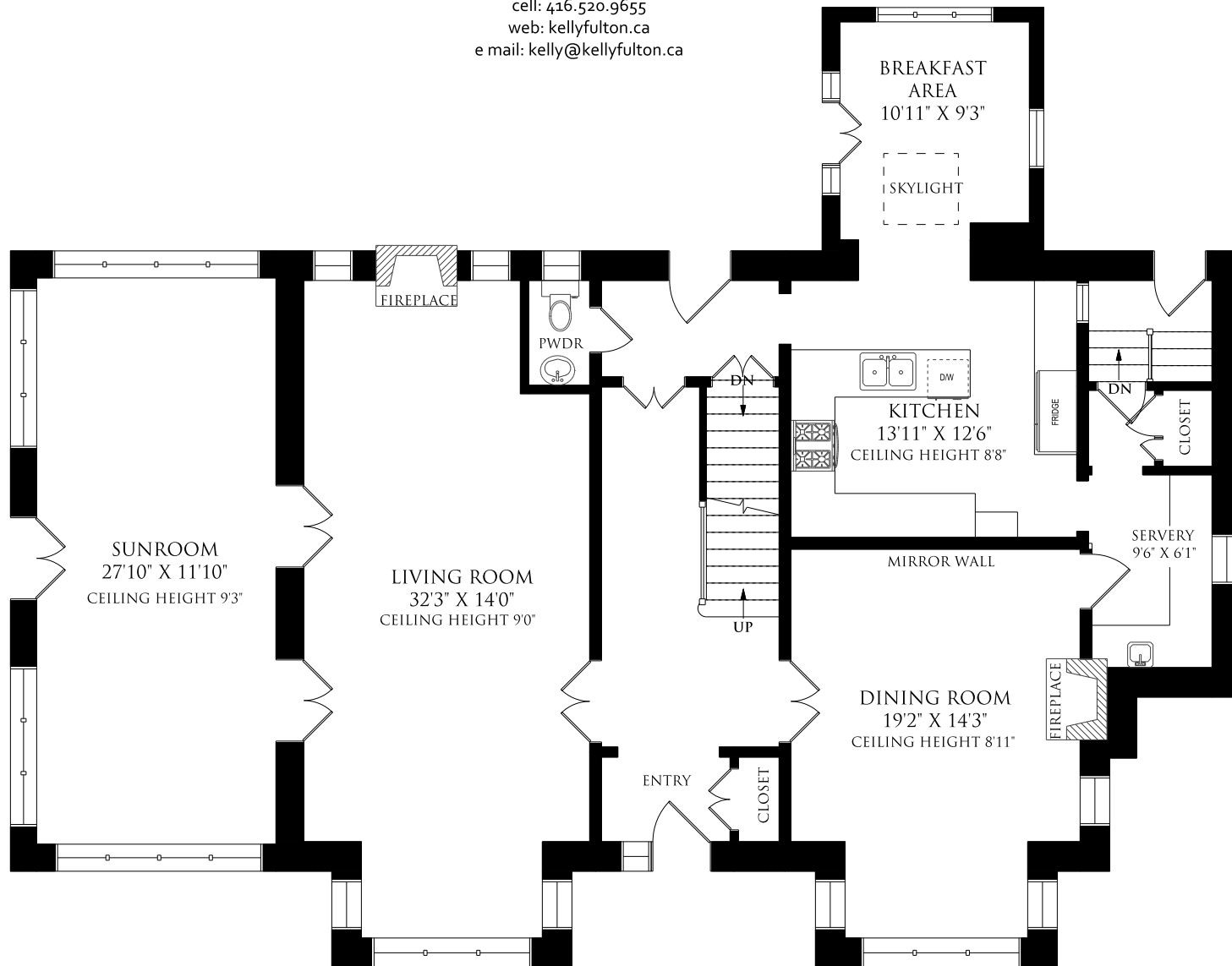

MAIN FLOOR
2047 SQUARE FEET

October 25, 2016

Note: Although measurements and area believed to be accurate they should be considered approximate. This drawing was prepared by Plans4U for the sole benefit and use by the client. No third party may rely on this drawing without the receipt of reliance letter from Plans4U