

525 BALLIOL STREET UNIT #1, TORONTO

KELLY FULTON SALES REPRESENTATIVE

ROYAL LEPAGE REAL ESTATE SERVICES LTD.,
JOHNSTON & DANIEL DIVISION, BROKERAGE
(416) - 489 2121
cell 416.520.9655
web kellyfulton.ca
e mail kelly@kellyfulton.ca

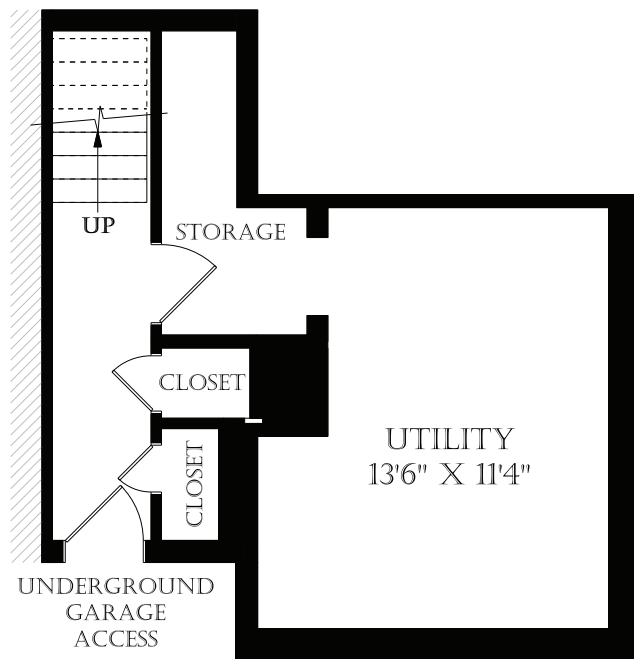

LOWER LEVEL 305 SQUARE FEET

AREA CALCULATED TO THE INSIDE FACE OF DEMISING WALLS
AND TO THE OUTSIDE FACE OF EXTERIOR WALLS

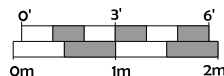

August 18, 2013

Note: Although measurements and area believed to be accurate they should be considered approximate. This drawing was prepared by Plans4U for the sole benefit and use by the client. No third party may rely on this drawing without the receipt of reliance letter from Plans4U