



KINGSLEY AVENUE, GU15

**KIER CHARLES**

SURREY • BERKSHIRE • HANTS

## KINGSLEY AVENUE, GU15

VIEW WITH KIER CHARLES SURREY.

A substantial family home having been updated and well maintained throughout.

Positioned in a highly sought after location offering 3,296 sqft offering easy reach to Camberley town centre, highly sought after Schools and close proximity to major road, rail links to London.

The property boasts a grand entrance hall with stylish tiling and doors to all rooms. The living room measures 20ft and benefits from a French Marble fireplace, dining room, study, WC, utility and kitchen/breakfast room.

To the first floor there is a galleried landing leading to all rooms. The master bedroom benefits an ensuite, guest bedroom with ensuite, a further three bedrooms and family bathroom.

Outside to the front the property is enclosed via electric gates and offers ample parking for several vehicles, access to a double garage. The rear garden receives excellent privacy and is of a sunny aspect.

To fully appreciate the space, location and condition a personal tour with Kier Charles is highly recommended.

- **FIVE BEDROOMS**
- **THREE BATHROOMS**
- **THREE RECEPTION ROOMS**
- **GATED APPROACH**
- **STUNNING LOCATON NEAR TOWN**
- **PRIVATE REAR GARDEN**
- **SPACIOUS THROUGHOUT**
- **EXCELLENT CONDITION**

### PROPERTY INFORMATION

Postcode	<b>GU15 2NB</b>
Tenure	<b>Freehold</b>
Price	<b>£1,300,000</b>
Viewing	<b>By appointment with Kier Charles</b>





# Kingsley Avenue, Camberley, GU15

Approximate External Area = 3296 sq ft / 306.1 sq m (includes garage)

For identification only - Not to scale

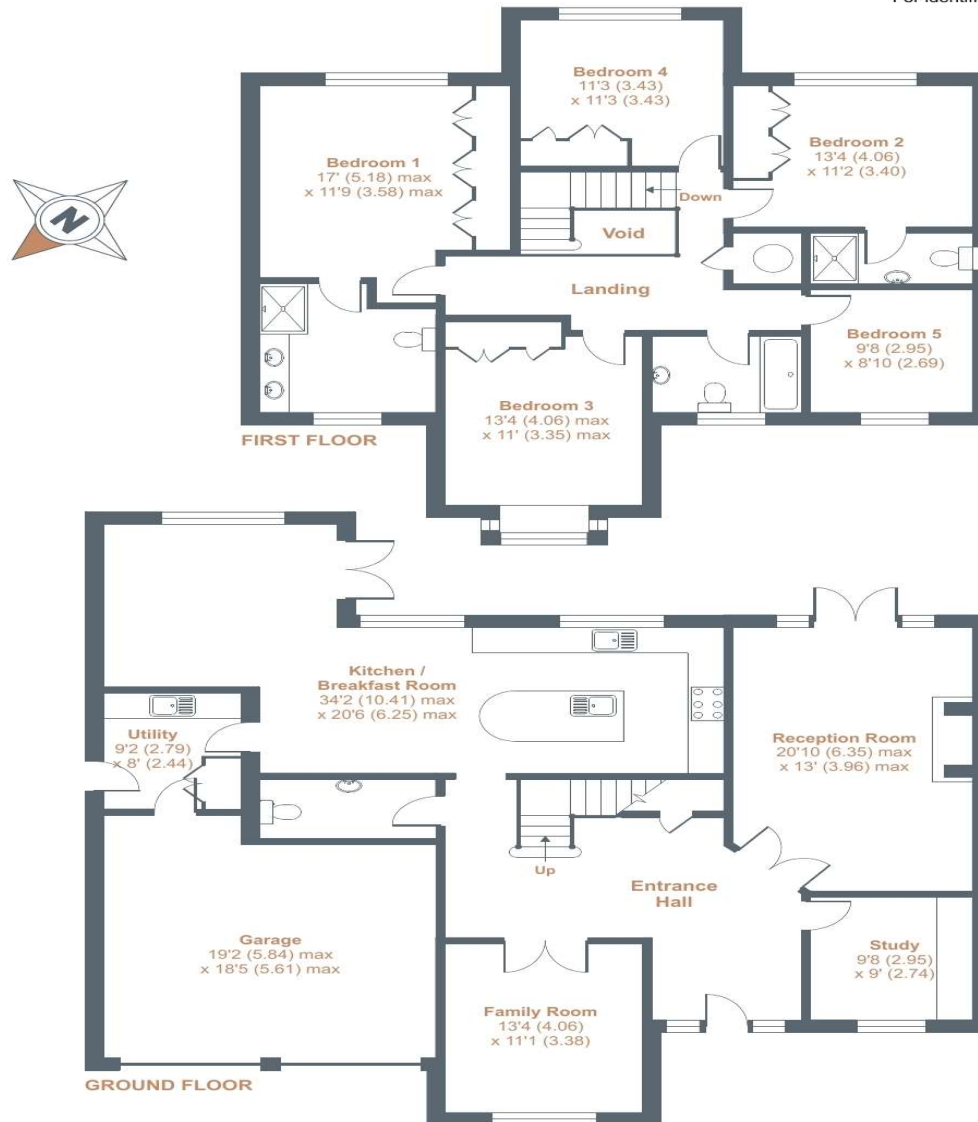

Floor plan produced in accordance with RICS Property Measurement Standards incorporating International Property Measurement Standards (IPMS2 Residential). © nchecon 2023. Produced for Kier Charles Property Services Limited. REF: 938123

KIER CHARLES  
PROPERTY SERVICES

## CONTACT INFORMATION:

Surrey: 01276 949789

Berkshire: 01344 513789

Hampshire: 01252 213789

[info@kiercharles.co.uk](mailto:info@kiercharles.co.uk)

# KIER CHARLES

SURREY • BERKSHIRE • HANTS