



KELSTON HOUSE, LONDON ROAD, GU15

**KIER CHARLES**

SURREY • BERKSHIRE • HANTS

## KELSTON HOUSE, LONDON ROAD, GU15

VIEW SAFELY WITH KIER.

A refurbished family home offering easy reach to Camberley town centre and sought after Schools.

This wonderful property enjoys four bedrooms and two bathrooms to the first floor with excellent potential for a loft conversion STPP.

To the ground floor there are three reception rooms, refitted kitchen and many character features with replaced fireplaces and bay windows.

There is further potential to convert the garage STPP to make a large kitchen family room.

The landscaped rear garden offers excellent privacy and is of a sunny aspect with a large patio, lawned area and side access.

An additional garage and ample parking to the front is available.

To fully appreciate the space and location a viewing is highly recommended.

- **FOUR BEDROOMS**
- **TWO BATHROOMS**
- **THREE RECEPTION ROOMS**
- **SINGLE AND DOUBLE GARAGE**
- **CLOSE TO TOWN CENTRE**
- **CHARACTER FEATURES**
- **GOOD SIZE PRIVATE GARDEN**

### PROPERTY INFORMATION

Postcode | **GU15 3TW**  
Tenure | **Freehold**  
Price | **£799,950**  
Viewing | **By appointment with Kier Charles**





# London Road, Camberley, GU15

Approximate Area = 2156 sq ft / 200.2 sq m (includes garage)

For identification only - Not to scale

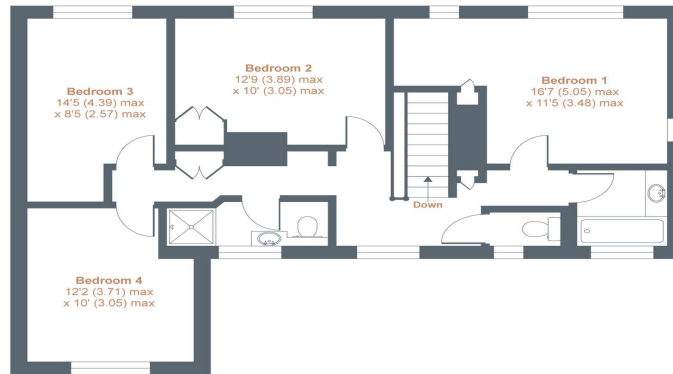

FIRST FLOOR

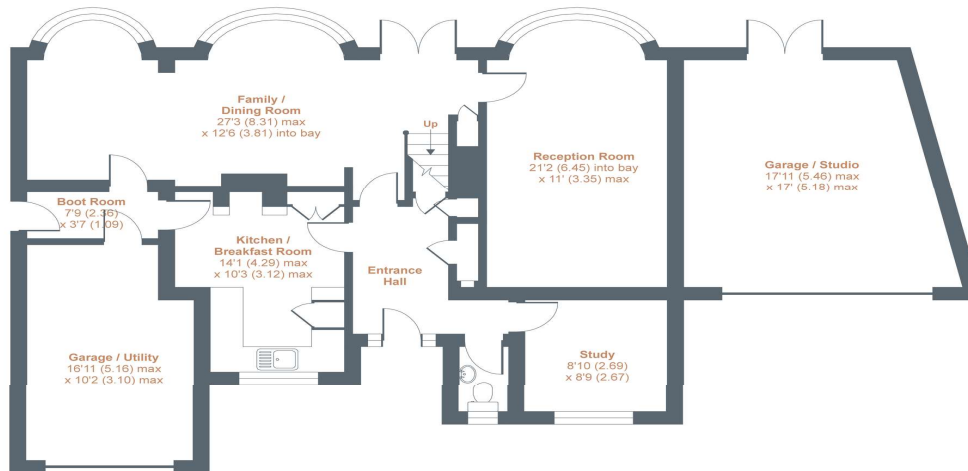

GROUND FLOOR



Floor plan produced in accordance with RICS Property Measurement Standards incorporating International Property Measurement Standards (IPMS2 Residential). © nichecom 2021. Produced for Kier Charles Property Services Limited. REF: 710627



## CONTACT INFORMATION:

Surrey: 01276 949789

Berkshire: 01344 513789

Hampshire: 01252 213789

[info@kiercharles.co.uk](mailto:info@kiercharles.co.uk)

# KIER CHARLES

SURREY • BERKSHIRE • HANTS