



POTTEN CLOSE, GU15

KIER CHARLES

SURREY • BERKSHIRE • HANTS

POTTEN CLOSE, GU15

SOLD stc WITH KIER.

NO CHAIN!

A HIGH SPECIFICATION FAMILY HOME!

A stunning transformation! The current owners have added a beautiful outbuilding creating a wonderful reception for alfresco dining an additional patio and enclosed to create a haven from the convenience of town centre living.

A magnificent property built by Cala Homes to a high specification. The owners have meticulously updated including a landscaped rear garden & outbuilding.

Positioned within the heart of Camberley offering easy reach to the town centre, theatre, A30 and M3 a short drive away.

There are a range of excellent Schools nearby and within walking distance to the railway station.

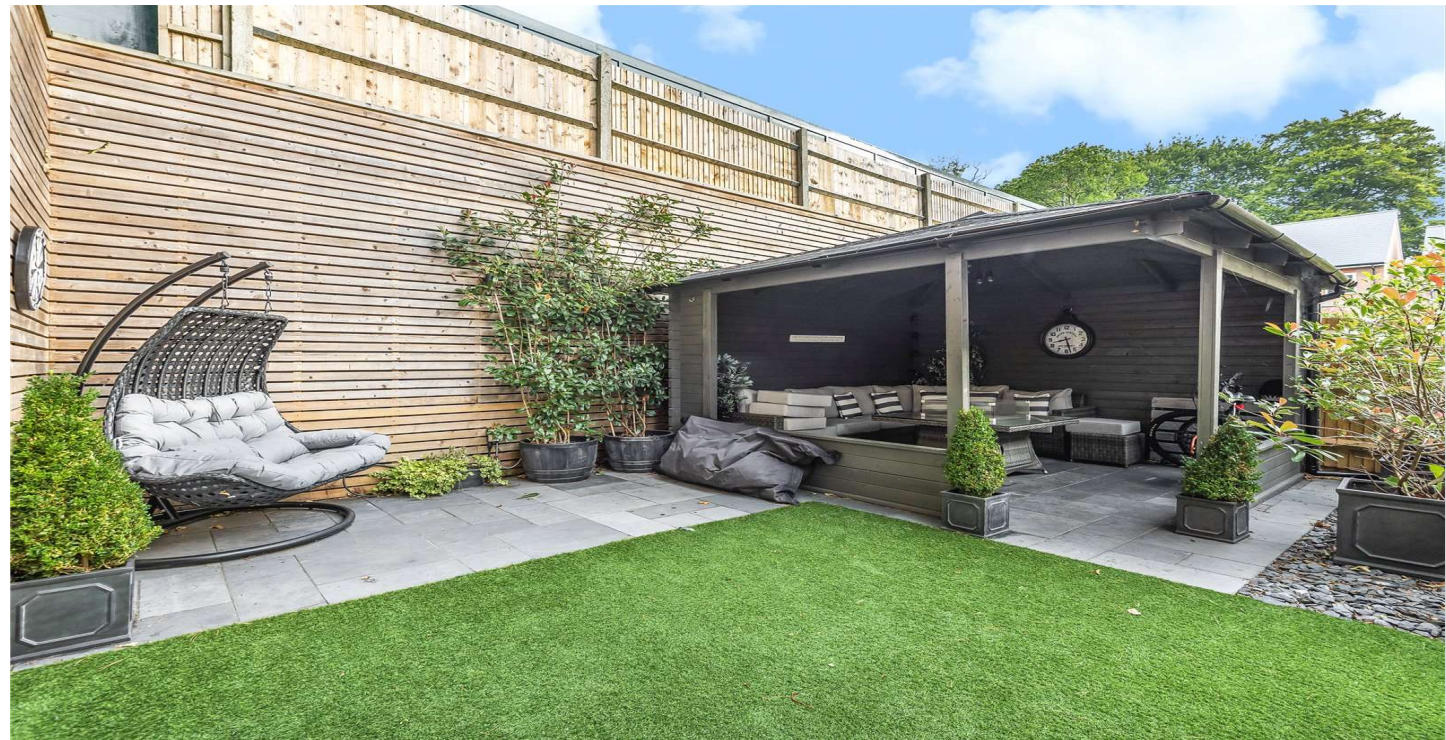

- **FOUR BEDROOMS**
- **STUNNING MASTER SUITE**
- **THREE BATHROOMS**
- **QUIET CUL DE SAC**
- **TOWN CENTRE LOCATION**
- **CALA HOME**
- **REFURBISHED AND MANICURED**

PROPERTY INFORMATION

Postcode | **GU15 3DE**
Tenure | **Freehold approximately 0years**
Price | **£585,000**
Viewing | **By appointment with Kier Charles**





Potten Close, Camberley, GU15

Approximate Area = 1545 sq ft / 143.5 sq m

Limited Use Area(s) = 41 sq ft / 3.8 sq m

Total = 1586 sq ft / 147.3 sq m

For identification only - Not to scale

Denotes restricted head height

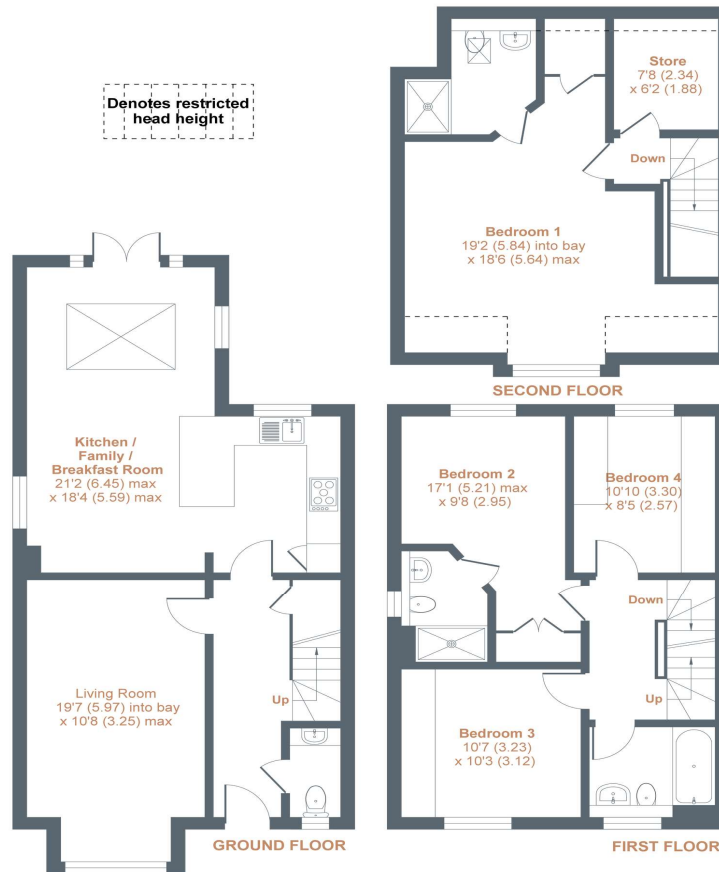

Floor plan produced in accordance with RICS Property Measurement Standards incorporating International Property Measurement Standards (IPMS2 Residential). © n|checon 2020. Produced for Kier Charles Property Services Limited. REF: 642596

KIER CHARLES
PROPERTY SERVICES

CONTACT INFORMATION:

Surrey: 01276 949789

Berkshire: 01344 513789

Hampshire: 01252 213789

info@kiercharles.co.uk

KIER CHARLES

SURREY • BERKSHIRE • HANTS