



HEATHCOTE, BRENTMOOR ROAD, GU24

KIER CHARLES

SURREY • BERKSHIRE • HANTS

HEATHCOTE, BRENTMOOR ROAD, GU24

VIEW SAFELY WITH MICHAEL.

LAUNCH DAY ON 20TH AUGUST BETWEEN 10:30 - 14:00 STRICTLY BY APPOINTMENT ONLY.

A FABULOUS BUNGALOW WITH A LARGE CORNER PLOT AND OFFERING NO ONWARD CHAIN COMPLICATIONS.

Positioned in Westend village within walking distance to the highly sort after Gordons School and across the road from the Brentmoor heath offering scenic woodland walks.

The property offers three double bedrooms with the master bedroom having large built-in wardrobes. Living room with French doors out to the garden, Kitchen, and family bathroom.

The large garden offers the opportunity to extended STP without compromising on the rear garden space or lose parking spaces for several cars.

A personal tour with Michael is highly recommended to avoid disappointment on which will no doubt be a popular home on the launch day.

- **WALKING DISTANCE TO GORDONS SCHOOL.**
- **3 DOUBLE BEDROOMS**
- **LOTS OF POTENTIAL stp**
- **NEEDS MODERNISATION**
- **GARAGE AND DRIVEWAY PARKING FOR SEVERAL CARS**

PROPERTY INFORMATION

Postcode | **GU24 9QG**
Tenure | **Freehold**
Price | **£525,000**
Viewing | **By appointment with Kier Charles**



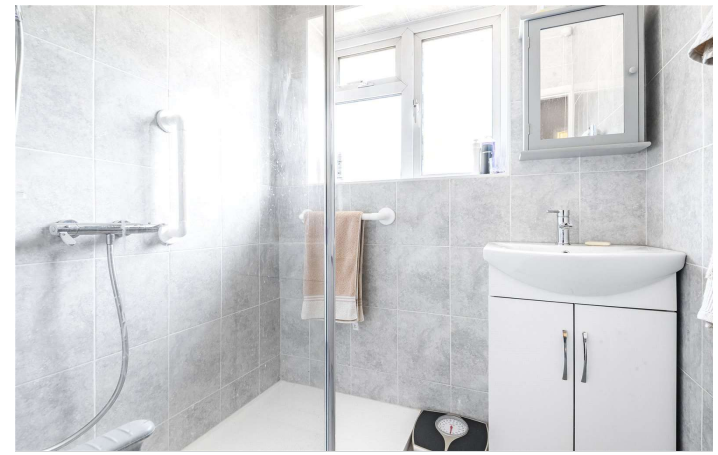

Brentmoor Road, West End, Woking, GU24

Approximate External Area = 1002 sq ft / 93 sq m (includes garage)

For identification only - Not to scale

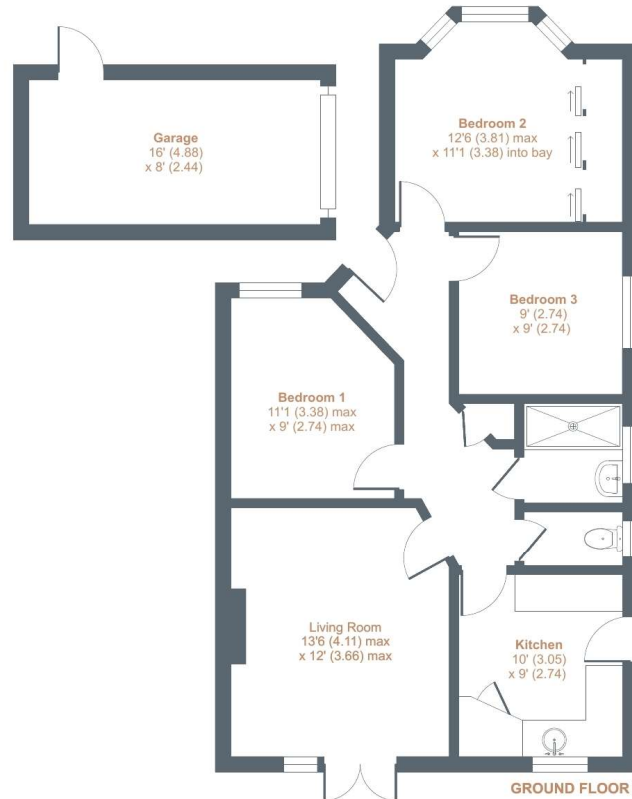

Floor plan produced in accordance with RICS Property Measurement Standards incorporating International Property Measurement Standards (IPMS2 Residential). © nrichcom 2022. Produced for Kier Charles Property Services Limited. REF: 881040

KIER CHARLES

CONTACT INFORMATION:

Surrey: 01276 949789

Berkshire: 01344 513789

Hampshire: 01252 213789

info@kiercharles.co.uk

KIER CHARLES

SURREY • BERKSHIRE • HANTS