



3 Bedrooms



1 Bathroom



2 Reception Rooms



On Street Parking



50ft Approx.



EPC Band D

Council Tax  
Band: D £2,155.11 (2024/2025)

Local Authority  
St Albans City & District  
Council

 **ashtons**  
for life's great moves



Upper Heath Road, St. Albans, AL1 4DN  
Guide Price £525,000 Freehold

## Upper Heath Road, St. Albans

A three bedroom period home located in the popular Bernards Heath area of St Albans within easy reach of highly regarded schooling, the mainline station and St Albans city centre.

🏡 Charming Period Home Arranged Over Two Floors

🏡 Quiet Cul-de-Sac Location

🏡 Two Reception Rooms

🏡 Three Bedrooms

🏡 Private Rear Garden Approximately 50ft

🏡 Close to St Albans City Centre & Mainline Station

### Description

This charming home forms part of a short terrace of properties and is set at the end of a quiet cul-de-sac.

The front door opens into a front reception room currently being used as a music room and, in turn, this leads into a spacious reception room, open-plan to the kitchen. The bright kitchen is to the rear with views of the garden and is well planned with a good range of wall and base units and integrated appliances. The property has three bedrooms, the largest of which is to the front of the property and has excellent fitted storage provision. The second bedroom is also a good size and leads through to the smaller single bedroom, both overlooking the garden. All three bedrooms are serviced by a smart family bathroom which can be found on the ground floor. Externally the property has a delightful rear garden with a paved patio area close to the house and a good size lawn. There is a useful timber shed at the rear useful for storage and there is direct access available from the street running along the side of the house.

### Location

Upper Heath Road is a quiet cul-de-sac set on the northern edge of St Albans City centre close to well-regarded schools, Bernard's Heath, the city centre and mainline railway station. The address proves popular with young families and commuters and the road consists of similar properties of character.





**Important Information**

These particulars do not constitute an offer or contract in whole or part. The statements contained herein are made without responsibility on the part of Ashtons or the vendors and they cannot be relied upon as representatives of fact. In respect of floor plans, these are for illustrative purposes only. The measurement and position of each element is approximate and must be viewed as such. Intending purchasers should therefore satisfy themselves by inspection or otherwise as to their correctness. The vendors do not make or give, and neither Ashtons nor any person in their employment has any authority to make or give, any representation or warranty whatsoever in relation to this property. We offer a wide range of services through third party providers including solicitors, surveyors, removal firms, mortgage providers and EPC suppliers. We receive additional payments for administering suppliers quoting software and making referrals. You are not under any obligations to use these services and it is your discretion whether you choose to deal with these parties or your own preferred supplier. You should be aware the average payment we received in 2021 equated to £48.36 per referral.

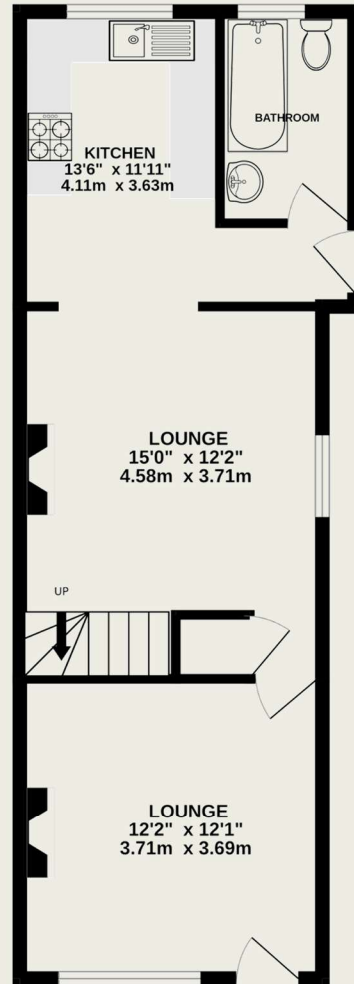

GROUND FLOOR  
483 sq.ft. (44.9 sq.m.) approx.

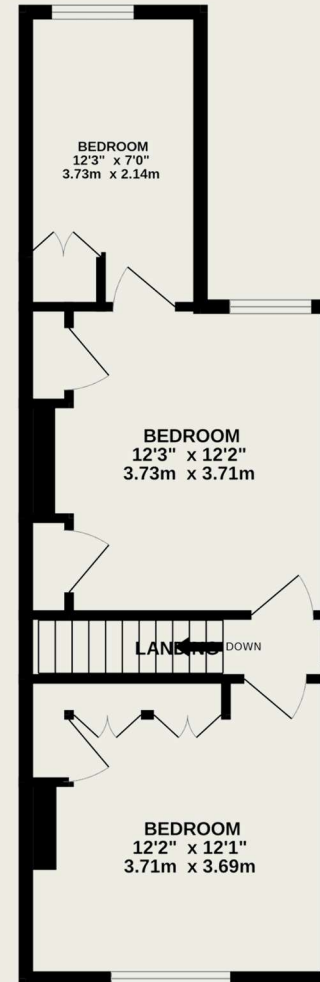

1ST FLOOR  
407 sq.ft. (37.8 sq.m.) approx.

TOTAL FLOOR AREA : 883sq.ft. (82.0 sq.m.) approx.

This floor plan is for illustrative purposes only. The measurement and position of each element is approximate and must be viewed as such