



PEEL CLOSE, SL4

**KIER CHARLES**

SURREY • BERKSHIRE • HANTS

## PEEL CLOSE, SL4

A spacious family home offering excellent potential to extend and re-model STPP and consent.

Overlooking a large green this home is offered to the market with a large rear garden, garage in nearby block and driveway parking.

Many homes in the near vicinity have transformed and extended these properties which combined with the highly sought after location can only be described as a great investment for buy to let or family home to invest in.

The property is situated the outskirts of Windsor, with access to the Great Park close by, making it an ideal location for families and those who enjoy walking or biking in the outdoors. Windsor has a wide range of shops and restaurants as well as the Castle, Great Park, Racecourse and Legoland. Nearby train stations include Windsor & Eton Central and Windsor & Eton Riverside, giving easy access to London Paddington (via Slough - Elizabeth line) and London Waterloo. The area is served by a number of well-regarded schools including The Royal School, Oakfield, Queen Anne First School, St Edwards Middle School, Trevelyan, Upton House, Eton, Windsor Boys and Windsor Girls. Windsor is also convenient for the M4, M25, M3 and Heathrow Airport.

To fully appreciate the location, space and excellent potential a personal tour with Kier Charles is highly recommended.

- **THREE BEDROOMS**
- **TWO RECEPTION ROOMS**
- **REFITTED BATHROOM**
- **EXCELLENT POTENTIAL TO EXTEND STPP**
- **LARGE GARDEN**
- **OVERLOOKING LARGE GREEN**
- **CLOSE TO WINDSOR**
- **SOUGHT AFTER SCHOOLS NEARBY**
- **IDEAL COMMUTER LINKS**

### PROPERTY INFORMATION

Postcode	SL4 3NW
Tenure	Freehold
Price	£575,000
Viewing	By appointment with Kier Charles





# Peel Close, Windsor, SL4

Approximate Internal Area = 1166 sq ft / 108.3 sq m

Garage = 134 sq ft / 12.4 sq m

Total = 1300 sq ft / 120.7 sq m

For identification only - Not to scale



FIRST FLOOR

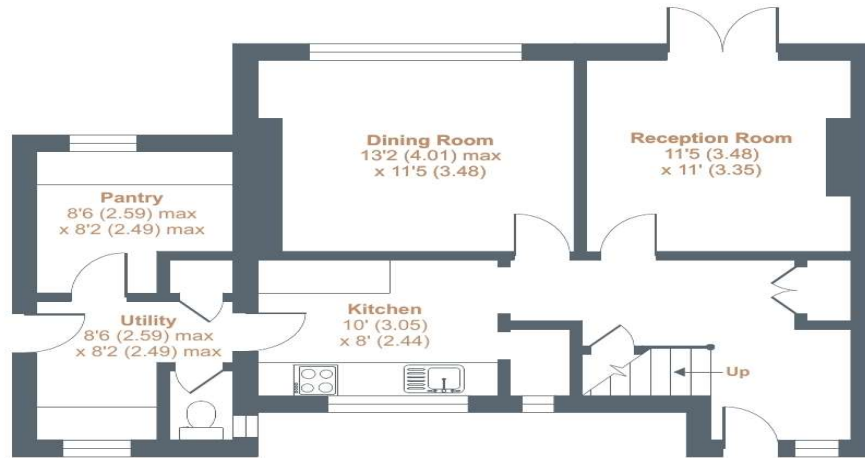

GROUND FLOOR

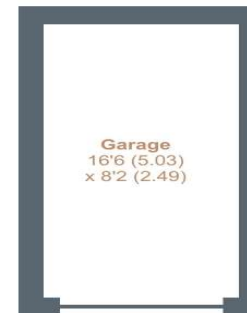

## CONTACT INFORMATION:

Surrey: 01276 949789

Berkshire: 01344 513789

Hampshire: 01252 213789

[info@kiercharles.co.uk](mailto:info@kiercharles.co.uk)



Floor plan produced in accordance with RICS Property Measurement Standards incorporating International Property Measurement Standards (IPMS2 Residential). © n\cheom 2024. Produced for Kier Charles Property Services Limited. REF: 1178517

**KIER CHARLES**  
SURREY • BERKSHIRE • HANTS • LONDON

# KIER CHARLES

SURREY • BERKSHIRE • HANTS