



FINCHLEY CENTRAL OFFICE
365 Regents Park Road, Finchley Central, London N3 1DE
T: 020 8346 0102 E: N3@martyngerrard.co.uk
www.martyngerrard.co.uk

“50 years of fulfilling dreams”

Lichfield Grove

£1,200 pcm

London, N3

-  1 BEDROOMS
-  1 RECEPTIONS
-  FITTED KITCHEN
-  GROUND FLOOR



A one double bedroom ground floor converted maisonette. The apartment comprises of a spacious living room, a fitted kitchen, one double bedroom and a modern family bathroom. The apartment is also well positioned for Finchley Central Underground Station (Northern Line). Sorry, no pets. Available now on a part furnished basis.



Martyn Gerrard is the trading name for the North London Network Ltd. Registered in England No. 2441809.

Registered Office: 35 Ballards Lane, London N3 1XW. Company Secretary: B. Peters

Directors: M. Gerrard MRICS FNAEA, S.E. Gerrard MNAEA MARLA, D.H. Smith FNAEA MARLA, W.A. Price MNAEA, S.M. Gerrard MA MRICS FICBA, G.Tsuman MARLA

Regulated by RICS

Lichfield Grove

- Ground floor
- 1 Double bedroom
- 1 Reception room
- Modern bathroom
- Fully fitted kitchen
- Part-furnished

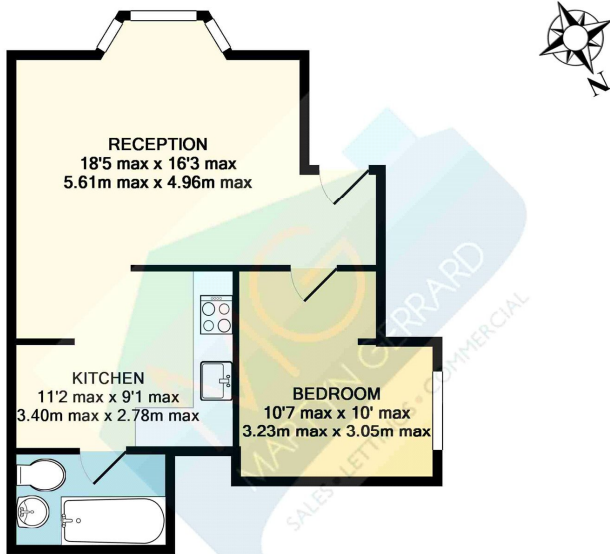

TOTAL APPROX. FLOOR AREA 422 SQ.FT. (39.2 SQ.M.)
 GIA measurements are approximate. Not to scale. Illustrative purposes only

Energy Efficiency Rating		Current	Potential
Very energy efficient - lower running costs			
(92-)	A		
(81-91)	B		
(69-80)	C		
(55-68)	D	68	69
(39-54)	E		
(21-38)	F		
(1-20)	G		
Not energy efficient - higher running costs			
England, Scotland & Wales		EU Directive 2002/91/EC	

A copy of the full EPC is available on request.

