



CHEYLESMORE DRIVE, GU16

**KIER CHARLES**

SURREY • BERKSHIRE • HANTS

## CHEYLESMORE DRIVE, GU16

VIEW SAFELY WITH KIER.

A SUPERB FAMILY HOME HAVING BEEN EXTENDED NOW OFFERING 2005 SQ FT OVER TWO FLOORS.

The property has a wonderful open plan 25ft reception room, dining room following onto the kitchen and utility. A further 16ft family room, WC and large storage room.

To the first floor there is a 13.9ft master bedroom with ensuite, a further three bedrooms and family bathroom.

A private rear garden and large front drive benefit this family home.

Positioned in a quiet cul de sac on the ever popular Cheylesmore Drive development offering excellent School catchment, close to shop and playing parks and woodland.

To fully appreciate the space, location and condition a personal tour with Kier is highly recommended.

- **FOUR BEDROOMS**
- **TWO BATHROOMS**
- **25ft OPEN PLAN RECEPTION**
- **KITCHEN & DINING ROOM**
- **FAMILY ROOM**
- **PRIVATE GARDEN**
- **QUIET CUL DE SAC LOCATION**

### PROPERTY INFORMATION

Postcode | **GU16 9BL**  
Tenure | **Freehold**  
Price | **£700,000**  
Viewing | **By appointment with Kier Charles**





# Frimley, Camberley, GU16

Approximate External Area = 2005 sq ft / 186.3 sq m

For identification only - Not to scale



FIRST FLOOR

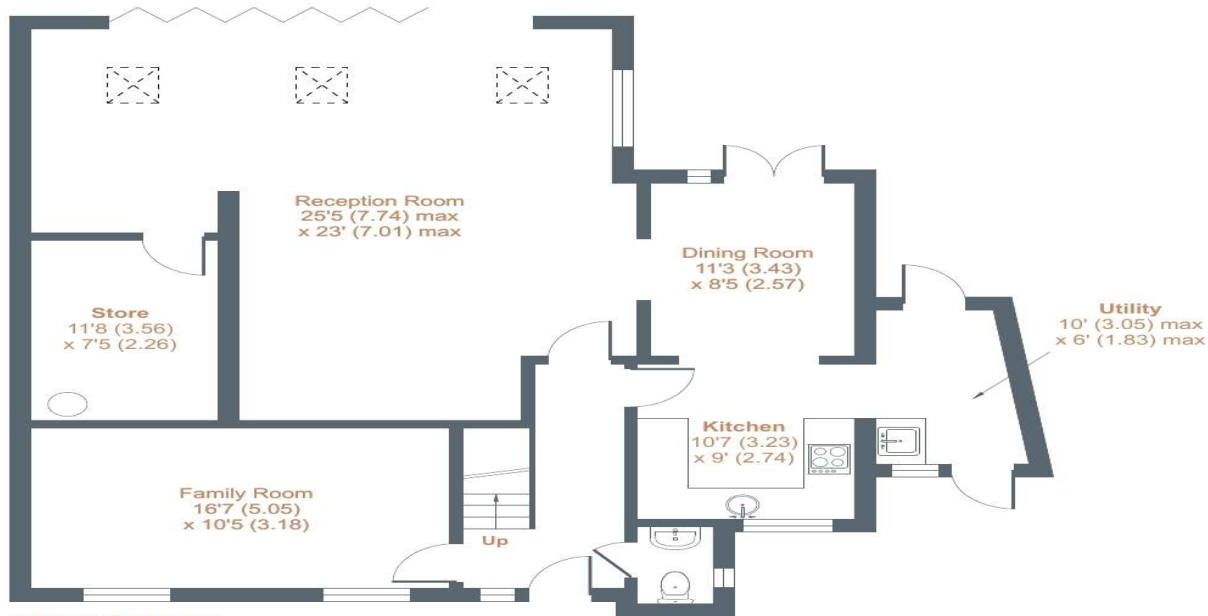

GROUND FLOOR



Certified  
Property  
Measurer

Floor plan produced in accordance with RICS Property Measurement Standards incorporating International Property Measurement Standards (IPMS2 Residential). © ncheom 2022. Produced for Kier Charles Property Services Limited. REF: 806320

KIER CHARLES  
PROPERTY SERVICES

## CONTACT INFORMATION:

Surrey: 01276 949789

Berkshire: 01344 513789

Hampshire: 01252 213789

[info@kiercharles.co.uk](mailto:info@kiercharles.co.uk)

# KIER CHARLES

SURREY • BERKSHIRE • HANTS