





**Parkway Gardens
Welwyn Garden City
AL8 6JW**

£1,450 pcm Part furnished/unfurnished

 3 bedrooms

 1 bathroom

 2 reception rooms

 Garden

 Garage

 EPC D

Charges, in addition to the monthly rental, may apply. Full details are available on request.



 01707 383133  lettingswgc@ashtons.co.uk

29 Wigmores North, Welwyn Garden City, Hertfordshire, AL8 6PG

ashtons connect: a digital marketing solution - unique to your property

A delightful neo Georgian Garden City style semi detached residence with south facing garden in private cul-de-sac, available 23rd November 2015. Landlord will not allow pets or smokers at the property

The Property

A super semi detached home located in this popular West Side location. The property, which is found in excellent decorative order throughout, provides many first class features including dual aspect lounge/diner with feature fireplace, a modern fitted kitchen with quality built-in appliances, ample worktop surfaces and a window overlooking the landscaped rear garden. On the first floor there are three good size bedrooms, a shower room and, for comfort and economy, double glazing and gas to radiator heating are installed. The exterior benefits from a lovely, well-maintained southerly aspected 50ft rear garden with a driveway leading to a single garage at the side of the property. Post Code: AL8 6JW Council Tax: Band E (£1,830.63 April 2015 - March 2016)

Location

Parkway Gardens is located in the heart of the very popular 'West Side' of the Garden City. The location is within easy level walking distance to local shopping amenities, such as Sainsburys, John Lewis, Debenhams and a mainline rail station (London Kings Cross 25 minutes). Ideal for the commuter or those looking to be close to popular schooling and all major road links.



ashtons connect:
The latest sales technology on your doorstep. **Do call us to find out more**

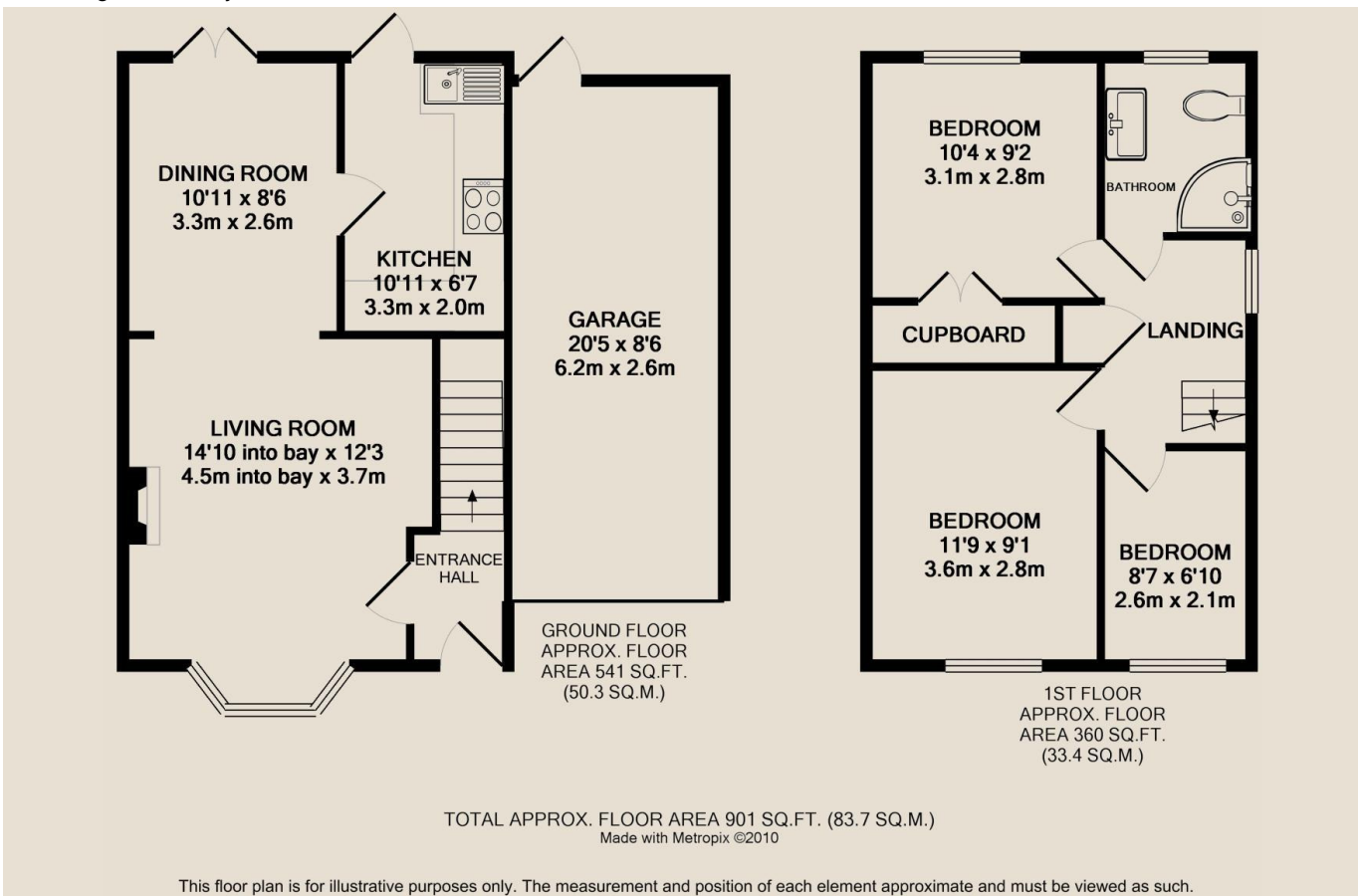

This floor plan is for illustrative purposes only. The measurement and position of each element approximate and must be viewed as such.

These particulars do not constitute an offer or contract in whole or part. The statements contained herein are made without responsibility on the part of Ashtons or the vendors and they cannot be relied upon as representatives of fact. In respect of floor plans, these are for illustrative purposes only. The measurement and position of each element is approximate and must be viewed as such. Intending purchasers should therefore satisfy themselves by inspection or otherwise as to their correctness. The vendors do not make or give, and neither Ashtons nor any person in their employment has any authority to make or give, any representation or warranty whatsoever in relation to this property. Please visit ashtons.co.uk where the regulatory EPC information is stored on the individual property page. Alternatively, an electronic or paper version is available from our office.