

gth



QUEENS ROAD, BRIDGWATER, SOMERSET

64 Queens Road, Bridgwater, Somerset, TA6 6EQ

Bridgwater 1 mile; Taunton 11 miles; Bristol 38 miles

A well-presented terraced property, with off street parking. Situated in a convenient location south of Bridgwater Town.

Freehold Guide Price £185,000

DESCRIPTION

A well-presented terraced property located within a popular residential development, convenient for local amenities and schools and providing good access to the town centre and motorway network.

The accommodation is arranged over two floors and briefly comprises; an entrance door opens into the hallway with a door into the lounge and stairs leading to the first floor. The lounge is a light and spacious room with a fireplace and an



opening through into the kitchen. The kitchen area has been fitted with a good range of modern units and has space for oven/hob, fridge/freezer and washing machine/tumble dryer. Within the kitchen you will also find a useful understairs storage area and door leading into the downstairs bathroom, which is fitted with a bath and shower over. A rear door from the kitchen provides access to the garden.

On the first floor there are three generous size bedrooms, the main and second bedroom being double rooms and benefitting from built-in storage.

Outside the garden to the rear is low maintenance, with a patio area for seating and the remainder laid to lawn. There is also double gates at the bottom of the garden providing access

and a useful outside store room. The front is laid to gravel and provides off street parking for 2/3 cars.

This property would make an ideal investment opportunity or first time home, an early viewing is strongly advised.

SITUATION

The property can be found on the southern side of Bridgwater, within walking distance of the town centre. There are various local shops within close walking distance together with Primary and Secondary Schooling. Bridgwater offers all day to day amenities together with 2 Junctions of the M5 Motorway and a train station.

64 Queens Road

GROUND FLOOR
369 sq.ft. (34.3 sq.m.) approx.

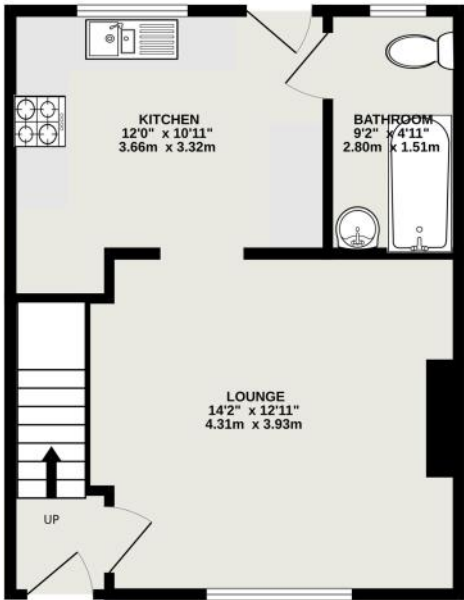

1ST FLOOR
374 sq.ft. (34.8 sq.m.) approx.

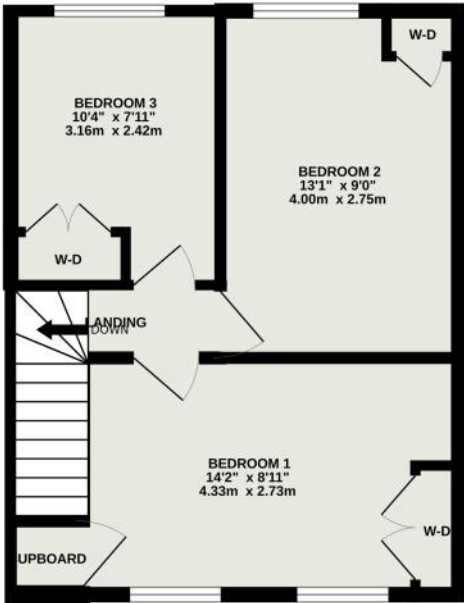

TOTAL FLOOR AREA : 744 sq.ft. (69.1 sq.m.) approx.
Measurements are approximate. Not to scale. Illustrative purposes only
Made with Metropix ©2023

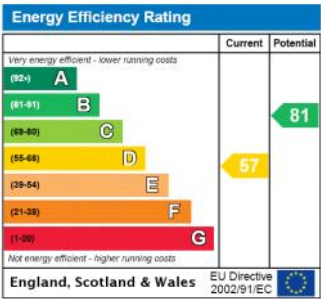

IMPORTANT NOTICE

For clarification we wish to inform any prospective purchasers that we have prepared these sales particulars as a general guide. They must not be relied upon as statements of fact. We have not carried out a detailed survey, nor tested the services, heating systems, appliances and specific fittings. Room sizes should not be relied upon for carpets and furnishings. If there are points which are of particular importance to you please contact the office prior to viewing the property.

DIRECTIONS

From the town centre head towards Taunton, proceeding along Taunton Road, turning right into Parkstone Avenue. When you reach the roundabout continue straight leading onto Queens Road and the property will be found a short distance along on the right hand side, identified by a 'For Sale' board.

WHAT3WORDS

deed.poker.fishery

SERVICES

Mains water, electric & drainage. Electric heating.

LOCAL AUTHORITY

Somerset County Council, Tax Band A.

GREENSLADE TAYLOR HUNT
www.gth.net



gth



Viewing

Strictly by appointment with the agents

Greenslade Taylor Hunt.

31-33 High Street, Bridgwater

Somerset, TA6 3BG

Email: residential.bridgwater@gth.net

Tel: 01278 425555 | Ref: BRI230292

