



SHIRNALL MEADOW, GU34

KIER CHARLES
SURREY • BERKSHIRE • HANTS

SHIRNALL MEADOW, GU34

VIEW WITH KIER CHARLES HAMPSHIRE.

A stunning three bedroom semi detached family home, offering a glorious rear garden backing onto open fields in the highly sought after village of Lower Farringdon.

The property benefits from being tucked away in a quiet cul de sac and has parking and single garage.

There is a kitchen/breakfast room, wc, L shaped living/dining room overlooking the rear garden.

To the first floor there are three bedrooms and family bathroom.

The main feature to this home is the extensive rear garden which offers peace and tranquillity and access gate to further open fields.

To fully appreciate the space, location and condition to this home a personal tour with Kier Charles is highly recommended.

- **THREE BEDROOMS**
- **L SHAPED RECEPTION**
- **STUNNING LOCATION**
- **TUCKED AWAY**
- **PARKING AND GARAGE**
- **LARGE REAR GARDEN**
- **BACKING ONTO OPEN FIELDS**

PROPERTY INFORMATION

Postcode | **GU34 3DY**
Tenure | **Freehold**
Price | **£450,000**
Viewing | **By appointment with Kier Charles**





Shirnall Meadow, Lower Farringdon, Alton, GU34

Approximate Internal Area = 807 sq ft / 74.9 sq m

Limited Use Area(s) = 44 sq ft / 4 sq m

Garage = 222 sq ft / 20.6 sq m

Total = 1074 sq ft / 99.5 sq m

For identification only - Not to scale

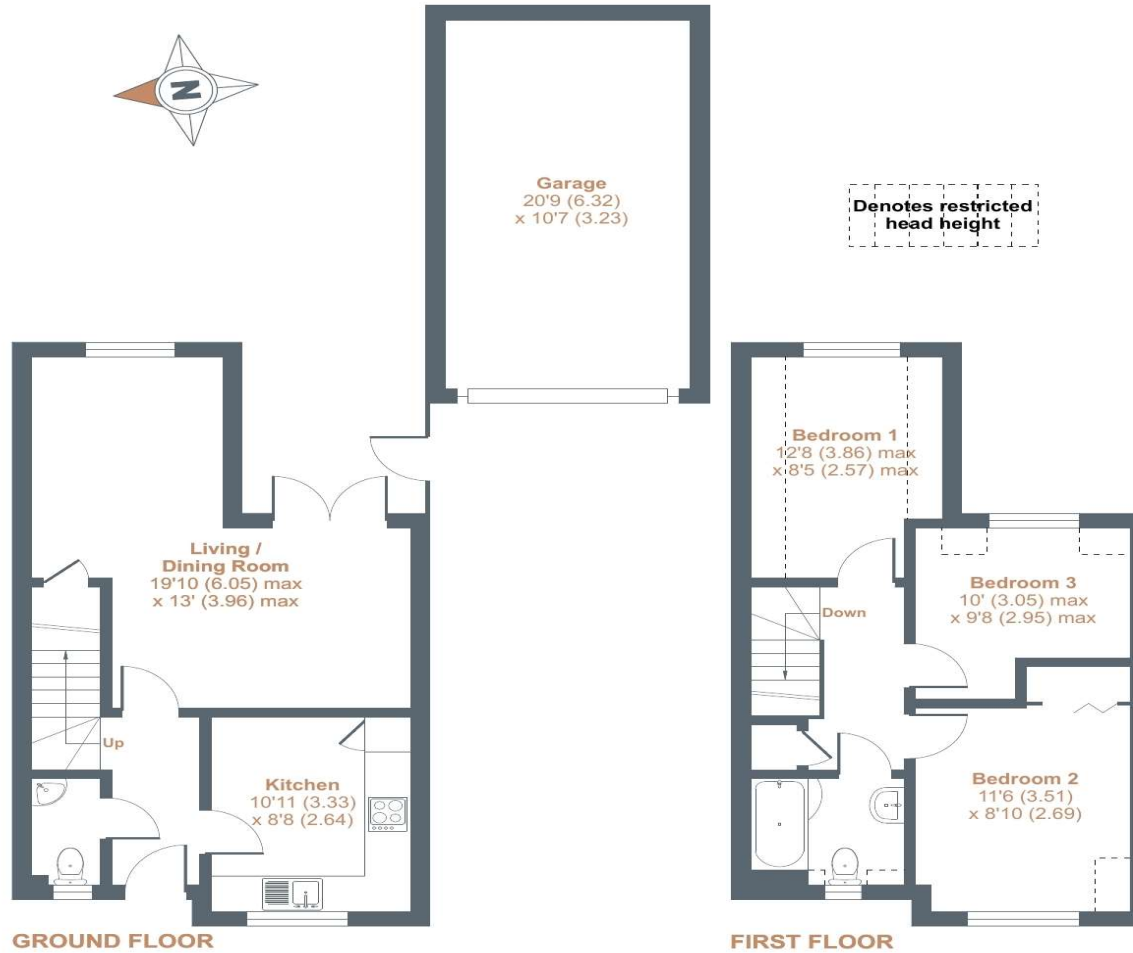

CONTACT INFORMATION:

Surrey: 01276 949789

Berkshire: 01344 513789

Hampshire: 01252 213789

info@kiercharles.co.uk



Floor plan produced in accordance with RICS Property Measurement Standards incorporating International Property Measurement Standards (IPMS2 Residential). © nchecon 2024. Produced for Kier Charles Property Services Limited. REF: 1080454

KIER CHARLES
PROPERTY SERVICES

KIER CHARLES

SURREY • BERKSHIRE • HANTS