



Mowbray Road, Brondesbury

£325 per week

- 2 Bedrooms
- 1 Reception Room
- 1 Bathroom
- Flat
- 1st Floor
- Outside Space
- 495 Approx Sq ft

A recently redecorated two bedroom first floor apartment located close to the Jubilee line. Benefits include spacious reception room, fully fitted kitchen with modern appliances, one double bedroom with fitted wardrobes and one single bedroom, bathroom with shower attachment and wc, communal gardens, available from 16th November, part furnished.

T 020 7644 2332
F 020 7372 2712
lettings@paramount-properties.co.uk

150 West End Lane
London NW6 1SD

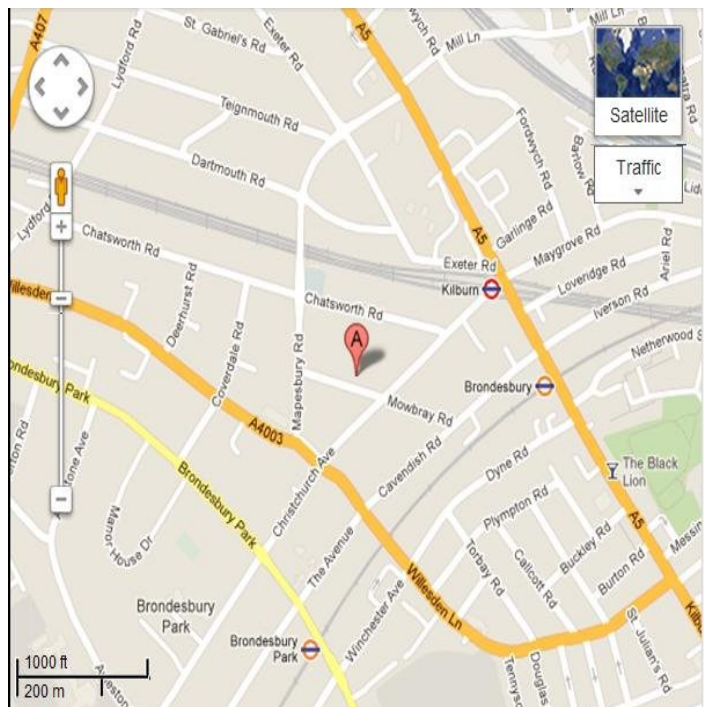

Although these particulars are thought to be materially correct their accuracy cannot be guaranteed and they do not form part of any contract.

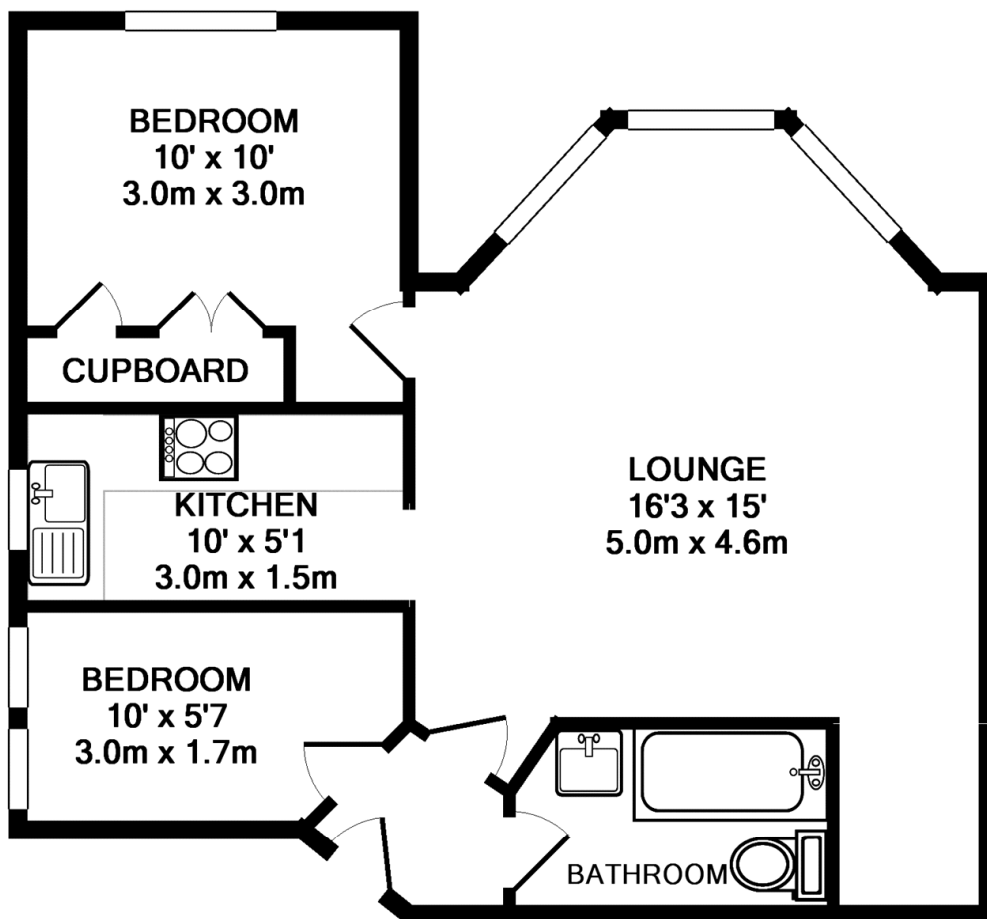

TOTAL APPROX. FLOOR AREA 46.0 SQ.M. (495 SQ.FT.)

Whilst every attempt has been made to ensure the accuracy of the floor plan contained here, measurements of doors, windows, rooms and any other items are approximate and no responsibility is taken for any error, omission, or mis-statement. This plan is for illustrative purposes only and should be used as such by any prospective purchaser. The services, systems and appliances shown have not been tested and no guarantee as to their operability or efficiency can be given
Made with Metropix ©2007

Whilst every attempt has been made to ensure the accuracy of the floor plans contained here, measurements of doors, windows and rooms are approximate and no responsibility is taken for any error, omission or misstatement. These plans are for representation purposes only as defined by RICS Code of Measuring Practice and should be used as such by any prospective purchaser. The services, systems and appliances listed in this specification have not been tested and no guarantee as to their operating ability or their efficiency can be given.

