

12 Ridgefield Gardens, Highcliffe, Dorset,
BH23 4QG

Asking Price **£499,950**



3

Bedrooms



1

Living



1

Bathroom



Y

Parking/Garage



EST
1992

THE PROPERTY PROFESSIONALS
Slades Estate Agents

Slades

Three bedroom bungalow with potential to improve...

THREE BEDROOM DETACHED BUNGALOW WITH SUBSTANTIAL FRONTAGE AND GOOD SIZE REAR GARDEN, IN NEED OF MODERNISATION THROUGHOUT. CLOSE TO THE LOCAL SCHOOL, SHOPS AND BUS ROUTE. OFFERED FOR SALE WITH NO ONWARD CHAIN.

Porch leads to entrance hall, doors to accommodation.

Glass panelled doors lead into a 20ft lounge diner with gas fire place, and further doors into the sunroom.

The kitchen has a range of eye and base level units with cupboards and drawers. Space for range of appliances with a utility room providing additional space.

There are three bedrooms, two of which have built in wardrobes.

The shower room compromises a shower cubicle, WC and wash hand basin. There is an additional separate cloakroom alongside.

Outside

The front is laid to tarmac and provides off road parking for several vehicles. Integral garage with front and rear up and over doors, power and light.

Side gate leads to the rear garden. Space for outbuildings, areas of lawn and patio, and bound by fence panels with a good degree of privacy.

Council tax band E.



KEY POINTS

- Lots of Potential
- Garage and lots of parking
- Good size rear garden
- Three bedrooms
- Sunroom & Utility
- Close to school & shops

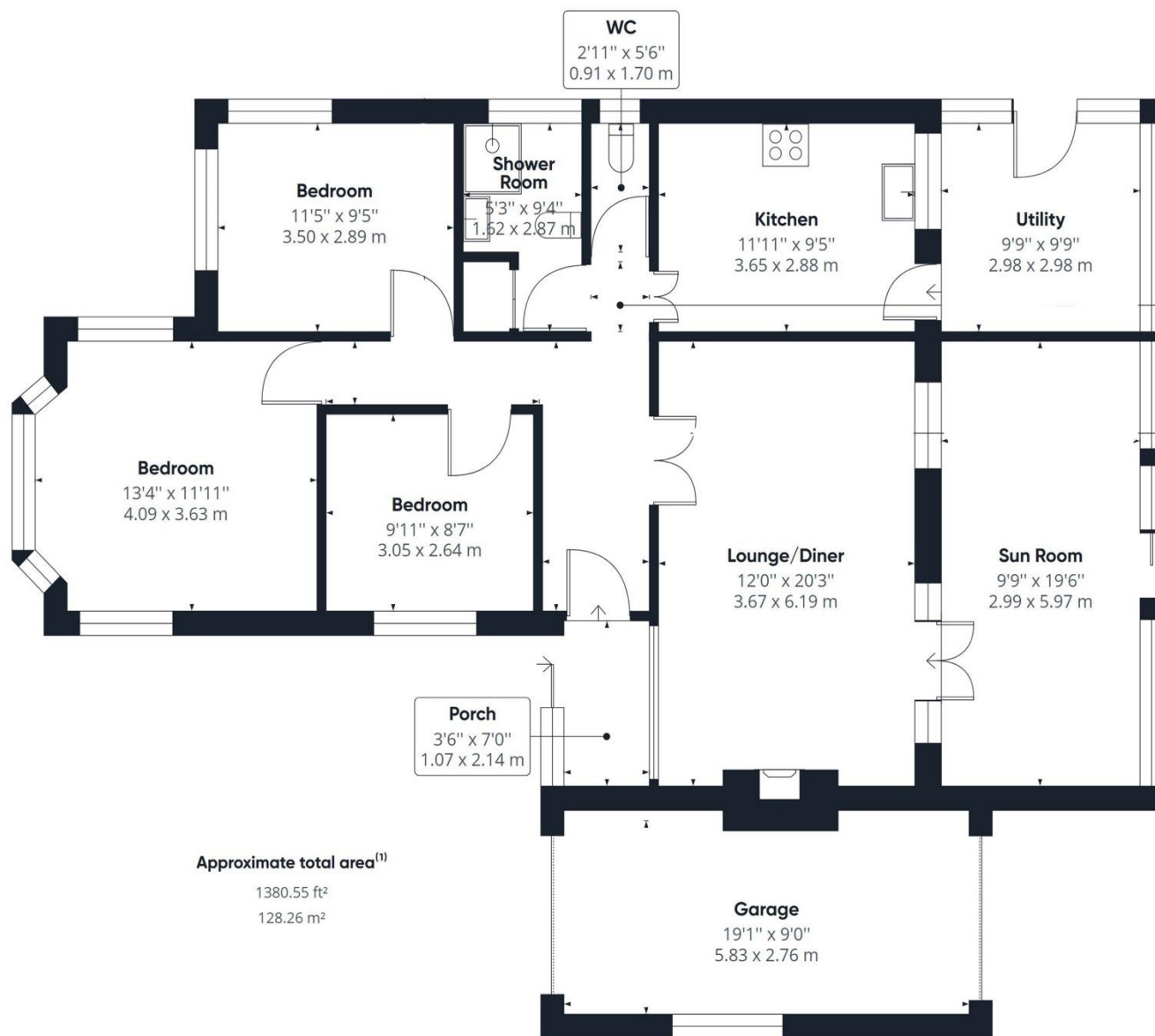

The Consumer Protection from Unfair Trading Regulations 2008 (CPRs). These details are for guidance only and complete accuracy cannot be guaranteed. If there is any point, which is of particular importance, verification should be obtained. They do not constitute a contract or part of a contract. All measurements are approximate. No guarantee can be given with regard to planning permissions or fitness for purpose. No apparatus, equipment, fixture or fitting has been tested. Items shown in photographs are NOT necessarily included. Interested Parties are advised to check availability and make an appointment to view before travelling to see a property.

THE PROPERTY PROFESSIONALS

Christchurch | Southbourne | Highcliffe | Bransgore

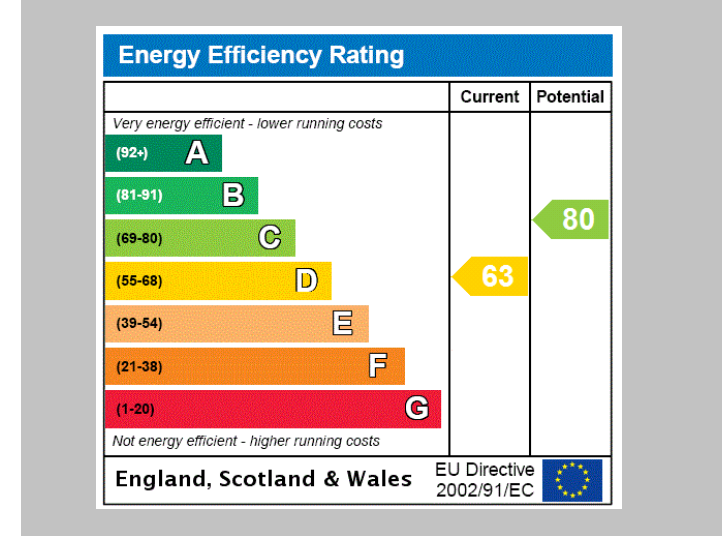

Slades - Highcliffe 356 Lymington Road, Highcliffe, Christchurch, Dorset, BH1
01425 277773 | info@sladeshighcliffe.co.uk
Website www.sladeshomes.co.uk

