



MARTEL CLOSE, GU15

KIER CHARLES

SURREY • BERKSHIRE • HANTS

MARTEL CLOSE, GU15

VIEW WITH KIER CHARLES SURREY.

A WONDERFUL TERRACED HOME POSITIONED IN A QUIET CUL-DE-SAC LOCATION ON THE EVER POPULAR WELLINGTON PARK DEVELOPMENT.

The property boasts two double bedrooms and family bathroom to the first floor.

The ground floor enjoys entrance hall with WC, a modernised kitchen, large living/dining room which overlooks the rear garden.

The rear garden is very private, offering plenty of patio space perfect for al fresco dining. Offering easy reach to local shops, playing fields & the Chobham ridges offering a tranquil place to live.

To fully appreciate the space, location and condition of this home a viewing is highly recommended to avoid disappointment.

- PRIVATE REAR GARDEN
- CUL-DE-SAC
- WELLINGTON PARK
- CLOSE TO WOODLAND
- TWO DOUBLE BEDROOMS
- OVERLOOKING PARK

PROPERTY INFORMATION

Postcode | **GU15 1QS**
Tenure | **Freehold**
Price | **O.I.E.O £335,000**
Viewing | **By appointment with Kier Charles**





Martel Close, Camberley, GU15

Approximate External Area = 788 sq ft / 73.2 sq m

For identification only - Not to scale

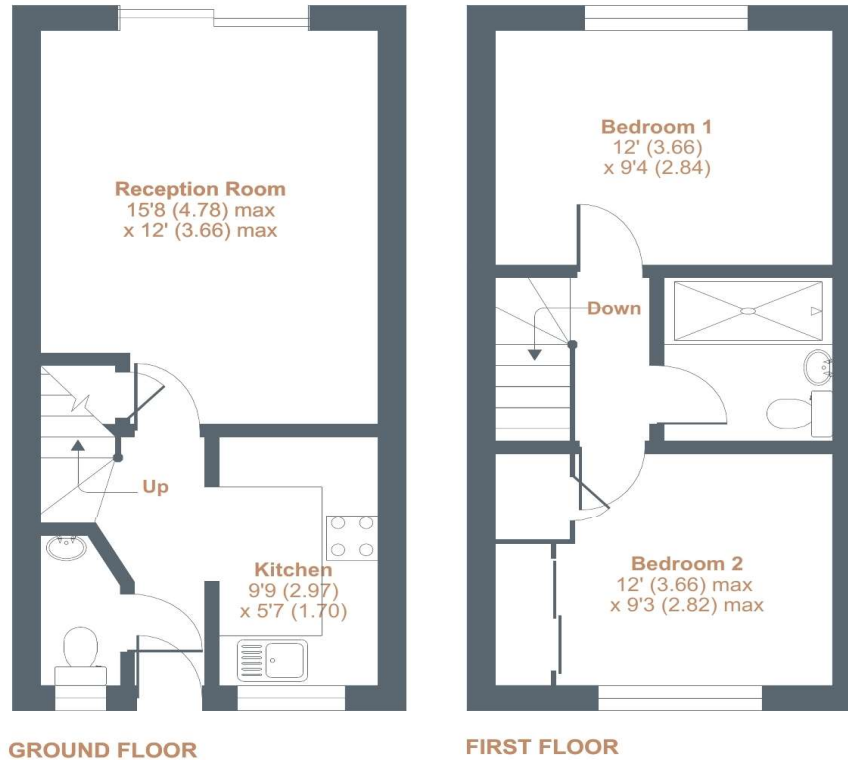

Floor plan produced in accordance with RICS Property Measurement Standards incorporating International Property Measurement Standards (IPMS2 Residential). © nichecom 2022. Produced for Kier Charles Property Services Limited. REF: 832589

KIER CHARLES
PROPERTY SERVICES

CONTACT INFORMATION:

Surrey: 01276 949789

Berkshire: 01344 513789

Hampshire: 01252 213789

info@kiercharles.co.uk

KIER CHARLES

SURREY • BERKSHIRE • HANTS