



MINDEN COURT, GU16

KIER CHARLES

SURREY • BERKSHIRE • HANTS

MINDEN COURT, GU16

SOLD stc SAFELY WITH OLIVER.

A WONDERFUL TERRACED HOME POSITIONED IN THE EVER POPULAR CUL DE SAC MINDEN COURT, DEEPCUT.

Offering easy reach to local shops, playing fields & the Basingstoke canal offering a tranquil place to live.

The property boasts two double bedrooms and family bathroom to the first floor.

The ground floor enjoys entrance hall with WC, a lovely kitchen opening to the living/dining room which overlooks the rear garden.

The rear garden is very private, south facing and low maintenance.

To fully appreciate the space, location and condition of this home a viewing is highly recommended to avoid disappointment.

- **EXCELLENT SCHOOL CATCHMENT**
- **TWO DOUBLE BEDROOMS**
- **PRIVATE REAR GARDEN**
- **ALLOCATED PARKING**
- **QUIET CUL DE SAC LOCATION**
- **CONVENIENT FOR SHOPS**

PROPERTY INFORMATION

Postcode | **GU16 6EE**
Tenure | **Freehold approximately 0years**
Price | **£375,000**
Viewing | **By appointment with Kier Charles**





Minden Court, Deepcut, Camberley, GU16

Approximate External Area = 844 sq ft / 78.4 sq m

For identification only - Not to scale

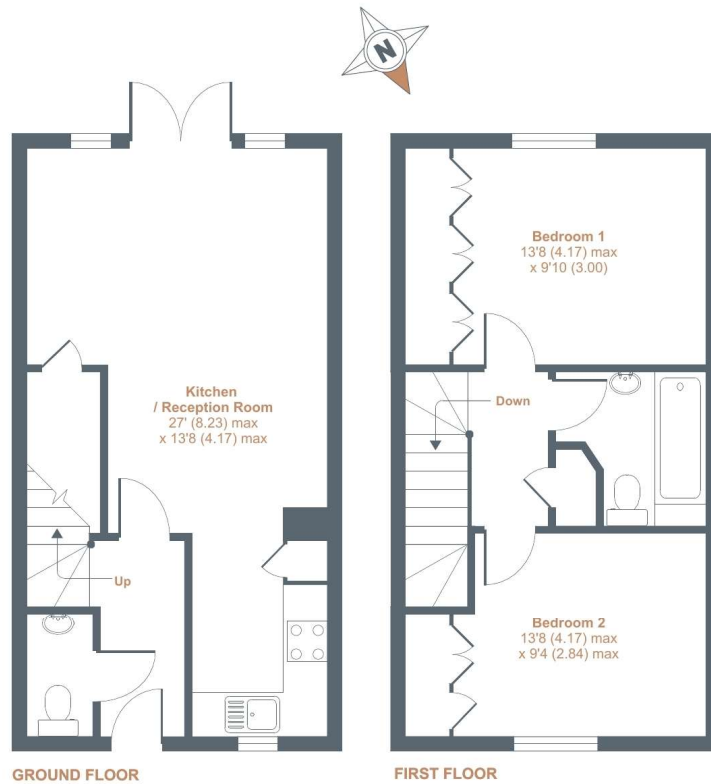

Floor plan produced in accordance with RICS Property Measurement Standards incorporating International Property Measurement Standards (IPMS2 Residential). © nichecom 2022. Produced for Kier Charles Property Services Limited. REF: 856477

KIER CHARLES
PROPERTY SERVICES

CONTACT INFORMATION:

Surrey: 01276 949789

Berkshire: 01344 513789

Hampshire: 01252 213789

info@kiercharles.co.uk

KIER CHARLES

SURREY • BERKSHIRE • HANTS