



CONNAUGHT ROAD, GU24

KIER CHARLES

SURREY • BERKSHIRE • HANTS

CONNAUGHT ROAD, GU24

VIEW WITH KIER CHARLES SURREY.

A stylish home having undergone extensive refurbishment and extensions creating a wealth of space over three floors.

The entrance hall is spacious and leads to a w.c, sitting room with a log burner, a beautifully finished open plan 26ft kitchen/breakfast room, with bi-fold doors leading to the garden, dining room, utility room and garage.

The first floor there is a large master suite with stunning en-suite shower room, there are two further double bedrooms, a large single/study and a family bathroom.

The second floor has a double bedroom with access to eaves storage and an en-suite shower room.

To the front you have driveway parking for three cars and front access into the garage.

The rear garden is well maintained and offers privacy, with a large patio across the back offering a perfect spot for summer entertaining, there is an outbuilding with power, light and internet connection for an external office.

To fully appreciate the space, condition and location a personal tour with Kier Charles is highly recommended.

- **PERIOD PROPERTY**
- **BEAUTIFUL OPEN PLAN KITCHEN**
- **UTILITY ROOM**
- **OUTBUILDING WITH POWER & INTERNET**
- **SOLAR PANELS**
- **PRIVATE ENCLOSED REAR GARDEN**
- **NO ONWARD CHAIN**
- **GARAGE AND DRIVEWAY**
- **WALKING DISTANCE TO BROOKWOOD STATION**

PROPERTY INFORMATION

Postcode	GU24 0HF
Tenure	Freehold
Price	£800,000
Viewing	By appointment with Kier Charles





Connaught Road, Brookwood, Woking, GU24

Approximate Internal Area = 1757 sq ft / 163.2 sq m
 Approximate External Area = 1994 sq ft / 185.2 sq m
 Garage = 149 sq ft / 13.8 sq m
 Outbuilding = 96 sq ft / 8.9 sq m
 Total Internal Area = 2002 sq ft / 185.9 sq m
 Total External Area = 2318 sq ft / 215.3 sq m

For identification only - Not to scale

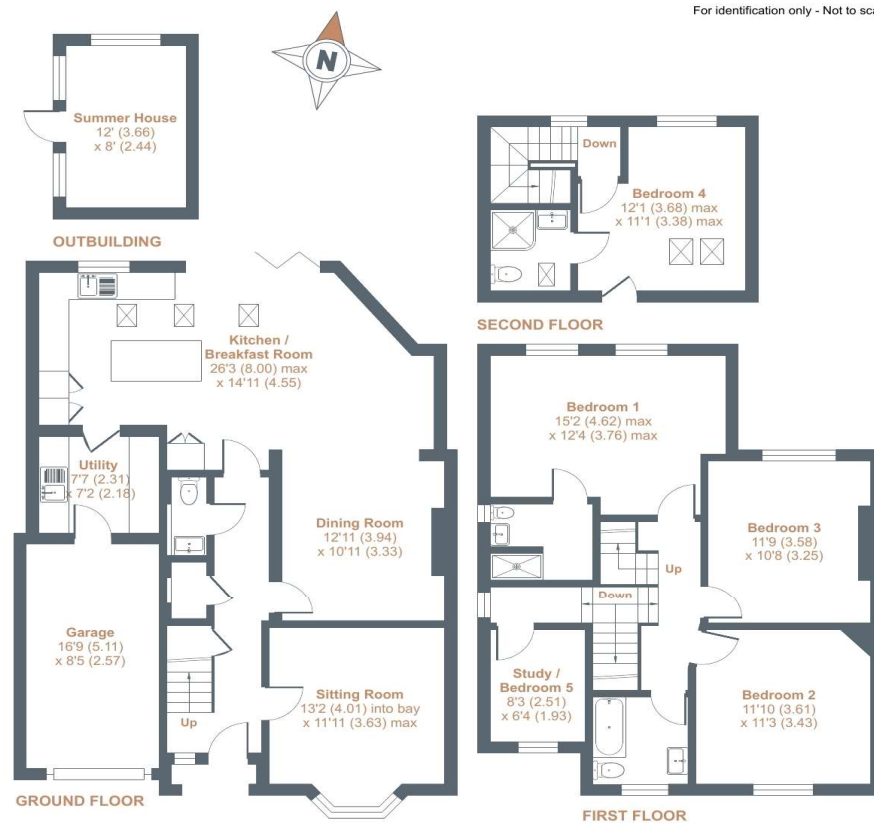

Floor plan produced in accordance with RICS Property Measurement Standards incorporating International Property Measurement Standards (IPMS2 Residential). © richcom 2024. Produced for Kier Charles Property Services Limited. REF: 1115159

KIER CHARLES
SURREY • BERKSHIRE • HANTS • LONDON

CONTACT INFORMATION:

Surrey: 01276 949789

Berkshire: 01344 513789

Hampshire: 01252 213789

info@kiercharles.co.uk

KIER CHARLES

SURREY • BERKSHIRE • HANTS