



Westbourne Terrace

Bayswater, W2

Asking Price £225,000

This bright and well-located studio apartment offers an excellent opportunity for first-time buyers, rental investors, or those seeking a convenient London base. Measuring approximately 225 sq ft with impressively high ceilings of 3.1 metres.

CHESTERTONS

Westbourne Terrace, W2

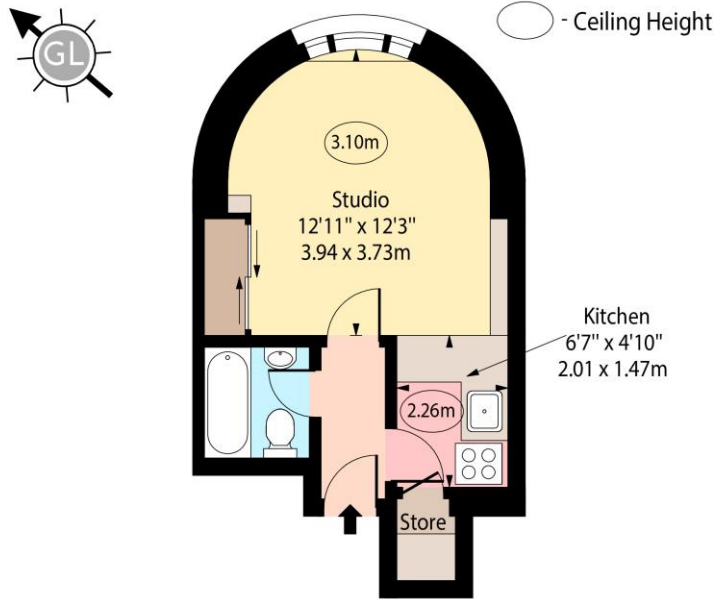

Raised Ground Floor

Approx Gross Internal Area 225 Sq Ft - 20.90 Sq M

Every attempt has been made to ensure the accuracy of the floor plan shown. However, all measurements, fixtures, fittings, and data shown are approximate interpretations and for illustrative purposes only. Measured according to the RICS IPMS 2. Not To Scale. www.goldlens.co.uk Ref. No. 028142M

Tenure: Share of Freehold with 999 year lease
Service Charge: £3611.52 per annum (including reserve fund contributions)
Ground Rent: None
Local Authority: City of Westminster
Council Tax Band: C

Score	Energy rating	Current	Potential
92+	A		
81-91	B		85 B
69-80	C		
55-68	D	65 D	
39-54	E		
21-38	F		
1-20	G		

Chestertons Hyde Park & Marylebone Sales

40 Connaught Street
 London
 W2 2AB
hydepark@chestertons.co.uk
 020 7298 5900
chestertons.co.uk

Chesterton UK Services Limited trading as Chestertons for themselves and for the vendor of this property whose agents they are, give notice that (i) these particulars do not constitute any part of an offer or contract, (ii) all statements contained within these particulars are made without responsibility on the part of Chestertons or the vendor, (iii) whilst made in good faith, none of the statements contained within these particulars are to be relied upon as a statement or representation of fact, (iv) any intending purchasers must satisfy themselves by inspection or otherwise as to the correctness of each of the statements contained within these particulars, (v) the vendor does not make or give either Chestertons or any person in their employment any authority to make or give representation or warranty whatsoever in relation to this property. Wide angle lenses may be used. ©Copyright Chestertons | Chesterton UK Services Limited | Registered Office 40 Connaught Street, Hyde Park, London W2 2AB Registered Company Number 05334580.



This paper is 100% recyclable