

# LEVEL ONE - Exhibit Hall

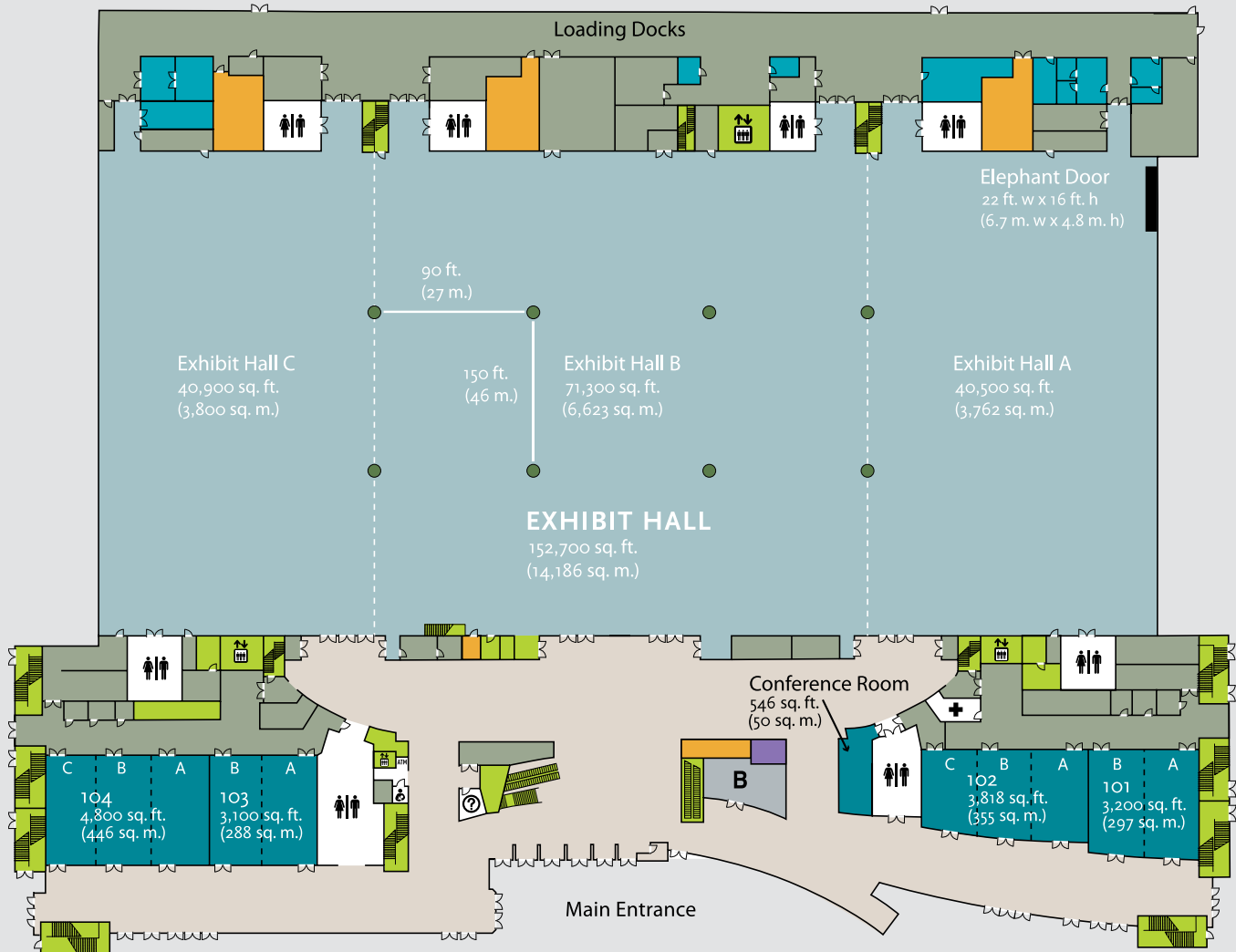

Discover  
**PUERTO RICO**

## Floor plan



- |                               |                    |                          |                        |
|-------------------------------|--------------------|--------------------------|------------------------|
| Back of the House             | Meeting Space      | <b>B</b> Business Center | Restrooms              |
| Concessions                   | Office Space       | <b>+</b> First Aid       | Telephone              |
| Escalators, Elevators, Stairs | Public Circulation | Help Desk                | Elevator               |
| Exhibit Hall                  | Green Room         | Mother's Room            | <b>ATM</b> ATM Machine |

# LEVEL ONE - Exhibit Hall

## Dimensions and capacity

Exhibit Halls & Meeting Rooms	Gross Square Feet	Booth 10'x10'	Theater	Seating Capacities*		
				Banquet	Classroom	Reception
Hall A, B & C	152,700	794	16,576	7,560	7,605	12,000
Hall A	40,500	210	4,140	1,980	2,145	3,500
Hall B	71,300	372	6,510	3,600	3,315	6,500
Hall C	40,900	212	4,140	1,980	2,145	3,500
<b>Meeting Rooms 1st Floor</b>						
Meeting Rooms (Total)	14,900	8'x10'	-	-	-	
Meeting Rm 101 (Total)	3,200	16	334	160	160	336
101-A	1,600	8	156	80	99	168
101-B	1,600	8	156	80	99	168
Meeting Rm 102 (Total)	3,818	18	353	200	198	400
102-A	1,300	5	121	60	81	137
102-B	1,300	6	121	60	81	137
102-C	1,200	7	102	50	58	126
Meeting Rm 103 (Total)	3,100	18	344	200	186	337
103-A	1,500	9	172	80	93	168
103-B	1,600	9	172	80	93	169
Meeting Rm 104 (Total)	4,800	22	506	280	260	505
104-A	1,500	7	156	80	99	158
104-B	1,700	7	156	80	99	179
104-C	1,600	8	156	80	99	168
Chrysler Conference Room	546	Existing Boardroom for 24 people				

Subject to change without notice.

\*Seating capacities are subject to change depending on the orientation of the room and the equipment that is being used.



Discover  
**PUERTO  
RICO**



1.800.875.4765 | [DiscoverPuertoRico.com](http://DiscoverPuertoRico.com)

# LEVEL TWO - Meeting Rooms



Discover  
**PUERTO RICO**

Floor plan

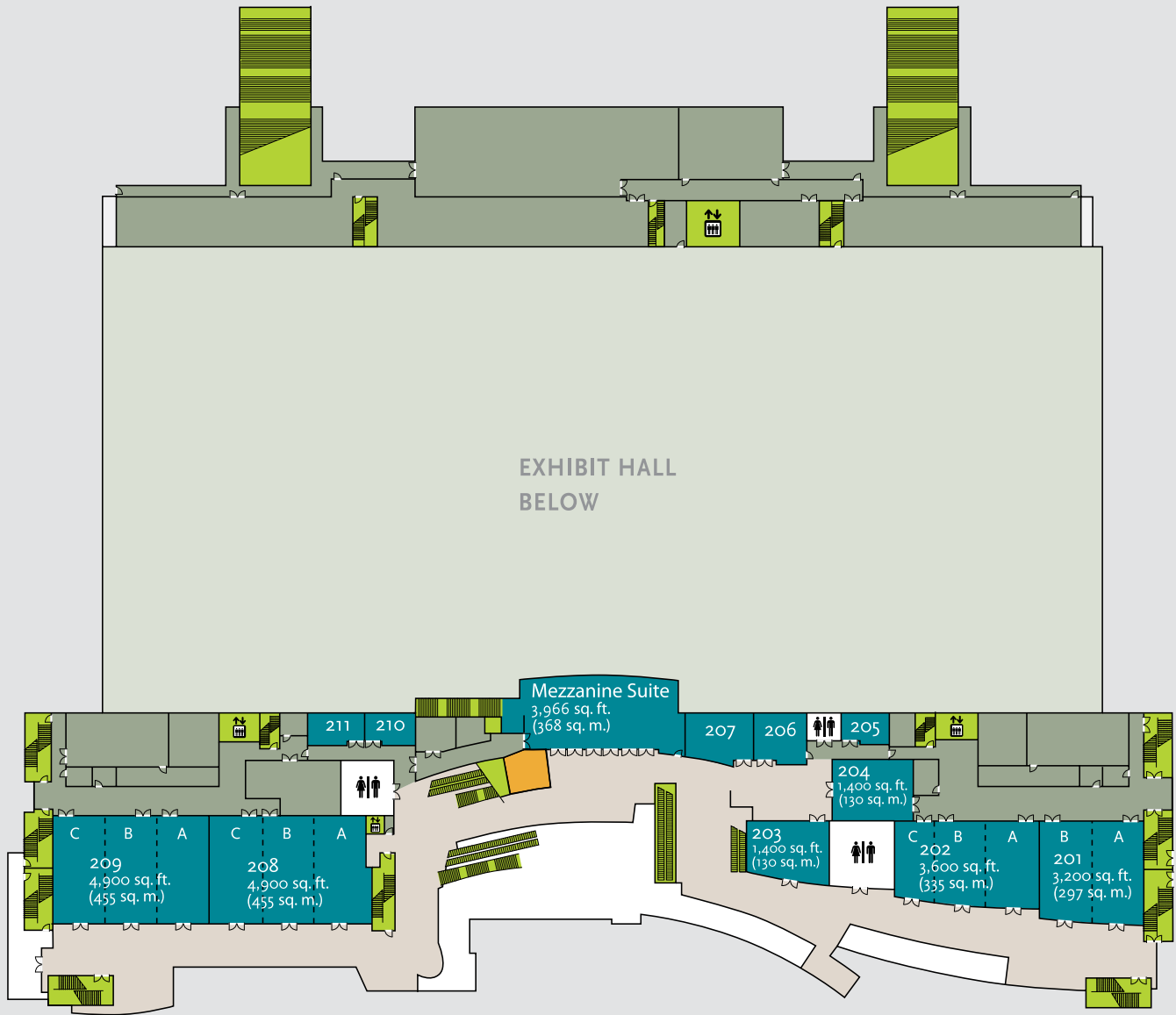

- |                               |                    |                          |                        |
|-------------------------------|--------------------|--------------------------|------------------------|
| Back of the House             | Meeting Space      | <b>B</b> Business Center | Restrooms              |
| Concessions                   | Office Space       | <b>+</b> First Aid       | Telephone              |
| Escalators, Elevators, Stairs | Public Circulation | Help Desk                | Elevator               |
| Exhibit Hall                  | Green Room         | Mother's Room            | <b>ATM</b> ATM Machine |

# LEVEL TWO - Meeting Rooms

## Dimensions and capacity

Exhibit Halls & Meeting Rooms	Gross Square Feet	Booth 8'x10'	Theater	Seating Capacities*		
				Banquet	Classroom	Reception
<b>Meeting Rooms 2nd Floor</b>						
Meeting Rooms (Total)	22,687	8'x10'	-	-	-	-
Meeting Rm 201 (Total)	3,200	16	288	160	190	336
201-A	1,600	8	144	80	90	168
201-B	1,600	8	144	80	90	168
Meeting Rm 202 (Total)	3,600	12	353	180	200	389
202-A	1,300	6	126	60	84	137
202-B	1,300	5	126	60	84	137
202-C	1,000	3	105	50	56	115
Meeting Rm 203	1,400	7	147	70	80	147
Meeting Rm 204	1,400	7	150	90	96	147
Meeting Rm 205	450	N/A	Existing setup for 10 people			
Meeting Rm 206	800	N/A	72	40	49	84
Meeting Rm 207	1,100	N/A	106	60	60	116
Meeting Rm 208 (Total)	4,900	22	600	280	327	516
208-A	1,600	9	170	80	99	168
208-B	1,700	8	170	80	99	180
208-C	1,600	8	170	80	99	168
Meeting Rm 209 (Total)	4,900	22	567	280	315	516
209-A	1,600	8	156	80	99	168
209-B	1,700	7	156	80	99	180
209-C	1,600	8	156	80	99	168
Meeting Rm 210	400	N/A	Existing setup for 10 people			
Meeting Rm 211	537	N/A	Existing setup for 10 people			
Mezzanine Suite	3,966	N/A	320	180	195	400



Discover  
**PUERTO RICO**



1.800.875.4765 | [DiscoverPuertoRico.com](http://DiscoverPuertoRico.com)

# LEVEL THREE - Ballroom



Discover  
**PUERTO RICO**

Floor plan

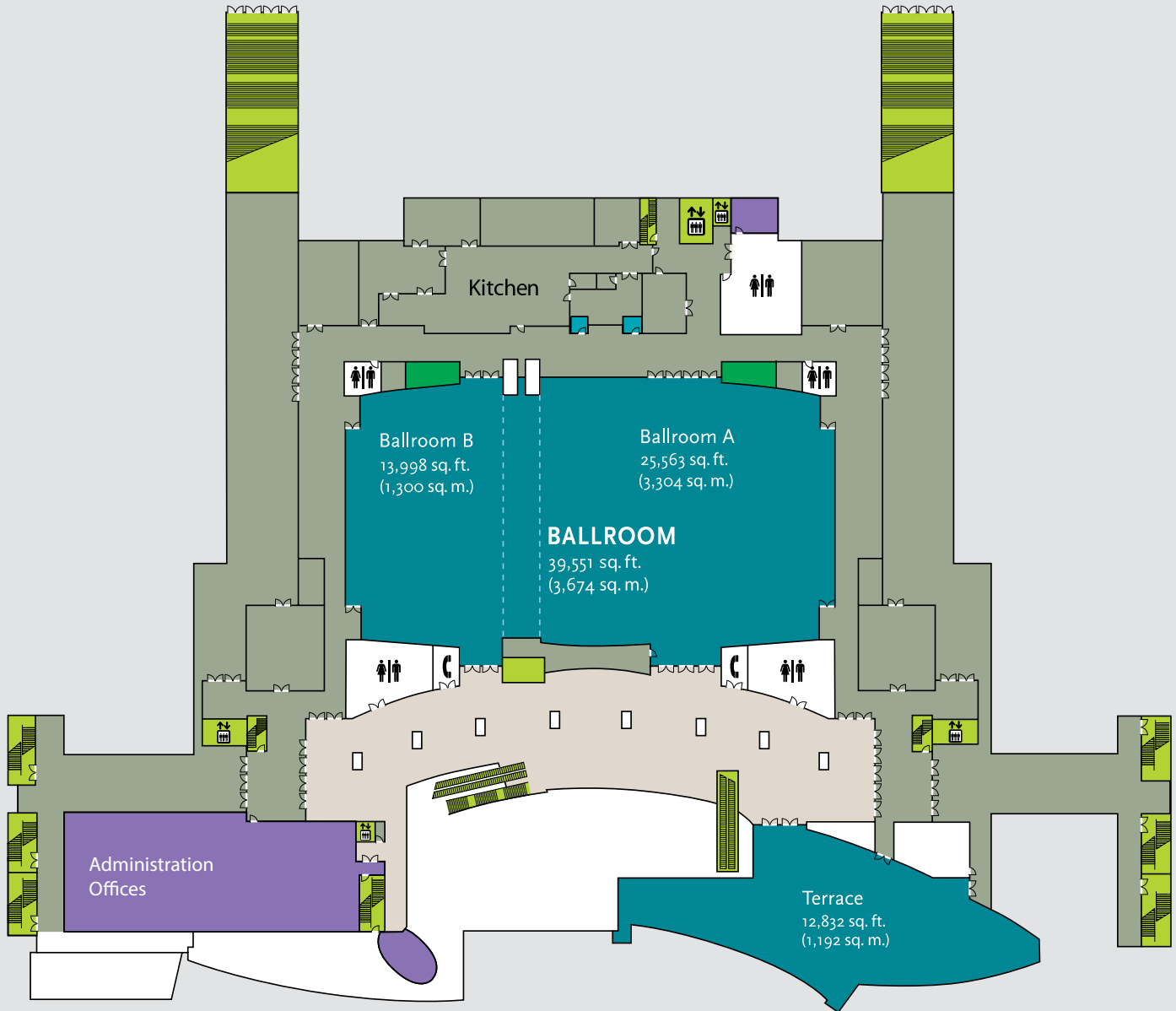

- |                               |                    |                          |                        |
|-------------------------------|--------------------|--------------------------|------------------------|
| Back of the House             | Meeting Space      | <b>B</b> Business Center | Restrooms              |
| Concessions                   | Office Space       | <b>+</b> First Aid       | Telephone              |
| Escalators, Elevators, Stairs | Public Circulation | Help Desk                | Elevator               |
| Exhibit Hall                  | Green Room         | Mother's Room            | <b>ATM</b> ATM Machine |

# LEVEL TWO - Ballroom

Dimensions and capacity

Exhibit Halls & Meeting Rooms	Gross Square Feet	Theater	Seating Capacities*		
			Banquet	Classroom	Reception
<b>3rd Floor</b>					
Ballrooms A & B (Total)	39,551	3,900	2,130	2,676	3,934
A	25,563	2,340	1,320	1,710	2,450
B	13,988	1,260	590	858	1,288
Terrace	12,832	–	600	–	1,200



Discover  
**PUERTO  
RICO**



1.800.875.4765 | [DiscoverPuertoRico.com](http://DiscoverPuertoRico.com)