



Policy Handbook

Fellowship Baptist Church

2827 E. 32nd St.

Joplin, MO 64801

417-781-5174



2 Timothy 2:15

WELCOME TO AWANA!

Thank you for allowing your children to come to Awana! We trust they will have a great time and will want to keep coming regularly all year! Our meetings are held on Wednesday nights from 6:00 - 7:45 p.m.

The Bible says "Train up a child in the way he should go, and when he is old he will not depart from it." (Proverbs 22:6) Realizing that children today are confronted with more difficult decisions than ever before, Awana's Bible-based program seeks to establish them on a firm Biblical foundation which will provide direction for their daily lives. Each clubber is very special to us and to God.

Awana presents an opportunity for your children to establish and grow in their relationship with God, and to build self-esteem and good relationships with others. You can really help them in these areas by encouraging them to complete sections in their handbook, and showing interest in their achievements.

Feel free to visit the club meetings any time to talk with us about your special concerns.

If you would like to be involved by working in our program, call the church office at 781-5174.

FELLOWSHIP BAPTIST CHURCH

2827 E. 32ND ST.

JOPLIN, MO 64804

417-781-5174

PARENTS, WE NEED YOUR HELP!

Moms and Dads are essential helpers in a child getting the most enjoyment out of club. Please use the following checklist as a guideline:

1. Help children to attend Awana every week. Consistency will build friendships and achievement. Be sure they arrive on time: 5:45-5:55 p.m. Promptness helps us to maintain good discipline.
2. Dues are voluntary, however, if possible, we do ask each clubber to bring \$0.25 each week to donate to the Missionary Fund to support our club's missionaries. Collection containers will be available at the check-in tables.
3. Help your child accomplish their section each week. This will insure they finish their book and receive the book award.
4. Alert your child's group director to any learning styles that would help us teach your child.
5. The replacement cost for a lost handbook is the parents' responsibility.
6. Attend all major events. Parents are always welcome and may also attend any club meeting.
7. Pick up your children promptly at 7:45 p.m. (Cubbies will need picked up by 7:40 p.m.)
8. Always encourage your child. Children have much more fun when Mom and Dad show interest in their accomplishments.
9. Volunteer to help by working in Awana.
10. Call the Awana Ministry Director . LaJeana Sapp (417-529-4152) or our Director of Kids and Family Ministry, Josh Manning (417-540-5543) if you have any questions.

AWANA CANCELLATIONS

Our goal at Fellowship Baptist Church is to carry out all programs and events as scheduled; however, for the safety of our kids, families, and leaders, programs and events may be canceled due to inclement weather. In the event of inclement weather, we will publish a notification of cancellation through our text messaging system, Facebook Group, and church website by Noon on the day of programming. You will receive notice by whichever method of communication you chose at registration.

AWANA CLUBBER GUIDELINES

In order to have a safe, enjoyable, and orderly environment, our club has established these guidelines. All young people are expected to follow them. Your cooperation will bring about a good time for all.

1. When you arrive, check in with your club secretary and take a seat in the chairs where your group is assigned.
2. Respect your fellow club members. Treat them as you wish to be treated.
3. Everyone is encouraged to participate—whether playing games, listening, studying, singing, or anything else.
4. Remain on the church property at all times.
5. No running in the building.
6. Leave all food and drink (including gum) at home, except when provided by your club leader.
7. Do not cross the parking lot without double checking, then walk slowly.
8. Come to attention whenever a leader begins to count to 5.
9. Obey and respect all Awana leaders.
10. Bring your Awana book and a Bible every week. If you don't have a Bible, we can provide you with one.
11. Bring a note from your parents (or have them call your director or leader) if they have a question or request for you.
12. Please take care of the church property and club equipment.
13. Proper attire is important because we do play games:
 - Girls - comfortable pants, jeans, or shorts. Dresses are discouraged because of game time activities.
 - Boys - comfortable pants, jeans, or shorts
 - Sneakers or gym-type shoes should be worn to safely participate in game time.
14. Have a good time in every part of club!

OUR PROGRAM AND NIGHTLY SCHEDULE:

Group	6:00 - 6:05	6:10 - 6:30	6:35 - 6:55	7:00 - 7:15	7:20- 7:45	7:45 Pick up in:
Cubbies 3 & 4 yr. olds (3 before 7/31/25)	Opening Worship Center	Handbook	Game time (Combined w/K)	Activities/Lesson time		Room #1
Sparks K - 2nd grade	Opening Worship Center	Game time (1st & 2nd Gr.) Handbook (Kindergarten)	Handbook (1st & 2nd Gr.) Game time (Kindergarten)	Music/Awards/Lesson		Room #205
T&T 3rd—6th grades	Opening Worship Center	Large group Lesson		Games	Small group	3-4th Coed: Rm. #104 5/6ht Girls -Rm #111 5/6th Boys—Room #113

Director of Kids and Family Ministry: Josh Manning 417-540-5543
 AWANA Ministry Director : LaJeana Sapp 417-529-4152
 Puggles (Pre-Cubbie 2-3 yr olds): Lori Jones 417-437-7709
 Cubbies (Pre-K): Katie Robyn 417-483-6729
 Sparks (K-2 Gr.): Gary Wheeler 417-499-3652
 3rd—4th Grade T&T Coed: Ashley Stull 417-499-1479
 5th –6th Grade T&T Girls: Carolyn Knudsen 417-850-1913
 5th –6th Grade T&T Boys: Jacob Eaton 417-438-7067

MATERIAL COSTS

Dues are voluntary, however, any donations will be divided between our Awana missionaries and the Mercy Ministries—AFM Africa Children's Home.

Upon completion of the entrance booklet, a handbook will be issued to each child free of charge. However, should a book be lost or destroyed, the replacement book will cost \$15.00.

PENNANT/AWARDS

Each club has an entrance booklet that must be passed in order to earn a handbook. Each clubber then earns section awards while working their way through the handbook. Section awards vary from group to group, from sew-on patches to badges that hold insertable awards. These awards are affixed to a keepsake pennant that is kept on display at the church. This pennant will be included with the awards for completed books that are handed out at the year-end Awards Celebration.

Attendance awards are given out on a quarterly basis as well.

SNACKS

Due to severe food allergies, we ask that NO FOOD be brought in unless it is first cleared by your child's teacher. Any snacks provided by teachers will be served by accommodating those with allergies with alternative snacks.

THE AWANA STORE

Each week clubbers may win or earn Awana shares (like paper money) which can be saved and traded for items out of our Awana store. The store is meant as a motivator to help each child achieve in every area of club, especially in their handbook work. Shares can be earned by meeting certain requirements in each club. These requirements are set by each individual club director. The store will be open from 5:30-5:55 p.m. and during Games time once each quarter. See the Awana calendar for store dates.

Cubbies (Pre-K) MUST be accompanied by a parent to the store. We request that if your child purchases something before Awana, that the item be taken to the car by the parent so that it will not cause disruption during class time.

If shopping before Awana, Cubbies and Sparks should be accompanied to Check-In time in the Worship Center foyer by 5:55 p.m.

If you would like to donate new or gently used items to the Awana Store, please see our Store Director, Tammy DeVine, during store hours.

DISCIPLINE

Awana has established two main methods of discipline for use in Awana clubs:

THE FIVE-COUNT SYSTEM: When it is necessary to quiet the entire group of clubbers, the five-count system is used. The leader will raise their hand and start counting, showing the count by hand. The time it takes to count to five gives the clubbers and leaders ample opportunity to become quiet. When "five" is reached, absolute silence should reign. If a single individual seems to be the cause of the problem, the Three-Count should be used.

THE THREE-COUNT SYSTEM: The Three-Count System is used when a clubber is misbehaving. At the first occurrence of unacceptable behavior, the clubber is given a one count by the leader and the behavior that is sought is explained. At the second occurrence, he/she is given a two count and counseled away from the group by the Club Director and another leader. At the third occurrence, he/she is given a three count and taken to the Commander's office for counsel and possible suspension from the rest of the evening's activity.

If a serious infraction occurs, such as fighting or aggressive speech, in addition to the Three Count, the parent will be notified. Full suspension is also a possibility depending on the infraction. The clubber will be allowed to return to the program only after asking for their leader's or anyone else's forgiveness that the offense was against as well agree to abide by club rules and respect the authority of the Awana Leadership. Our goal is to promote Scriptural reconciliation of all involved parties and to restore the offending child to all activities.

VISITORS

We love visitors and encourage that opportunity through our Bring-A-Friend reward system. We do ask that the visiting child's parental info/contact number, as well as any medical issues, be given to the secretary at check-in.

If the visiting friend is not in the same age group as the clubber, they are allowed to stay with their friend for the night. However, if they choose to come back, we ask that they be registered online before returning and that they attend the group that corresponds to their age.

If your child brings a new-to-us friend, the child and their friend are each given a free food gift card to a local eatery. Sometimes it's Andy's Frozen Custard and sometimes it might be Chick-fil-a.

FELLOWSHIP
HALL

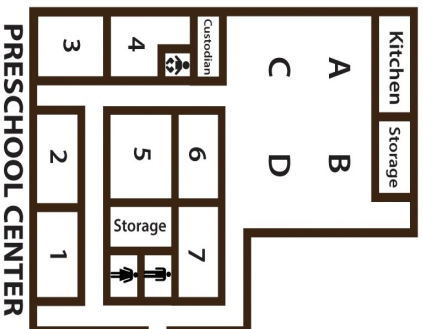

WORSHIP
CENTER



EDUCATION BUILDING

