

# Touring St. Andrew Presbyterian Church's New Home

## 140 Gathering Place Lane, Iowa City

### Atrium (north)

- Begin where the main door opens to the building.
- Point out how the space just naturally draws your eyes to the windows on the far end and pulls you into the room.
- St. Andrew's old building on Melrose didn't have any place as open, airy and spacious.
- The various carpeted areas throughout the Atrium allow for the feeling of smaller rooms within the larger rooms. People can meet and visit at their leisure.
- The signage here also allows visitors to orient themselves.

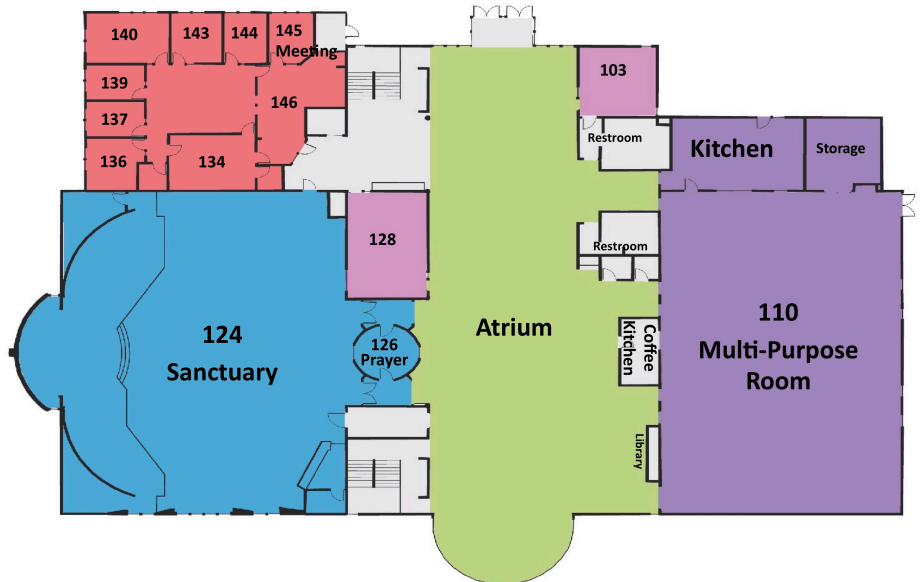

### Offices (Rooms 134-146)

- Walk next through the office suite.
- Point out the circular counter, where the office administrator connects with both visitors and staff.
- As you walk through, point out the conference room, the open work area for part-time staff and ministry volunteers.
- Point out the individual offices for pastors and directors of ministry. (*It's a good, quick way to list our ministry staff.*)
- End in the large work room where staff members can do all their assembling, collating, printing and publishing.

### Sanctuary I (Room 124)

- Walk next into the Sanctuary and point out all the natural light.
- Ask the visitors to turn around to look at the Krapf Organ, which St. Andrew salvaged from the University of Iowa's Clapp Recital Hall after the 2008 flood.

- FEMA wouldn't let the university reuse the organ, so it was handed over to Peterson Contractors to sell or salvage.
- Peterson decided to donate the organ to St. Andrew as a way to keep the historic instrument in the community.
- We had to raise the money to remove the organ, restore it and install it.
- We also are continuing to work to improve the acoustics in the room.

### Sanctuary II (Room 124)

- The "pew chairs" will seat about 250-300 people — with space for more if needed.
- The room was designed for flexibility of seating and use of the chancel for worship and concerts.
- Several pieces of furniture on the chancel area — the communion table, the baptismal font, the pulpit and the two chairs — are from wood harvested from black walnut trees on the Melrose property. We hired a local artist to make the baptismal bowl and wooden furniture.
- The cross also was part of the old Sanctuary on Melrose.

## Prayer Room (Room 126)

- While leaving the Sanctuary, point out the circular room that represents St. Andrew's strong prayer ministry.
- This is an area in which, after worship, people can meet with a pastor or an elder of the church and have some personal prayer time.
- The room also offers families a place for private reflection before a wedding or a funeral.
- The unique glass changes color based on light and way you look at it.
- *The purple carpet also makes the room a fun place for kids to hide.*

## Atrium (south)

- As you exit the Sanctuary, point out the coffee kitchen and café area, which were designed for receptions.
- The space primarily is used for coffee and conversation between services on Sunday mornings.
- Walk over to the windows and take a good view of the full property.
- Point out the Lettuce Feed Others garden to the right, which provides fresh greens for the Crisis Center food bank.
- Point out where the playscape will be located.

## Library

- As with other spaces in the building, the library is designed to be multi-use.
- Studies show that libraries often get under-used in churches that set aside whole rooms for books. *(People won't go into such rooms if they see someone already in there.)*
- Our library space is designed to invite people to check out the books even if the sitting area is filled with people
- There are still plans to build some counter-height shelving to surround the carpeted area.

## MPR (Room 110)

- As you move from the library to the Multi-Purpose Room, stress the multi-use nature of the space.
- The room, right now, is best set up for large receptions — complete with its own sound system.
- It occasionally gets referred to as “the gym,” but it's not currently set up as a gym.
- It is used regularly for games and other programming for youth and children's ministry.
- A new team is exploring the process for putting in a rubberized floor, basketball hoops and other equipment, so the room can be used for more physical activities.

## Kitchen

- With the kitchen located directly off the MPR, we are adding commercial-grade equipment, even though we won't seek to license the space as a commercial kitchen.
- We've also designed the space to include a lot of outlets for crockpots and roasters, because that's the way that churches are going now: *They cater; they don't make a big meal in the kitchen.*

## Bridal Room (Room 103)

- This conference room doubles as a Bridal Room in which brides can get ready before their big day.
- It has a side access that will take brides right into the women's bathroom.

## Collection Counter

- Before going downstairs, point out the Collection Counter opposite the stairs.
- On Melrose, we used to have boxes all over to collect food for pantries.
- Now people just put donations in the slots, and we can take things out easily.

## Choir Room (Room 7)

## Bell Room (Room 6)

- The tour now moves to the lower level, or the “educational level.”
- Start in the Choir Room and point out how it is similar to the Bell Room right next door.
- The Choir Room has acoustic tiles to allow for a good rehearsal space for the various choirs as well as the brass.
- There also is significant space for storing robes and music.
- The Bell Room provides space to leave out the bells and tables and thus avoid losing a lot of practice time in set up.



## Children's Ministry Area (Rooms 37-58)

- The main entrance to the lower level comes right into the Children's Ministry Area.
- There is a station where parents can check-in their kids, and the classrooms are color coded so that the different ages groups know where to go.
- Children's ministry has its own gathering area, which was used extensively during Vacation Bible School as well as during men's and women's retreats. (Again, all rooms are designed to be multi-use.)
- Rooms 37 and 38 include a bare-floor area that may look unfinished, but it is to be used as an arts and crafts area where children can spill on the floor and not worry about staining.
- There is also a supply room for the Sunday school teachers — complete with its own coffer maker and copy machine.

## The Hub (Room 28)

- The Hub is St. Andrew's main youth ministry area.
- It opens up into our patio area, which includes a fire pit and gaga pit.

- It's where BASIC, the junior high group, and ETC, the senior high group, meet to sing, play and break for smaller group studies.
- The Hub and its three break-out classrooms, however, are designed to be multi-use.
- The space gets used by the Women's Bible Study on Wednesday mornings, by Adult Education on Sunday mornings and by other groups as needed.

## Pop Up Ministry (Room 21)

- Walk through the classrooms to the Pop Up Ministry Room.
- This large unfinished area, in theory, is supposed to be empty much of the time.
- It needs to be ready to serve as needed as short-term storage for the church and the community.
- The room, located beneath the MPR, has been extremely helpful during the move-in process.
- The space has heat and a fire protection system, which will allow St. Andrew to use it as shelter overflow or to provide housing for visiting teams.

## Restrooms (future showers)

- The main restrooms on the lower level are identical in size, complete with a false wall that hides an extra room.
- That unused space has been plumbed for three showers on each side. When we have raised enough money, we will cut into those rooms and add the shower units.
- As we know from our own long mission trips, there's nothing better than staying at a church with that has a shower facility.

## Custodial Room

- Churches don't always brag about custodial rooms, but we're excited about this space.
- On Melrose, our maintenance space basically was a small closet.
- This room has plenty of space for shelving and is wired and plumbed for a washer and dryer — which were donated by a church member shortly after construction.

## Elevator

- Because we are a two-floor facility, we now have an elevator, which makes us a much more accessible community.

## Room 128

- Our final room, back on the upper level, is another conference room, but one with a full view into the Sanctuary.
- With full sound being piped in here, this space allows people to continue to be part of the worship service even as they need to step out of the worship service.

## Questions?

