

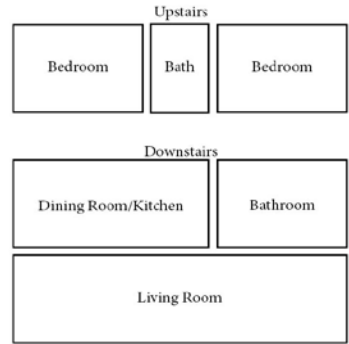

## Elk Run Cabins Room/Bed Assignment Sheet

6 Cabins  
2 Bedrooms & 2 Bathrooms Each.  
Maximum Capacity is 24.  
4 People per cabin.



| Cabin # | Bed   | Bed Assignment | Cabin # | Bed   | Bed Assignment |
|---------|-------|----------------|---------|-------|----------------|
| A       | Queen | _____          | D       | Queen | _____          |
|         | Queen | _____          |         | Queen | _____          |
| B       | Queen | _____          | E       | Queen | _____          |
|         | Queen | _____          |         | Queen | _____          |
| C       | Queen | _____          | F       | Queen | _____          |
|         | Queen | _____          |         | Queen | _____          |

Cabin A is Handicap Accessible