

Guidelines for In-Person Worship

Trinity United Methodist Church

To be a place of unconditional love, offering healing, help and hope.
As of June 2, 2020

Opening Thoughts

Transitioning from stay-at-home worship will have to be done slowly and require gradual steps to keep ourselves and our neighbors safe. The plans we have developed are based on the latest directions as given to us by the Alabama-West Florida Conference of the UMC, governmental authorities and the Center for Disease control. The opening of our In-Person worship services will involve NEW ways of doing things. We will need your patience, flexibility, kindness and sacrifice as we work through this together.

This plan implements the above guidelines for physical distancing and limits gatherings to 50 persons or less (including those serving). We will adjust these limits as guidelines are updated.

Please read the entire plan as it will help you and your family prepare to participate in our In-Person worship services.

Please be respectful of everyone's decision to gather at the church or worship at home. We love you all and look forward to a time when we can gather safely again. But until that time, we have a wonderful opportunity to practice the Scripture: *"Be kindly, affectionate to one another with brotherly love, in honor giving preference to one another"* Romans 12:10.

Our new procedures will require additional volunteers to serve as ushers, security, and disinfecting. If you are willing to help with any of these areas, we will provide contact information to volunteer for these teams soon.

Things you should know

It will be so very wonderful to see you again!!!

In-Person Worship times:

8:30 and 11:00am Traditional Services in the Sanctuary

9:45am Contemporary Service in the Memorial Fellowship Hall

If you have a fever or are not feeling well, please DO NOT come to In-Person worship, continue to worship from home. Also, older people, and people with pre-existing medical conditions (such as asthma, diabetes, heart disease) appear to be more vulnerable to becoming severely ill with the Covid-19 virus. Even with precautions in place, we cannot guarantee a completely risk-free environment. Use your best judgement in considering whether coming to In-Person worship is appropriate for you

Worship services will be 45 minutes to allow for cleaning of worship areas between services.

As recommended by our conference and civil government, we encourage you to wear a mask as you enter and exit the facility. If you do not have one, we will provide one for you to keep. Children 3 and under do not need a mask. Use your own judgment as to wearing the mask once you are seated.

Hand sanitizer will be available at every entrance.

The family restroom is available, but only in the case of an emergency.

Your children are welcome at *all* our services! However, nursery, and children's Sunday school will *not* be available. Children will remain with their family.

Please note that current guidance has placed restrictions on singing in group settings. We are exploring our options in complying with this guidance.

The soda fountain, water fountains and coffee pots will be unavailable.

No food or drinks at *any* service. This will aid our volunteers in cleaning our worship areas after service.

All classrooms and common areas in each building (including office hallways in building A) will be closed. Please refrain from gathering in the buildings before and after services.

The ushers will not be passing offering plates during service. However, an offering basket will be at each entrance, or you may continue to mail your offering or give online.

Procedures

1. Reservations

Once we establish an In-Person worship date, beginning at 9am, the Monday before Sunday worship, you may call or email the church office to make your reservation for the following Sunday. It will be first come, first served on service reservations. If the service is filled, you will be placed on a waiting list. Those on the waiting list will get the first reservations for the next Sunday's service.

You may make your reservation by emailing reservations@trinityfwb.org or by calling the church at 850-862-4169.

We will need the following information for your reservation:

- Which service you wish to attend.
- Name.
- Phone number and/or email.
- Whether you need handicap parking or assistance.
- Number of people in your group.

If you find you will not be able to keep your reservation, please call or email the church by 9am Friday, and let us know so that we can invite someone from the waiting list.

2. Parking

Each parking lot has an associated door through which you will enter and exit:

- Parking lot and Entrance #1 – Back of the Sanctuary (handicap parking only).
- Parking lot and Entrance #2 – East side of the Sanctuary (no handicap parking).
- Parking lot and Entrance #3 – Front of Sanctuary (some handicap parking).
- Parking lot and Entrance #4 – West side of preschool (some handicap parking).
- Parking lot and Entrance #5 – Back of the Memorial Fellowship hall (some handicap parking).

Parking lots 1-3 will be used for Traditional Worship, while 4 and 5 will be used for Contemporary Worship. We will post signage to help guide you.

When your reservation is confirmed, you will be assigned a parking lot. It is extremely important that you park in your assigned parking lot and use your assigned doors so that we can maintain appropriate physical distancing among all attendees.

3. Entering

All doors will be propped open 15 minutes before service, so that no one will have to touch them. Please remain in your car until the doors open. If a line forms, we ask that each family maintain 6' physical distance from other families.

We will have an usher available at each entrance to guide you. They will be wearing masks. *Only staff and ushers will use the middle aisle.*

Please cooperate with their instructions. This is new for all of us!

4. Seating

We will designate an area of seating that will correspond to an entrance. As you enter, an usher will lead you to your seats in your designated section. We will seat persons starting farthest from the door and finishing closest to the door. For example, entrance #3 will fill pews from back to front, entrances 1 and 2 will fill pews from front to back.

Unfortunately, we will be unable to accommodate "favorite spots or pews," but we will do everything we can to provide a worshipful experience.

To locate your parking lot and entrance, please see the attached map of the church campus and parking lots.

We ask that only persons from the same household sit together.

Traditional Worship

- Pews will be marked with an X to indicate which areas are unavailable so that we can maintain 6' physical distance per guidelines.
- Ushers will lead you down the side aisle to a pew based on your order of arrival and family size.

Contemporary Worship

- Seats will be arranged in clusters for families or couples (as appropriate). Each cluster will be placed 6 feet from neighboring clusters.
- Please do not move chairs around or join other families or couples.

We ask that you do not move around the room and greet people. Please wave at a distance. In consideration for our fellow worshipers, it is important to follow the physical distance guidelines between non-family members.

5. Exiting

At the end of the service, please do not immediately stand and exit. Please wait for the usher to signal you to stand and exit. This will help to maintain appropriate physical distancing. You will exit through the same door you entered. We ask that you refrain from gathering in the hallway or doorways.

Please remember, only staff and ushers will use the middle aisle.

Although we are not establishing physical distancing guidelines in the parking lot, please be considerate others and maintain appropriate distance from them. We are not always aware of the health situation of our fellow worshipers or of their families.

Notes

Cleaning/disinfecting procedures are being defined. When these are ready, we will be asking for volunteers to clean between services. Volunteers will receive training prior to re-opening In-Person Worship.

We will be asking for volunteer ushers/greeters, who will also receive training on our safety procedures.

Final Thoughts

Thank you for your faithfulness to Christ and to Trinity United Methodist Church. We are excited about being able to worship together again in person. We are grateful for your patience and grace as we implement safety procedures.

If you have any questions, please contact Lisa Simon at music@trinityfwb.org.

Sanctuary map for In-Person Worship

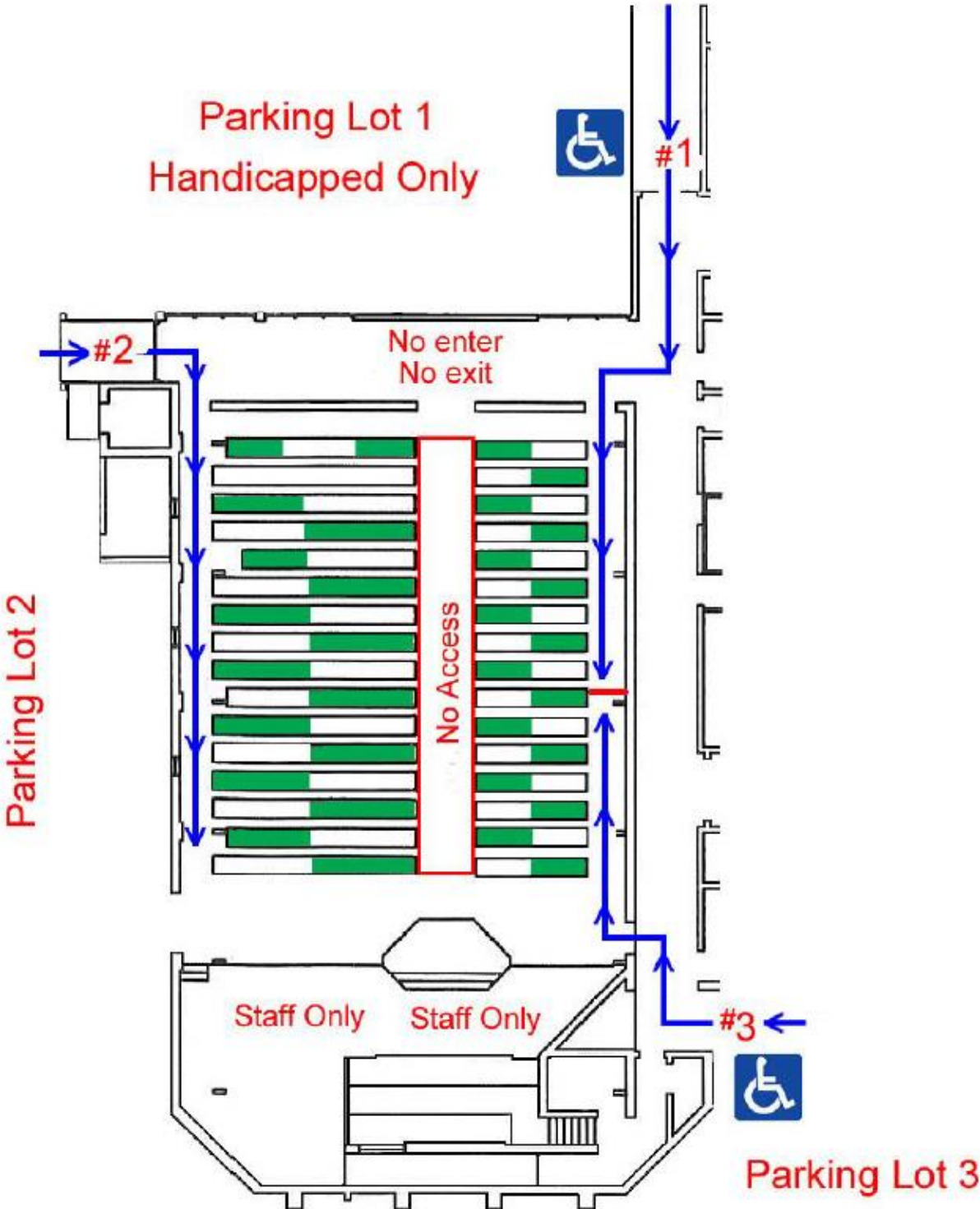

Memorial Fellowship Hall Map for In-Person Worship

No Parking for Fellowship Hall
No Entrance

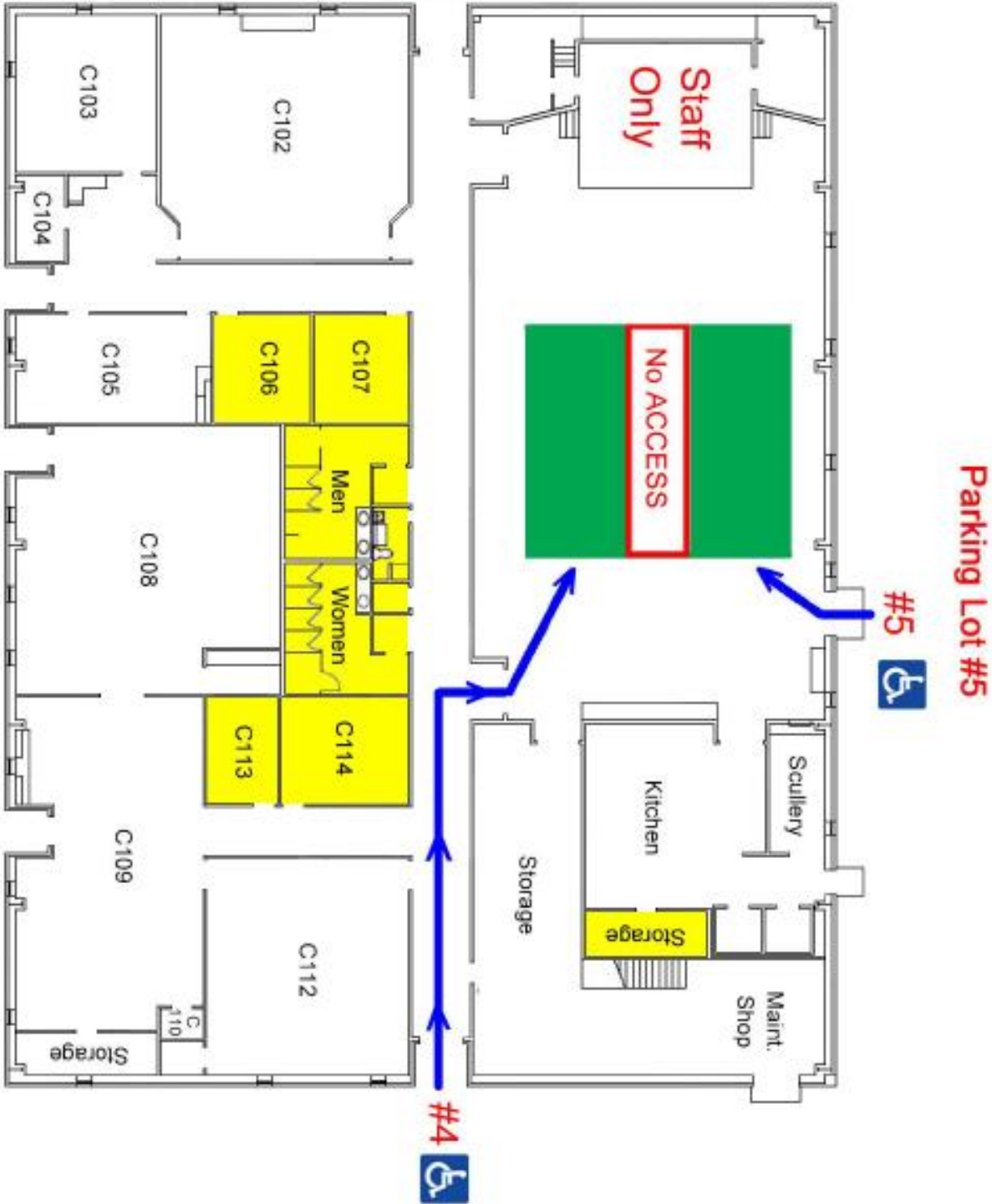

Parking Lot #4