

Woodland Lodge/CYPRESS (15 room available)

Cost: 255.00 + 35per extra family

Sleeps 4-8...2 Q Beds, 2 Single Murphy Beds, Sleeper Sofa, Small refrigerator, microwave... **Linens provided**



CHALETs (16 available)

Suggest some families combine to make it cheaper and more fun!!! Cost: \$245.00 + 35 per extra family

Each has 2 bedrooms & 2 bathrooms with kitchen (including refrigerator, stove, oven & microwave), living room, and sleeps up to 7 people...**Linens provided**

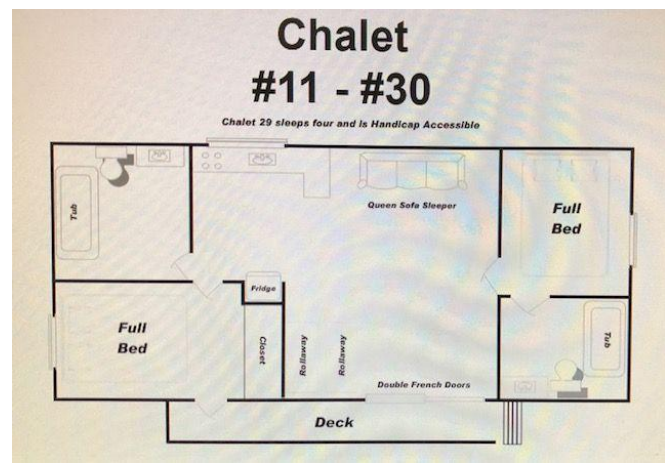

Mini Lodges with individual rooms to rent (14 rooms available)

Cost: \$162.00 & \$35 per extra family

Each has 4 bedrooms & 3 Bathrooms with 2 additional bunks in the upstairs and downstairs lobby areas, & sleeps up to 24 people...**No linens provided**

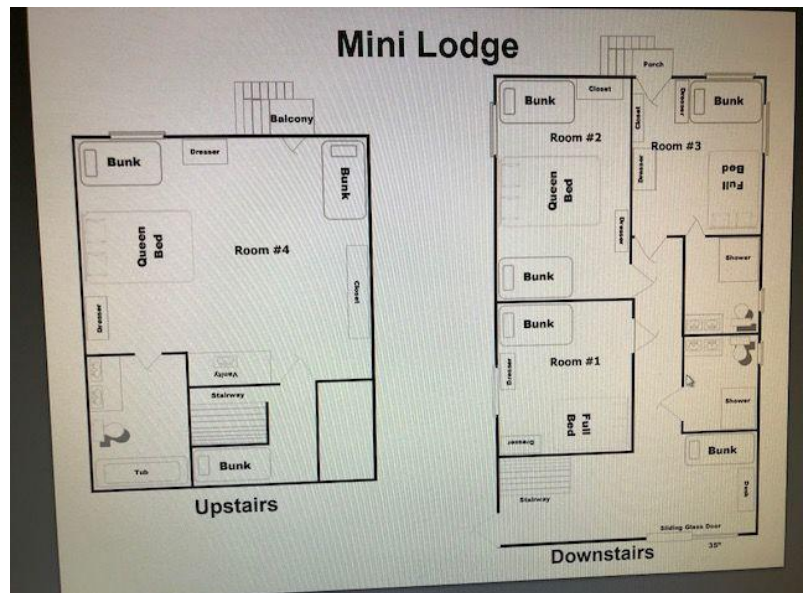

GUEST CABINS (3 available)

1 queen bed, private bathroom, mini-fridge, microwave and sleeps 3-4 people maximum... **Linens provided**

Cost: \$178 & \$35.00 extra family

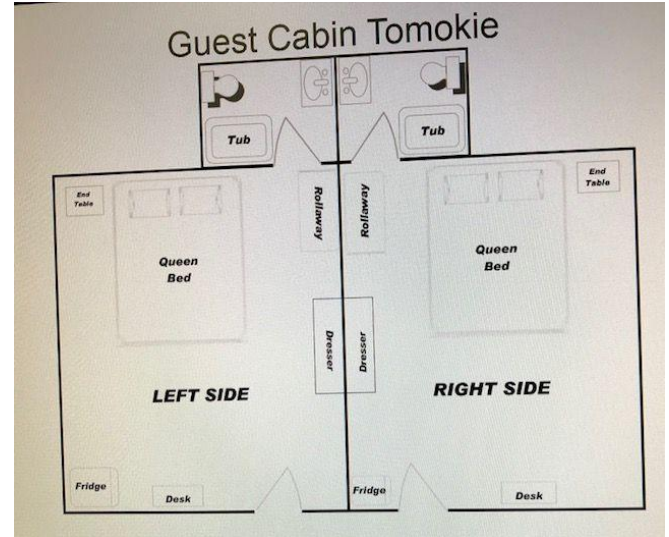

EFFICIENCY APARTMENT (1 available)

1 queen bed, 1 bunk bed, 2 sleeper sofas, private bathroom, refrigerator, stovetop (no oven), small dining room table and sleeps up to 8 people... **Linens provided**

Cost: \$195 & \$35.00 extra family

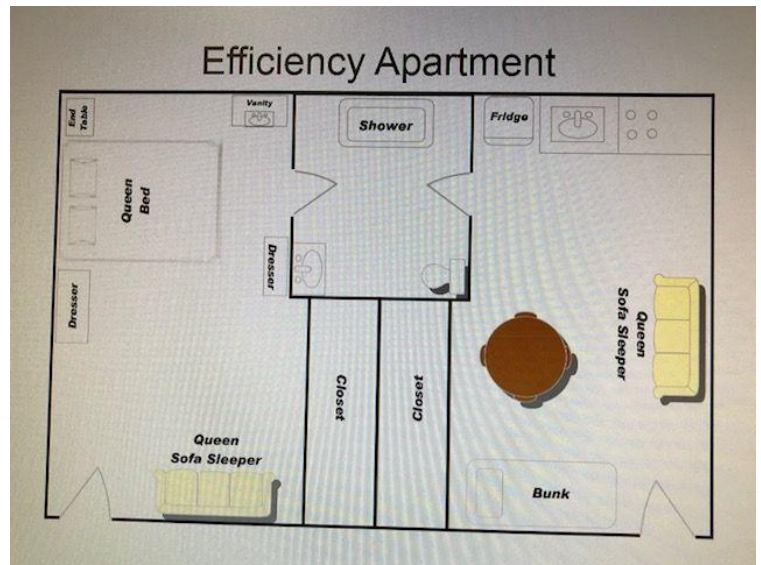

RUSTIC CABINS

Each cabin has 2 sides, a shared bathroom and sleeps up to 5 people per side 2 bunk beds and 1 single bed, air conditioning/heating and renovated wood flooring **No linens provided**

Cost: \$112 & \$35 each extra family



RV'S

Cost: \$88.50 + \$35 each extra family

TENTS

Cost: \$60 & \$35 per each extra family

Day Only

Cost: \$35.00 per family