

First Baptist Church Terrell

Main Campus: 403 N. Catherine St.
 ROC: 100 W. Brin St.
 fbcterrell.org 972.563.7561



- = Nursery/Preschool
- = Children/Preteens
- = Special Needs (JOY Min.)
- = Students (Teens) @ ROC
- = College/Career Adults up to mid-20's "Freedom" Class @ ROC
- = Young Adults: 20's -40's (Ad. 6)
- = Young Adults: 30's -50's (Ad. 5)
- = Median Adults: 40's-60's (Ad. 4) @ the ROC
- = Median Adults: 50's & 60's (Ad. 3) @ the ROC
- = Senior Adults: 60's & 70's (Ad. 2)
- = Senior Adults: 70's & up (Ad. 1)
- = "The Seekers" Class (ROC R106) Open to any age adult

FBCT Recreation Outreach Center (ROC) 2nd Floor

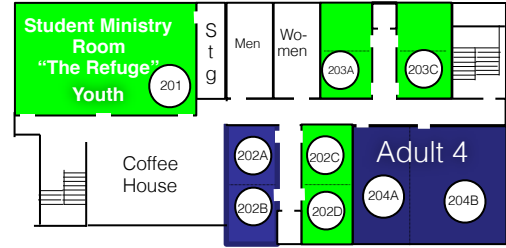

FBCT Recreation Outreach Center (ROC) 1st Floor

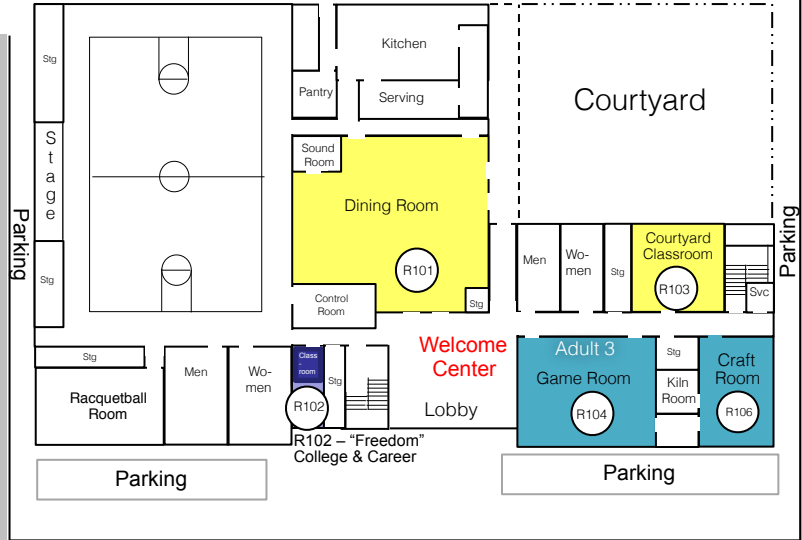

W. Brin Street

Main Campus 2nd Floor

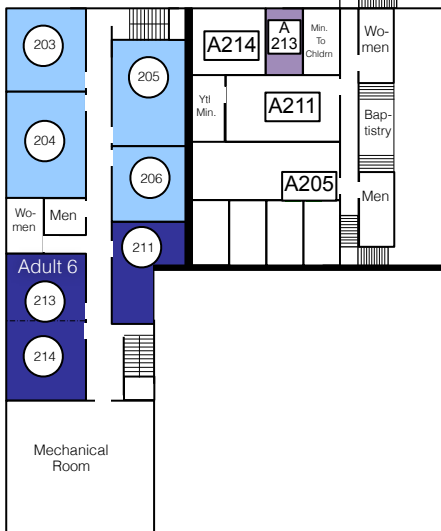

FBCT Main Campus 1st Floor

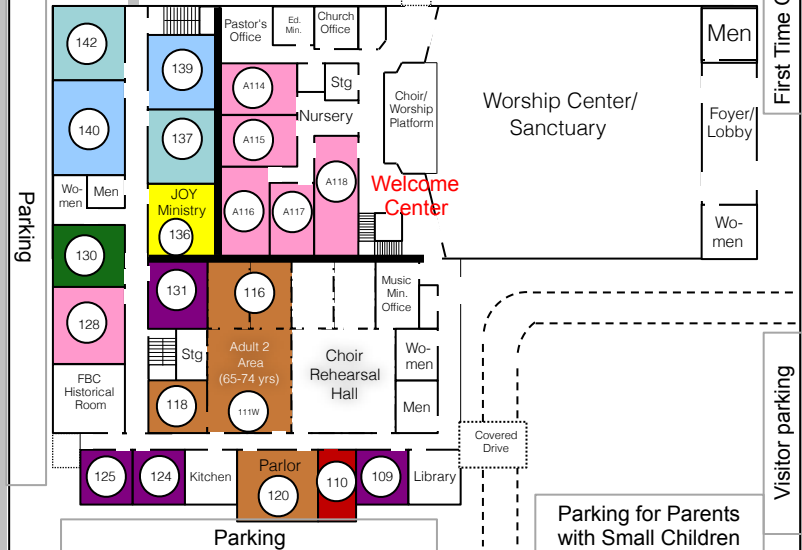

W. College St.

N · C A T H E R I N E S T

N · F R A N C E S S T

FBCT Sunday School Class /LIFE Group Location Guide

| <u>Dept</u> | <u>Age Group</u> | <u>Leaders</u> | <u>Campus</u> | <u>Room #</u> |
|------------------------------|-------------------------------|------------------------|---------------|---------------|
| Nursery | Bed Babies | Nursery Staff | Main Campus | A115 |
| | 9-17 Mos. | Nursery Staff | Main Campus | A114 |
| | 18-24 Mos. | Nursery Staff | Main Campus | A116 |
| | 2-Yr Olds | Ringer/Nursery Staff | Main Campus | A117 |
| | 3-Yr Olds | Nursery Staff | Main Campus | A118 |
| Children | 4-Yr Olds/Kindergarten | Messer/Wood/Martinez | Main Campus | 128 |
| | 1st & 2nd Grade | Williams/Frank/Clayton | Main Campus | 140 |
| | | | | |
| | 3rd Grade (Preteen Ministry) | Shiflet/Roseberry | Main Campus | 205 |
| | 4th Grade (Preteen Ministry) | Smith/Perry | Main Campus | 206 |
| | 5th Grade (Preteen Ministry) | Risingers | Main Campus | 203 |
| JOY Ministry | Special Needs | Johnson/Smith | Main Campus | 136 |
| Youth | | | | |
| | Junior High Girls | Lennon/Wilkerson/Black | ROC | 203 A-B |
| | Junior & High School Boys | Black/Hall/Lennon | ROC | 201 |
| | High School Girls | Hall/Hass | ROC | 202 C-D |
| | | | | |
| -Ad 18-24 | Freedom LIFE Group | Lowrie/Null | Main Campus | A213 |
| | | | | |
| Ad 20s-40's | Young Adult LIFE Group | Clayton | Main Campus | 213-214 |
| Adults 30's-50's | | | | |
| | Women - Sisters Class | G. Williams | Main Campus | A214 |
| Adults 40's-60's | Men - Murrell Jones Class | Heisel | ROC | R102 |
| | Women-Virginian Fineout Class | Brockway | ROC | R202 A-B |
| | CrossRoads LIFE Group | Seagroves | ROC | R204A |
| | CROSS Trainer's LIFE Group | H. Jones | ROC | R204B |
| Adults 50's & 60's | Women - Friendship Class | Porter | ROC | R103 |
| | Coed | Price | ROC | R104 |
| Adults 60's & 70's | Women - Agape Class | White | Main Campus | 116 |
| | Women - Lottie Moon Class | Risinger | Main Campus | 118 |
| | Men | Cowart | Main Campus | 120 |
| | Coed - Generations Class | Taylor | Main Campus | 111W |
| Adults 70's, 80's & up | Women - Faith Class | Gary | Main Campus | 131 |
| | Women - Naomi Class | J. Moore | Main Campus | 124 |
| | Women - Rebekah Class | Christenberry | Main Campus | 125 |
| | Men - Richard Hunter Class | M. Daniel | Main Campus | 109 |
| | Coed - Crusader Class | Perry | Main Campus | 110 |
| Any Age | "Seekers" LIFE Group | Folds | ROC | R106 |